

## SINGAPORE ACCIDENT STATEMENT

### IMPORTANT NOTICE

1. Please report correctly the details of the accident to speed up the claims process.
2. This Form must be completed by the Policyholder and/or the Authorised Driver.
3. Information provided must be as truthful and accurate as possible. Any wilful misrepresentation or withholding of material facts may allow insurance companies to repudiate policy ability.
4. The issue and acceptance of this Form by insurance companies is not an admission of policy liability on the part of the insurance companies.
5. **Any false reporting may be referred to the Police for investigation.**
6. This report will be forwarded by the insurers of the GIA Records Management Centre established by the General Insurance Association of Singapore (GIA) for archiving and that copies of this report will, for a fee, be made available upon application by interested parties.
7. By the lodgement of this report to the insurers, you hereby consent to the archiving of this report at the centre and to copies of the report being made available aforesaid.

### ACCIDENT STATEMENT

Date Of Report	06/02/2018 18:03
Date Of Accident	05/02/2018 22:50
Exact Location Of Accident	RIVER VALLEY RD ESSO PETROL KIOSK
Country/State of Loss	SINGAPORE

### DETAILS OF OWN VEHICLE

Vehicle Registration Number	SLR3420P
<b>Insured/Policyholder</b>	
Name Of Registered Owner	LCRF PTE LTD
Co Reg No	201624597K
Email Address	NOEMAIL
Mobile Phone No	
Alternative Phone No	Office-66944919

### Vehicle Particulars

Manufacturer	MITSUBISHI
Model	LANCER EX
Exact Purpose for which vehicle was being used at time of accident	HIRER
Are you claiming under your own insurance policy for repair to your vehicle?	NO
If No, Please state action to be taken	THIRD PARTY
Vehicle Category	PRIVATE CAR

### Insurance Company

Name of Insurance Company	AIG ASIA PACIFIC INSURANCE PTE. LTD.
Type Of Coverage	COMPREHENSIVE
Fleet Policy	YES
Policy Number	999995068
Cover Note Number	

### Driver

Name of Driver	PAY KOK HONG
NRIC No	S7715280F
Date Of Birth	06/06/1977
Occupation	OUTDOOR
Date Of Driving Pass	14/11/1995
Driving Experience	22 YEARS AND 2 MONTHS
Gender	MALE
Mobile Number	(LOCAL) +65-90106639
Fax Number	
Contact Number	
EMail Address	NOEMAIL

Address	44 BENOI RD BLOCK B
Postcode	
Was driver an employee of the Insured's Company	NO
If No, Relationship of the Driver with the Insured	OTHER - HIRER
Vehicle Registration Number of Driver's Own Vehicle	-
	-
	-
Insurance Company of Driver's Own Vehicle	-
	-
	-

#### General Information of the Accident

Type Of Accident	SIDE SWIPE
Weather Conditions	CLEAR
Road Surface	DRY

#### Other Information

Was any foreign vehicle involved in this accident?	NO
Number of vehicles involved in the accident	
Was any body injured in the Accident?	NO
Was any injured conveyed to hospital by ambulance?	NO
Was any other material or property damaged?	YES
I have been approached by unknown person(s) soliciting/offering accident claims assistance.	NO
Number of Passengers (Including Driver)	2
Passenger 1	Name: : UNKNOWN Gender: : Male

#### Details of Police Action

Was the accident reported to the police?	NO
If Yes, Please state which Police Station	
Was notice of intended Prosecution given?	NO
If Yes, against whom?	

#### Circumstances of Accident

PLEASE REFER TO PHOTOS ATTACHED, THANK YOU.

#### Attachment(s)

Are accident photos available for attachment?	YES
Was there any video captured by Car Camera?	YES
Was there any audio recorded?	NO

#### DETAILS OF OTHER VEHICLE PROPERTY 1

Vehicle Registration Number	SKC9633T
Vehicle Make/Model/Colour	
Details Of Properties	VEH. B
Vehicle Category	PRIVATE CAR
Name of Driver	KOH LIH PIN
NRIC/Passport Number	S7940884J
Contact Number	
Address	
Postcode	
Insurance Company Name	
Nature Of Damage	
No. Of Passenger (Including Driver)	

## Accident Sketch Plan

### SKETCH PLAN

#### IMPORTANT NOTICE

1. Please report correctly the details of the accident to speed up the claims process.
2. This Form must be completed by the Policyholder and/or the Authorised Driver.
3. Information provided must be as truthful and accurate as possible. Any wilful misrepresentation or withholding of material facts may allow insurance companies to repudiate policy liability.
4. The issue and acceptance of this Form by insurance companies is not an admission of policy liability on the part of the insurance companies.
5. Any false reporting may be referred to the Police for investigation.
6. The report will be forwarded by the insurers of the GIA Records Management Centre established by the General Insurance Association of Singapore (GIA) for archiving and that copies of this report will for a fee be made available upon application by interested parties.
7. By the lodgment of this report to the insurers, you hereby consent to the archiving of this report at the centre and to copies of the report being made available aforesaid.
8. Consent under the Personal Data Protection Act (PDPA)

I understand, acknowledge, agree and consent that:

- (a) My insurer, my workshop and the General Insurance Association of Singapore ("GIA") may/are permitted to collect, use, disclose and/or process my personal data/personal information set out in this [form] and any other personal information provided by me or possessed by my insurer (collectively the "Personal Information") and disclose and transfer such Personal Information to all insurer(s) who have insured vehicle(s) involved in this accident (all insurer(s) who have insured vehicle(s) involved in this accident shall be collectively referred to as the "Insurers"), the Insurers' lawyers/law firms, the Monetary Authority of Singapore and any relevant government agency/authority (such as the police), for the purpose(s) of:
  - (i) processing, handling and/or dealing with my claims including the settlement of the claims and any necessary investigations relating to the claims;
  - (ii) investigating the accident and/or my claims;
  - (iii) carrying out and/or dealing with my instructions or responding to any enquiries by me;
  - (iv) administering my claims (including the mailing of correspondence, statements, invoices, reports or notices to me, which could involve disclosure of certain personal data about me to bring about delivery of the same as well as on the external cover of envelopes/mail packages); and/or
  - (v) complying with applicable law in administering, processing, handling and/or dealing with my claims (collectively the "Purposes")
- (b) all insurer(s) who have insured vehicle(s) involved in this accident and the Insurers' lawyers/law firms, may/are permitted to collect, use, disclose and/or process my Personal Information for one or more of the above Purposes; and
- (c) my Personal Information may/can be disclosed by any of the Insurers and/or GIA to their third party service providers or agents (including their lawyers/law firms), which may be sited outside of Singapore, for one or more of the above Purposes.
- (d) my Personal Information will also be collected and used to compile claims history for the purpose of fraud detection, investigation and management in present and all future claims.
- (e) the information so collected under (d) above may be shared / disclosed:
  - (i) to all insurers and/or any other third parties that assist in evaluating, investigating, controlling or managing fraud, regulators, law enforcement and government agencies as reasonably required for the purposes stated, or
  - (ii) for complying with requirements under any regulations, laws or court orders.

Policyholder's Signature  
Date & Time:

Driver's Signature  
(If driver is not the policyholder)  
Date & Time: 06/02/2018.

Reporting Centre Person's Signature  
Name:  
NRIC/FIN No.:

SKETCH PLAN

River Valley Rd Esso

Ⓐ SLR3470 P

Ⓑ SKC9633 T

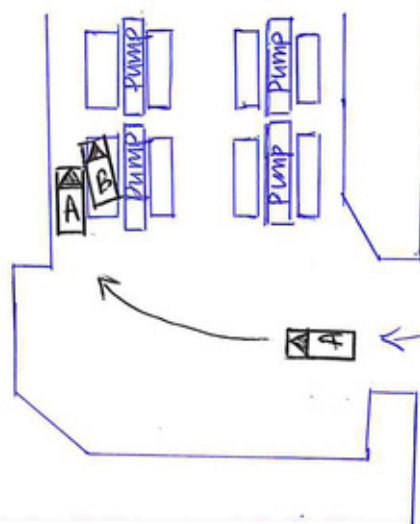

DESCRIBE CIRCUMSTANCES OF THE ACCIDENT

I was driving along River Valley Rd Esso Petrol kiosks, suddenly vehicle B in a stationary position turned out from his pump and hit my front right portion and caused to damaged. I have video footage captured in my in car camera.

DECLARATION

I/We declare the foregoing particulars are true in every respect.

Policyholder's Signature  
Date & Time:

Driver's Signature  
(If driver is not the policyholder)  
Date & Time: 06/02/2018.

Reporting Centre Personnel's Signature  
Name:  
NRIC/FIN No.:

IDENTIFICATION CARD & DRIVING LICENCE.

REPUBLIC OF SINGAPORE DRIVING LICENCE

Licence Number: S7715280F

Name: PAY KOK HONG (BAI GUOFENG)

Birth Date: 06 Jun 1977

Issue Date: 11 Nov 2003

000951015H

VMG USE ONLY

REPUBLIC OF SINGAPORE

IDENTITY CARD NO. S7715280F

Name: PAY KOK HONG

白 国 峰

Race: CHINESE

Date of birth: 06-06-1977

Sex: M

Country of birth: SINGAPORE

4139187

VMG USE ONLY

YOU ARE LICENSED TO DRIVE VEHICLES IN THE FOLLOWING CLASS(S)

Class 3 Motor Cars and Motor Tractors the weight of which unladen does not exceed 2500 kilograms

PASS DATE: 14 Nov 1995

NP 42BA

Licence No: S7715280F

VMG USE ONLY

4139187

WVIC No: S7715280F

Date of issue: 30-11-2007

Address: APT BLK 509A WELLINGTON CIRCLE #03-101 SINGAPORE 751509

VMG USE ONLY

Accident Photo





Accident Photo

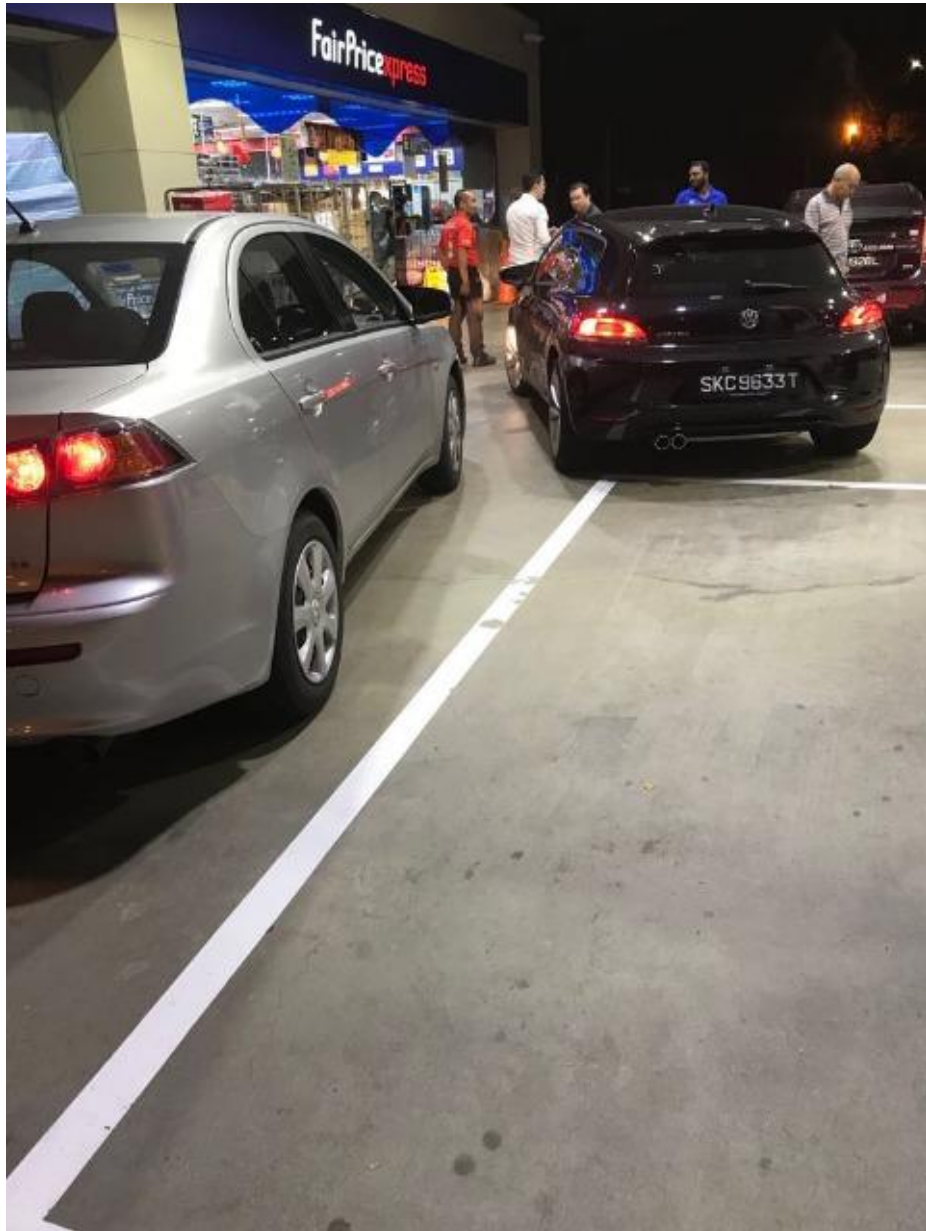

Accident Photo





Accident Photo



Accident Photo



Accident Photo





Accident Photo



Accident Photo





Accident Photo

