

22/03/2003

ASS. REC. BY:

REF:

623 / FC118002227 / W d352

Special Instructions

mv

Surveyor:

ASSIGNMENT (Office)

(WS

From (Person): May chua

of

FCI

Date/Time: 2/2/18 @ 5.21pm

Estimated Cost:

Bill to:

OD / TP / WS / TP RES / OD RES / EVA / INV / MV / CS

To Inspect Vehicle No:

SLL 6650D

Insured:

SHC 3460A

at Workshop m/s

United SG Automobile

Tel:

9007756

of

53 Ubi Ave 1 # 01-56

Policy No:

Claim No:

D18 000999 MFS H

Sum Insured:

Excess:

Make of Veh:

D.O.A. 31/01/2018

(Client's Record)

6/2/18 @ afternoon

CA / REV / REP. / REV 24 HRS

'w/o'

H.O.D. Endorsement:

Date/Time:

11.56am 05/2/18

Person Contacted:

Sean

Vehicle IN (OUT)

Date/Time

Action/Instruction (X) Estimate

SLL 6650D - X

SHC 3460A-NA / INC17000331 / K4

D.O.A.: 31/1/17

Dismantle: 8/2/2018

After repair: 20/2/2018

First Capital Insurance Limited

A FAIRFAX Company

Company Reg. No. 195000106C
GST Reg. No. M2-0001676-9

MOTOR SURVEY ASSIGNMENT

Date	01-02-2018	Our Ref No. D18000999MFSH
Accident Date	31-01-2018	Claim Type. Third Party
Insured Vehicle	SHC3460A	Third Party Vehicle. SLL6650D
Survey Location	53 Ubi Ave 1 #01-56 Paya Ubi Industrial Park	
Contact Person.	SEAN LIAN	
Contact No.	67474454/ 90077556	Fax No. 67477752
Survey Type	WITHOUT PREJUDICE:	
Appointed Surveyor	LKK AUTO CONSULTANTS PTE LTD	
Contact Person	NA	Fax No. 68416315
Contact Number.	NA	

FOR DIRECT SETTLEMENT

Please submit to us the Tax Invoice together with letter of claim for Rental OR Loss of use (based on NIMA Benchmark rates) together with your survey report.

THIRD PARTY SURVEY REQUEST

Cc : Workshop	UNITED SG AUTOMOBILE PTE LTD	Attention. NIL
Cc : TP Solicitor	CHIA S ARUL LLC	TP Solicitor Fax No. NA
Officer Incharge	MAY CHUA	

IMPORTANT NOTE

Kindly submit the survey report via CWS within 14 days for survey assignment and 7 days for re-inspection.
This is a computer generated letter, no signature required.

Job Sheet (/ClaimWS/Surveyor/JobSheet/234587)



PRI Documents



Close



PRI Header Details

Claim No	D18000999MFSH	Policy No	D-18088936MFSH	Claimant S.No & Name	1 & M/S CHIA
Workshop Name	UNITED SG AUTOMOBILE PTE LTD (Contact Person : SEAN LIAN)	Survey Location & Contact Details	53 Ubi Ave 1 #01-56 Paya Ubi Industrial Park Mobile: 90077556 , Phone: 67474454 , Fax: 6747775; EmailId: JERONE@CHIAARUL.COM		
Our Surveyor	LKK AUTO CONSULTANTS PTE LTD	Instructions To Surveyor	WITHOUT PREJUDICE:		
Insured Name	COMFORT TRANSPORTATION PTE LTD	Insured Vehicle No	SHC3460A	TP Vehicle No	SLL6650D
PRI Recieved Date	01-02-2018 10:17:24 PM	Surveyor Appointed Date	02-02-2018 05:20:04 PM	Surveyor Accept Date	05-02-2018 0

Survey Report Upload

Surveyor Inspection Date *:		Surveyor Report Date	05-02-2018	Upload Survey Report *:	<input type="button" value="Choose File"/>
------------------------------------	--	-----------------------------	------------	--------------------------------	--------------------------------------------

Vehicle Particulars

Make	Please Select Make ▼	Model	Please Select Model ▼	Year	Select Year ▼
Chasis No	<input type="text"/>	Engine No	<input type="text"/>	Mileage	<input type="text"/>
Color	<input type="text"/>	Cubic Capacity	<input type="text"/>		

Multiple Documents Upload

File Name	Action
-----------	--------

Surveyor Job Remarks

Remarks	<input type="text"/>	<input type="button" value="Save"/>
----------------	----------------------	-------------------------------------

SINGAPORE ACCIDENT STATEMENT

IMPORTANT NOTICE

1. Please report correctly the details of the accident to speed up the claims process.
2. This Form must be completed by the Policyholder and/or the Authorised Driver.
3. Information provided must be as truthful and accurate as possible. Any wilful misrepresentation or withholding of material facts may allow insurance companies to repudiate policy ability.
4. The issue and acceptance of this Form by insurance companies is not an admission of policy liability on the part of the insurance companies.
5. Any false reporting may be referred to the Police for investigation.
6. This report will be forwarded by the insurers of the GIA Records Management Centre established by the General Insurance Association of Singapore (GIA) for archiving and that copies of this report will, for a fee, be made available upon application by interested parties.
7. By the lodgement of this report to the insurers, you hereby consent to the archiving of this report at the centre and to copies of the report being made available aforesaid.

ACCIDENT STATEMENT

Date Of Report	31/01/2018 14:16
Date Of Accident	31/01/2018 00:25
Exact Location Of Accident	ALONG TOWARD SIN LIM
Country/State of Loss	SINGAPORE

DETAILS OF OWN VEHICLE

Vehicle Registration Number	SLL6650D
Insured/Policyholder	
Name Of Registered Owner	CHIA SHU JING FRANCESCA
NRIC No	S9029812G
Email Address	NOEMAIL
Mobile Phone No	(LOCAL) +65-88183210
Alternative Phone No	OFFICE-88183210

Vehicle Particulars

Manufacturer	MERCEDES-BENZ
Model	E 300
Exact Purpose for which vehicle was being used at time of accident	PRIVATE
Are you claiming under your own insurance policy for repair to your vehicle?	NO
If No, Please state action to be taken	REPORTING ONLY
Vehicle Category	PRIVATE CAR

Insurance Company

Name of Insurance Company	AVIVA LTD
Type Of Coverage	COMPREHENSIVE
Fleet Policy	NO
Policy Number	10729424
Cover Note Number	

Driver

Name of Driver	GAO LIFENG EDWARD SILAS
NRIC No	S8830055F
Date Of Birth	15/08/1988
Occupation	INDOOR
Date Of Driving Pass	02/03/2011
Driving Experience	6 YEARS AND 10 MONTHS
Gender	MALE
Mobile Number	(LOCAL) +65-88183210
Fax Number	
Contact Number	
Email Address	G_EDWARD@HOTMAIL.SG

Address	BLK 315B PUNGGOL WAY #05-879 SINGAPORE 822315
Postcode	
Was driver an employee of the Insured's Company	NO
If No, Relationship of the Driver with the Insured	SPOUSE
Vehicle Registration Number of Driver's Own Vehicle	-
	-
	-
Insurance Company of Driver's Own Vehicle	-
	-
	-

General Information of the Accident

Type Of Accident	SIDE SWIPE
Weather Conditions	CLEAR
Road Surface	DRY

Other Information

Was any foreign vehicle involved in this accident?	NO
Number of vehicles involved in the accident	
Was any body injured in the Accident?	NO
Was any injured conveyed to hospital by ambulance?	NO
Was any other material or property damaged?	YES
I have been approached by unknown person(s) soliciting/offering accident claims assistance.	NO
Number of Passengers (Including Driver)	1

Details of Police Action

Was the accident reported to the police?	NO
If Yes, Please state which Police Station	
Was notice of intended Prosecution given?	NO
If Yes, against whom?	

Circumstances of Accident

I driver of SLL6650D was driving along Jalan Besar on the 1st lane, suddenly the other party SHC3460A was from the 2nd lane cut onto my lane without signal and scratch onto my front left side and front left rim.

Attachment(s)

Are accident photos available for attachment?	YES
Was there any video captured by Car Camera?	YES
Remarks/ Reasons:	PENDING VIDEO FROM INSURED
Was there any audio recorded?	NO

DETAILS OF OTHER VEHICLE PROPERTY 1

Vehicle Registration Number	SHC3460A
Vehicle Make/Model/Colour	HYUNDAI/SONATA NF 2.0/BLUE
Details Of Properties	
Vehicle Category	PRIVATE CAR
Name of Driver	TAN SOO PENG
NRIC/Passport Number	S0153384C
Contact Number	86826878
Address	
Postcode	
Insurance Company Name	
Nature Of Damage	
No. Of Passenger (Including Driver)	1

Sketch Plan

SKETCH PLAN

IMPORTANT NOTICE

1. Please report correctly the details of the accident to speed up the claims process.
2. This Form must be completed by the Policyholder and/or the Authorised Driver.
3. Information provided must be as truthful and accurate as possible. Any wilful misrepresentation or withholding of material facts may allow insurance companies to repudiate policy liability.
4. The issue and acceptance of this form by insurance companies is not an admission of policy liability on the part of insurance companies.
5. Any false reporting may be referred to the Police for investigation.
6. The report will be forwarded by the Insurers of the GIA Records Management Centre established by the General Insurance Association of Singapore (GIA) for archiving and that copies of this report will for a fee be made available upon application by interested parties.
7. By the lodgement of this report to the Insurers, you hereby consent to the archiving of this report at the centre and to copies of the report being made available aforesaid.
8. Consent under the Personal Data Protection Act (PDPA)
 - (a) I understand, acknowledge, agree and consent that:
 - (i) My insurer, my workshop and the General Insurance Association of Singapore ("GIA") may be permitted to collect, use, disclose and/or process my personal data/personal information set out in this form and any other personal information provided by me or possessed by my insurer (collectively the "Personal Information") and disclose and transfer such Personal Information to all insurers who have insured vehicle(s) involved in this accident (all insurers) who have insured vehicle(s) involved in this accident shall be collectively referred to as the "Insurers"; the Insurers' lawyers/law firms, the Monetary Authority of Singapore and any relevant government agency/authority (such as the police), for the purpose(s) of:
 - (i) processing, handling and/or dealing with my claims including the settlement of the claims and any necessary investigations relating to the claims;
 - (ii) investigating the accident and/or my claims;
 - (iii) carrying out and/or dealing with my instructions or responding to any enquiries by me;
 - (iv) administering my claims (including the mailing of correspondence, statements, invoices, reports or notices to me, which could involve disclosure of certain personal data about me to bring about delivery of the same as well as on the external cover of envelopes/mail packages); and/or
 - (v) complying with applicable law in administering, processing, handling and/or dealing with my claims.
 - (b) all insurers who have insured vehicle(s) involved in this accident and the Insurers' lawyers/law firms, may be permitted to collect, use, disclose and/or process my Personal Information for one or more of the above Purposes; and
 - (c) my Personal Information may be disclosed by any of the Insurers and/or GIA to their third party service providers or agents (including their lawyers/law firms), which may be sited outside of Singapore, for one or more of the above Purposes.

VERIFIED BY AJAX MARS
REPORTING OFFICER
MUHAMMAD SUMARDI BIN
MOHD AFFANDI

Policyholder's Signature / Date & Time

Driver's Signature (if driver is not the Policyholder) / Date & Time

Witnessed by Reporting Centre
Personnel

Sketch Plan

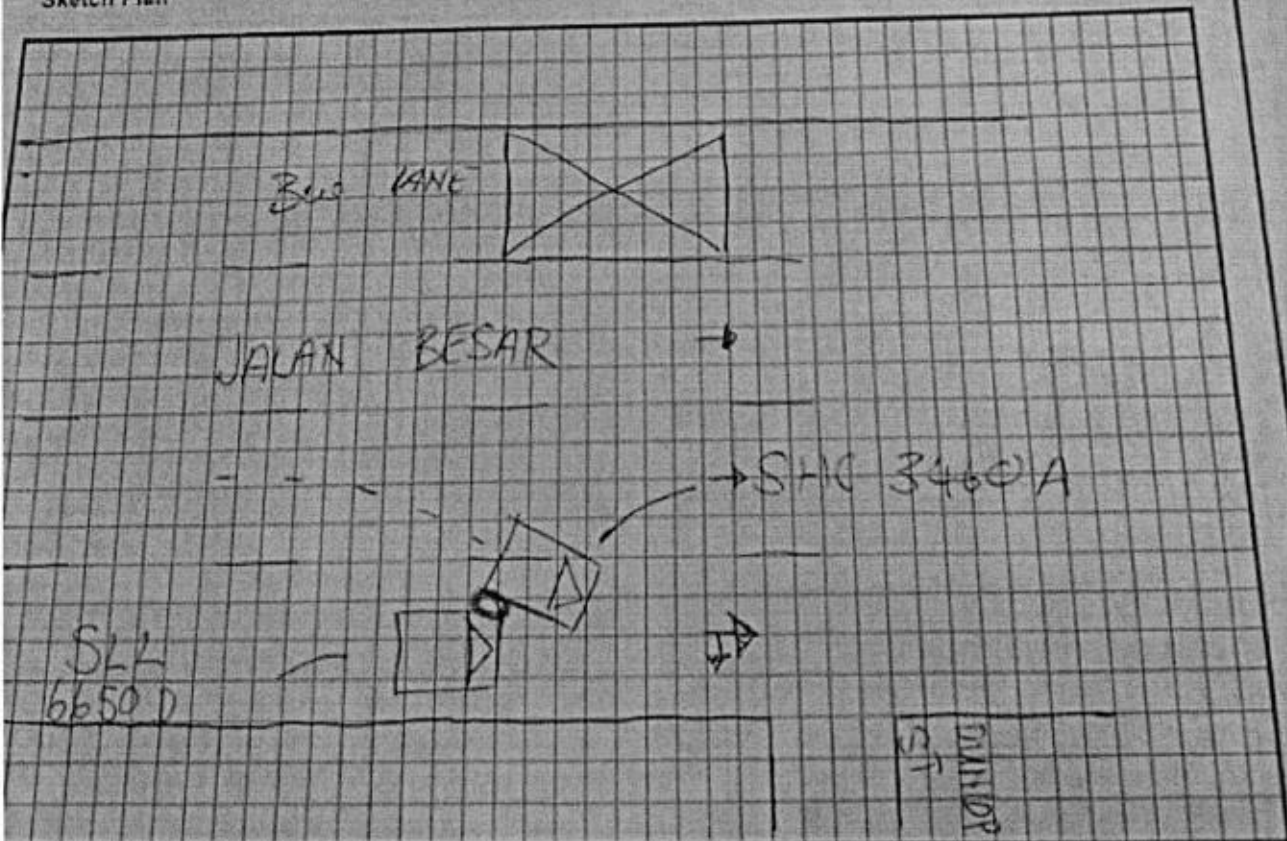

ACCIDENT STATEMENT (2000 characters)

I driver of SLL6650D was driving along Jalan Besar on the 1st lane, suddenly the other party SHC3460A was from the 2nd lane cut onto my lane without signal and scratch onto my front left side and front left rim.

Taxi Voucher No.:

DECLARATION

I/We declare that the above particulars & information provided above are true in every aspect

VERIFIED BY AJAX MARS REPORTING OFFICER -
MUHAMMAD SUMARDI BIN MOHD AFFANDI

MARS Officer

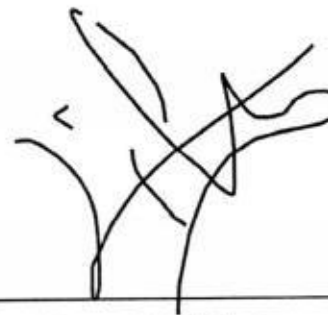

Registered Owner or Driver's Signature

Job Complete Date/Time

31 January 2018 1:48 pm

Date/Time:

31 January 2018 1:48 pm

D.O.A → 31/1/2018

Enquire PARF/COE Rebate for Registered Vehicle

Vehicle Owner Particulars	
Owner ID Type:	Singapore NRIC
Owner ID:	9812G
Vehicle Details	
Vehicle No.:	SLL6650D 30 21 19 20 01 2020
Vehicle to be Exported:	No - 31 01 2018
Intended De-registration Date:	09 Apr 2018 19 10 1
Vehicle Make:	MERCEDES BENZ (0.6 10.6 22.6 March)
Vehicle Model:	E 300
Primary Colour:	Brown
Manufacturing Year:	2009 Bal → 140 10.6 March
Engine No.:	27295231394781 22.6 March
Chassis No.:	WDD2120542A131513
Maximum Power Output:	170.0 kW (227 bhp)
Open Market Value:	\$56,070.00 Average Depreciation
Original Registration Date:	22 Jan 2010 → \$17023 / yr
First Registration Date:	22 Jan 2010 \$1418 / March
Transfer Count:	1
Actual ARF Paid:	\$56,070.00 22.6 March x \$1418 / month
Intended PARF Rebate Details	
PARF Eligibility:	Yes = \$32 046 + \$15 419
PARF Eligibility Expiry Date:	21 Jan 2020 * → \$47 465
PARF Rebate Amount:	\$30,838.00 x 50% = \$15419
Intended COE Rebate Details	
COE Expiry Date:	21 Jan 2020
COE Category:	B - Car (1601cc & above)
COE Period(Years):	10
QP Paid:	\$19,801.00
COE Rebate Amount:	\$3,529.00
Total Rebate Amount:	\$34,367.00

The information contained herein is correct as at 09 Apr 2018

OK

M.V → \$47 465



SELL YOUR CAR BY BIDDING
HIGHEST SELLING PRICE GUARANTEED!
OR GET \$100 CASH!



Post an Advertisement
 Sell it yourself! Advertise it at just
\$58 until it's SOLD!

Post an Ad

Advertiser Login

Ways of Selling

Sporty And Stylish Peugeot RCZ Turbo Coupe.



Limited Edition (M) With 1.6
 Turbo Output Of 200BHP Nicely
 Done Up And Maintain.
 Direct Owner StarAd

Free VICOM evaluation
 Free grooming and 6 months maintenance
 In-house workshop ensures quality service
 Member of SVTA and hire purchase association
 100% deposit refund for unapproved loan

YONG LEE SENG MOTOR PTE LTD

Browse by Category

Sort by Date Posted

40 results/page

9 vehicles

mercedes benz e300

Advanced Search

Submit

	Make	Model	Price	Depreciation	Reg Date	Eng Cap	Mileage	Veh Type	Status
Search Selection	mercedes benz e300		Any	Any	2010	Any	Any	Any	Available



Mercedes-Benz E-Class E300

\$60,000

\$17,890 /yr

22-Jan-2010

2,996 cc

105,000 km

Luxury

Available

A Powerful Luxurious Sedan, Providing A Comfort Feel. Always Parked Under Shelter. Call Our Friendly Sales For Viewing And Test Drive Now!

Posted: 08-Mar-2018 Tags: 2010 Mercedes-Benz E300, Mercedes-Benz E300, Mercedes-Benz, E300, Used Mercedes-Benz

Mercedes-Benz E-Class E300
Avantgarde

\$58,800

\$17,120 /yr

26-Jan-2010

2,996 cc

110,000 km

Luxury

Available

Cycle & Carriage Unit. STA And VICOM Evaluation Welcome. Vehicle In Showroom Condition By Professional Groomer. Elegant Brown With Tan Brown Leather Interior. Lowest Interest Rate. Lowest Monthly Inst...

Shuang Hup Credit

Posted: 08-Apr-2018 Tags: 2010 Mercedes-Benz E300, Mercedes-Benz E300, Mercedes-Benz, E300, Used Mercedes-Benz



Mercedes-Benz E-Class E300

\$59,800

\$16,060 /yr

01-Feb-2010

2,996 cc

89,000 km

Luxury

Available

1 Owner \$6k Drive Away!, Fully Serviced And Well Maintained No Repair Required. Tip Top Classic Black On Black Combination. Immaculate Condition, Always Parked Under Shelter. Well Taken Care Of By Pre...

Posted: 06-Apr-2018 Tags: 2010 Mercedes-Benz E300, Mercedes-Benz E300, Mercedes-Benz, E300, Used Mercedes-Benz



Mercedes-Benz E-Class E300

\$58,800

\$17,290 /yr

10-Feb-2010

2,996 cc

140,000 km

Luxury

Available

Excellent Condition. First Class Commuting Experience, Unparalleled Status And Comfort. Often Compared, Always Unrivaled. Limited Unit Only! Please Call For Viewing Appointment!

Benefit Auto Enterprise Pte Ltd

Posted: 05-Apr-2018 Tags: 2010 Mercedes-Benz E300, Mercedes-Benz E300, Mercedes-Benz, E300, Used Mercedes-Benz

Car Buying

Car Selling

Car Ownership

Car Aftermarket

On The Move

Lifestyle



Mercedes-Benz E-Class E300

\$66,000

\$16,380 /yr

12-Jul-2010

2,996 cc

-

Luxury

Available

One Of A Kind. E300 Distinguished 3 Pointed Star. A Mark Of Success. Charming Black. Owner Meticulously Took Care Of This Black Stallion. Test Drive It 2 Believe. Director's 2nd Car. For Business Usag...

Posted: 27-Mar-2018 Tags: 2010 Mercedes-Benz E300, Mercedes-Benz E300, Mercedes-Benz, E300, Used Mercedes-Benz



Mercedes-Benz E-Class E300

\$65,000

\$15,290 /yr

16-Aug-2010

2,996 cc

63,000 km

Luxury

Available

No Dealers/Agents Please. Agent Car, Bought From Republic Auto. Can Show Record. Diligently Serviced/Maintained, Full Service Record. Lowest Genuine Mileage Car In The Market. Immaculate Condition, Al...

Posted: 08-Apr-2018 Tags: 2010 Mercedes-Benz E300, Mercedes-Benz E300, Mercedes-Benz, E300, Used Mercedes-Benz



Mercedes-Benz E-Class E300

\$69,000

\$17,100 /yr

23-Aug-2010

2,996 cc

-

Luxury

Available

In House Loan Available! Offer Loan Interest 1.18% Only! Free Warranty! Down Payment \$7000! 1 Owner C&C Unit. Free 1 Year Extended Premium Warranty. Carefully Taken Care Of By 1 Owner! New Battery. In...

Don Motoring

Posted: 07-Apr-2018 Tags: 2010 Mercedes-Benz E300, Mercedes-Benz E300, Mercedes-Benz, E300, Used Mercedes-Benz



Mercedes-Benz E-Class E300

\$66,500

\$15,510 /yr

22-Sep-2010

2,996 cc

-

Luxury

Available

CNY Promo, Only 1.98% Interest! No Advance Instalment! Down Payment \$6,950, Monthly At \$1,500. Well Maintained. Cheapest In Town! Peace Of Mind! Lowest Depreciation! Low Mileage, Accident Free! High ...

Privilege Motors Pte Ltd

Accident Photo





Chassis Measurement Chart

SLL 6650 D
wheel Alignment
Report (Before
Repair)

Subsidiary/Branch-Company no.

Customer:

C&Y AUTO PTE LTD

United SG

53 UBI AVE 1 #01-28 PAYA UBI INDUSTRIAL PARK

S'PORE 408934

Vehicle ident. no.

Repair order no.

Measurement made: Name

Date:

KEN WEI

02/08/2018

Reg. N.:

First registration:

Type

Mileage: Km/miles

SLL 6650 D

MERCEDES BENZ S212 E 2009 - 2016 (26040)

km

Complaint or reason for measurement

Tyres: make

Description

Mileage: Km/miles

		front LH	front RH	rear LH	rear RH
Pressure measured (cold) bar/psi/kPa		2.4	2.4	2.4	2.4
	external				
Tread depth (mm)	centre				
	internal				
		Before correction		After correction	
Vehicle level					
REAR AXLE	Camber +/- (°)	LH	-01.52°	-01.04° / +00.50° -00.50°	-01.52°
		RH	-01.87° *	-01.04° / +00.50° -00.50°	-01.87° *
	total		-00.08° *	+00.36° / +00.12° -00.12°	-00.08° *
	Toe +/- (°)	LH	+00.23°	+00.18° / +00.06° -00.06°	+00.23°
		RH	-00.31° *	+00.18° / +00.06° -00.06°	-00.31° *
	Thrust angle		+00.27° *	+00.00° / +00.25° -00.25°	+00.27° *
FRONT AXLE	Camber +/- (°)	LH	-01.46° *	-00.39° / +00.36° -00.36°	-01.46° *
		RH	-00.43°	-00.39° / +00.36° -00.36°	-00.44°
	Caster (°)	LH		+06.74° / +00.50° -00.50°	
		RH		+06.74° / +00.50° -00.50°	
Lh steering lock lh wheel 20°					
Rh steering lock rh wheel 20°					
Set Back			-00.36°		-00.36°
Toe +/- (°)	total		-02.15° *	+00.16° / +00.17° -00.17°	-02.15° *
	LH		-01.55° *	+00.08° / +00.09° -00.09°	-01.55° *
	RH		-00.60° *	+00.08° / +00.09° -00.09°	-00.60° *
Maximum steering angle on wheel side on inside of bend (°)		LH			
		RH			

**LKK Auto Consultants Pte Ltd**

51 Ubi Ave 1 #01-25 Paya Ubi Industrial Park, Singapore 408933

TEL: 6256 3561 FAX: 6256 4315

Reg. No: 199607198R GST Reg. No. 19-9607198-R

Page No.: 1 of 1

PRE-REPAIR INSPECTION REPORT

FIRST CAPITAL INSURANCE LTD

Ref: CS3/FCI18002227/Wd3s2

36 ROBINSON ROAD

Date: 25-04-2018

#16-01 CITY HOUSESINGAPORE 068877



Code: FCI2

1. Policy Particulars :- (THIRD PARTY CLAIM)

Insured Veh.	SHC 3460A	Veh. Inspected	SLL 6650D
Policy No.	D-18088936MFSH	Coverage (\$)	0.00
Claim No.	D18000999MFSH	Excess (\$)	0.00
Assign From	MAY CHUA	Assign Date	02/02/2018

2. Vehicle Particulars & Condition

Make & Model	MERCEDES BENZ E 300	c.c	2996
Engine No.	HIDDEN	Year of Reg.	2010
Chassis No.	WDD2120542A131513	Colour	RED
Odometer	103470 KM	Steering	IN ORDER
Brakes	IN ORDER	Modification	SPORTS RIM
General	GOOD		

3. Conditions of Tyres

	Size	Make	Balance
R/H Front Tyre	245/45ZR17	MICHELIN	2 mm
L/H Front Tyre	245/45ZR17	MICHELIN	2 mm
R/H Rear Tyre	245/45ZR17	DUNLOP	2 mm
L/H Rear Tyre	245/45ZR17	DUNLOP	2 mm

4. Description of Damages

THE VEHICLE SUSTAINED DAMAGES AT THE N/S FRONT PORTION.

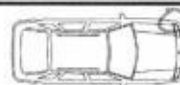
**5. General Information**

Accident Date	31/01/2018	Inspect Date / Time	07/02/2018 (06:27 AM)
Survey held at	UNITED SG AUTOMOBILE 53 UBI AVE1 #01-56 PAYA UBI INDUSTRIAL PARK SINGAPORE 408934		

5a. Remarks

- A) THE INSPECTION WAS CONDUCTED ON A "WITHOUT PREJUDICE" BASIS.
 B) THE REPAIR ESTIMATE WAS NOT PRESENTED AT THE TIME OF INSPECTION.
 THE REPAIRER WAS TOLD TO PREPARE THE ESTIMATE.
 C) ENCLOSED PLEASE FIND DAMAGED VEHICLE PHOTOGRAPHS.
 D) MARKET VALUE:\$55,000.00

Report Ref No. CS3/FCI18002227/Wd3s2

Inspected By

WILSON TEO CHENG MING

Automotive Assessor

K.K.LAU CPT(RET)

BEng(Hons), B.Bus, MBA, PEng, PE, MinstAEA, MASME, MIRTE

REGD Auto Consultant-SAE, Licensed Appraiser

DISCLAIMER OF LIABILITY TO THIRD PARTIES:- This Report is made solely for the use and benefit of the Client named on the front page of this Report.

No liability of responsibility whatsoever, in contract or tort, is accepted to any third party who may rely on the Report wholly or in part. Any third party acting or relying on this Report, in whole or in part, does so at his or her own risk.