

22/05/2002

ASS. REC. BY:

REF: CS/MSG18000564/ Ktd321

Special Instruction:

SIC: 100
Menmen

Kenneth

ASSIGNMENT (Office)

From (Person):

Irene Tan

of

MSG

Date/Time:

09/01/18 @ 3.49pm

Estimated Cost:

Bill to:

OD ☒ TP / WS / TP RES / OD RES / EVA / INV / MV / CS

To Inspect Vehicle No:

EC60 B

Insured:

WC 3082 E

at Workshop m/s

MBM Wheelpower

Tel:

9328 8668

of

160 Sin Ming Drive #06-02

8660 5178

Policy No:

28744780 MKC

Claim No:

Sum Insured:

Excess:

Make of Veh:

(Client's Record)

D.O.A.

06/01/2018

CA / REV / REP. / REV 24 HRS

'up'

10/01/2018

H.O.D. Endorsement:

Date/Time:

5.26pm @ 9/1/18

Person Contacted:

Danny

Vehicle ☒ IN ☐ OUT

Date/Time

Action/Instruction (✓) Estimate

EC60B - NI/MSG18000564/13

D.O.A. 06/01/2018

WC3082E - CS/MSG150143/16993K3

D.O.A. 06/06/2015

18/1 -

Report via menmen

88068.25

refinalized \$8368.25 (Red: 6996.75; 45%)

REF: MSIG

ASSIGNMENT

From: Date: 11/01/2018

Estimated Cost:

OD ☒ TP / WS / TP RES / OD RES / EVA / INV / MV

To inspect Vehicle No: EC 60 B

at Workshop of: MBM Wheelpower

of: 160 Sin Ming Drive #06-02

Insured:

Policy No:

Claims No:

Sum Insured:

Excess:

(Client's Record)

Make of Veh:

(Policy Condition)

Remark: The veh had commenced its repair at the time of inspection.

N/S	O/S

Bal. or Market Value:

DAO Accident Report: Consistent? : Yes or No

GIA / PR Seen: Consistent? : Yes or No

Est. Repairs: 05 days Res: Yes or No

Lum Sum: 1.21 % 3 Val: Yes or No

CA / REV / REP. / 24 HRS 'up

Date: Person Contacted:

Vehicle: IN / OUT

Veh No: EC 60 B Page: 06 15

Type: M/Car / M/Cycle / Bus / Van / Lorry / Taxi / Prime Mover /

Truck / Trailer or

Make: Toy Vell fire

Colour: M. Black

So. Reading: 53544

Eng No:

C No: AGH30

Gen. Cond: Good / Fair / Poor / Burnt

Steering: Inorder / Jammed / Leaked / Burnt or

Brake: Inorder / Jammed / Leaked / Burnt or

Mod: Nil / S/Rim / STD / Rim or

Tyre Size: F:

R:

BS / DUN / EXNOVA / GY / FS / LIZA / MIC / OHTSU / PIR / SUMI /

TOYO / YOKO or

Front:

R. Bal:

L. Bal:

D.O.A.

Rear:

R. Bal:

L. Bal:

D.O.A.

Survey held at:

Des. of Damages: Fnt / Rear / O/S / N/S / U/C / Rooftop or

17 d's & u/c

The U/C / Chassis frame / Body Structure affected due to collision

Date / Time Action / Instruction

12/1 file pass to Cathryn

RECEIVED 15 MAY 2018

Date/Time File Pass to:



Preli. Report

Final Report

Date/Time File Return to:

Days Of Repair: 5

Resurvey No. of Trip: 1

Survey Fee

Transaction

LTD + PR + S

Printed

Date

TOTAL

Add Fee:



Site Insp: S

Inspection: S

Tech: S

Vehicle: S

Report Format:

Lum Sum (L.B. + S)

TP
8368.25

300

10

310

...CLAIM SUBFOLDER...(New Assignment)

CLAIM SUBFOLDER TRACKING

Case	Assigned	Assigned
Main	09 Jan 2018	09 Jan 2018 15:49 Assign

New Assignment
Cancel Case

Main	Reference	Claim Details	Documents	Show All
CLAIM SUBFOLDER DETAILS				
<div> <div>Insured:</div> <div>SAMWOH READY MIX PTE LTD, Co. Reg. No.: 200409069N</div> </div> <div> <div>Main Claimant:</div> <div>MINISTRY MEDICAL GROUP PTE LTD, Co. Reg. No.: 201432854H</div> </div> <div> <div>Vehicle Reg. No.:</div> <div>EC60B</div> </div> <div> <div>Claim Type:</div> <div>TP</div> </div> <div> <div>Vehicle Reg. No. (Insured):</div> <div>WC3082E</div> </div> <div> <div>Repairer:</div> <div>MBM Wheelpower Pte Ltd (HQ) 160 SIN MING DRIVE #06-02, SIN MING AUTOCITY, 575722 Sin Ming - Tel: 6262 8888</div> </div> <div> <div>Handling Insurer:</div> <div>MSIG Insurance (Singapore) Pte. Ltd. (HQ) - Tel: +65 6827 7888 ... [Handled by Irene Tan Gek Ing - 6594 2541]</div> </div> <div> <div>Adjuster:</div> <div>LKK Auto Consultants Pte Ltd (HQ) - Tel: 6256-3561 ... [Imm.Advice due 10/01/2018]</div> </div> <div> <div>Excess:</div> <div>S\$2,000.00</div> </div> <div> <div>Date of Loss:</div> <div>06/01/2018 14:00 - :59</div> </div> <div> <div>Policy/Cover Note No.:</div> <div>28744780MKC (Comprehensive) Coverage: 05/06/2017 - 04/06/2018</div> </div> <div> <div>Policy No. (Claimant):</div> <div></div> </div>				
<div> <div> <div>Created by insurer</div> </div> </div>				
ASSOCIATED MAIL RECEIVED				
There are no mail for this case. <div>View All</div> <div>Compose Case Mail</div>				
ALL ASSOCIATED TASKS				
<div> <div>View All</div> <div>Search Tasks</div> <div>Create New Task</div> <div>Complete</div> </div>				
<div> <div>Due Date</div> <div>Priority</div> <div>Type</div> <div>Task Group</div> <div>Subject</div> <div>...</div> </div>				
No results. <div>On</div> <div>Done?</div>				

Tan Jin Hao

From: Woon Choo Kwok
Sent: Tuesday, 9 January, 2018 3:29 PM
To: Irene Tan; Tan Jin Hao
Cc: Christopher Chionh; Foo Ai Ngoh; Jason Sim
Subject: FW: Liability Status - Accident involving EC60B & WC3082E (MSIG) on 22/12/17 - TP CLAIM
Attachments: EC60B.PDF

Dear IT & TJH

FYA

Best Regards

Kwok Woon Choo
Senior Administrative Officer, Claims Services
Direct line +65 6643 1330 | Direct fax +65 6225 7402 | woonchoo_kwok@sg.msig-asia.com



MSIG

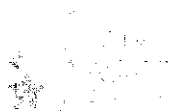

Insurer Claims
Team of the Year
2016

MSIG Insurance (Singapore) Pte Ltd 16 Raffles Quay, #24-01 Hong Leong Building, Singapore 048581 | T: +65 6220 9644 | F: +65 6225 6371 | Co. Reg. No. 200412212G | msig.com.sg

A Member of **MS&AD** INSURANCE GROUP

From: Agnes Lee
Sent: Tuesday, January 09, 2018 2:57 PM
To: Woon Choo Kwok <WoonChoo_Kwok@sg.msig-asia.com>
Subject: FW: Liability Status - Accident involving EC60B & WC3082E (MSIG) on 22/12/17 - TP CLAIM

From: danny.ong@mbmwheelpower.com.sg [<mailto:danny.ong@mbmwheelpower.com.sg>]
Sent: 09 January 2018 14:43
To: Claims <claims@sg.msig-asia.com>
Cc: joseph.tan@mbmwheelpower.com.sg; kenneth@mbmwheelpower.com.sg
Subject: Liability Status - Accident involving EC60B & WC3082E (MSIG) on 22/12/17 - TP CLAIM

Dear Sir / Madam,

Appreciate if you can advise us on the liability status for the below loss and arrange a pre-survey for the above mentioned vehicle as vehicle is in our premises now.

Kindly refer to the attached GIA report and estimate.

Our Client's Vehicle Number:	EC60B
Your insured Vehicle Number:	WC3082E
Date/Time of Loss:	06/01/2018 1415hrs

Kindly arrange your surveyor to survey the vehicle at **160 Sin Ming Drive #06-02 Sin Ming Autocity**
Singapore 575722

Please contact Joseph – 86865188 for the survey arrangement.

****Kindly take note of the new mailing address****

Best regards,

Danny Ong / Claims Advisor

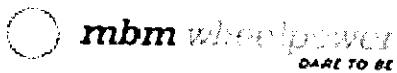

T 6262 8888 | F 6250 9015 | M 9328 8668

Email: danny.ong@mbmwheelpower.com.sg

MBM Wheelpower Pte Ltd

160 Sin Ming Drive • #06-02

Sin Ming AutoCity • Singapore 575722

www.mbmwheelpower.com.sg

CONFIDENTIALITY NOTICE

This e-mail (including any attachments) may contain information that is privileged, confidential or otherwise intended for a specific person other than the intended recipient. If you are not the intended recipient, you should not disseminate, distribute or copy this e-mail. If you have received this e-mail by mistake, please notify the sender immediately, delete the email and do not copy, retransmit, or otherwise use the information contained herein. If you are not the intended recipient, you should not disseminate, distribute or copy this e-mail.



LKK Auto Consultants Pte Ltd

51 Ubi Ave 1 #01-25 Paya Ubi Industrial Park, Singapore 408933

TEL: 6256 3561 FAX: 6256 4315

Reg. No: 199607198R GST Reg. No. 19-9607198-R

Affiliated to Federation Internationale Des Experts En Automobile				
MSG INSURANCE (SINGAPORE) PTE LTD			Ref : CS/MSG18000564/Ktd3	
16 RAFFLES QUAY #24-01 HONG LEONG BLDG SINGAPORE 048581			Date : 09-01-2018	
Code : MSG				
1. Policy Particulars - THIRD PARTY CLAIM				
Insured Veh.	WC 3082E	Veh. Inspected	EC 60B	
Policy No.	28744780MKC	Coverage (\$)	0.00	
Claim No.		Excess (\$)	0.00	
Assign From	MERIMEN (IRENE TAN)	Assign Date	09/01/2018	
2. Vehicle Particulars & Condition				
Make & Model		c.c	0	
Engine No.	HIDDEN	Year of Reg.		
Chassis No.		Colour		
Odometer	-	Steering		
Brakes		Modification		
General				
3. Conditions of Tyres				
	Size	Make	Balance	
R/H Front Tyre			mm	
L/H Front Tyre			mm	
R/H Rear Tyre			mm	
L/H Rear Tyre			mm	
4. Description of Damages				
5. General Information				
Accident Date	06/01/2018	Inspection Date		
Survey held at	160 SIN MING DRIVE #06-02			
Repairer	MBM WHEELPOWER PTE LTD			
5a. Remarks				
A)THE INSPECTION WAS CONDUCTED ON A"WITHOUT PREJUDICE" BASIS. B)IN ACCORDANCE TO YOUR INSTRUCTIONS, WE HAVE NOT AUTHORISED REPAIRS.				

SINGAPORE ACCIDENT STATEMENT

IMPORTANT NOTICE

1. Please report correctly the details of the accident to speed up the claims process.
2. This Form must be completed by the Policyholder and/or the Authorised Driver.
3. Information provided must be as truthful and accurate as possible. Any wilful misrepresentation or withholding of material facts may allow insurance companies to repudiate policy ability.
4. The issue and acceptance of this Form by insurance companies is not an admission of policy liability on the part of the insurance companies.
5. Any false reporting may be referred to the Police for investigation.
6. This report will be forwarded by the insurers of the insurers of the GIA Records Management Centre established by the General Insurance Association of Singapore (GIA) for archiving and that copies of this report will for a fee be made available upon application by interested parties.
7. By the lodgement of this report to the insurers, you hereby consent to the archiving of this report at the centre and to copies of the report being made available aforesaid.

ACCIDENT STATEMENT

Date Of Report	08/01/2018 14:12
Date Of Accident	06/01/2018 14:45
Exact Location Of Accident	ALONG SIGLAP HILL JUNCTION OF LA SALLE ST
Country/State of Loss	SINGAPORE

DETAILS OF OWN VEHICLE

Vehicle Registration Number	EC60B
Insured/Policyholder	
Name Of Registered Owner	MINISTRY MEDICAL GROUP PTE LTD
Co Reg No	201432854H
Email Address	ERIC@MINMED.SG
Mobile Phone No	
Alternative Phone No	OFFICE-63399339

Vehicle Particulars

Manufacturer	TOYOTA
Model	VELLFIRE-2.5 Z G-EDITION CVT (A)

Exact Purpose for which vehicle was being used at time of accident

Are you claiming under your own insurance policy for repair to your vehicle? NO

If No, Please state action to be taken THIRD PARTY

Vehicle Category PRIVATE CAR

Insurance Company

Name of Insurance Company	AXA INSURANCE PTE LTD
Type Of Coverage	COMPREHENSIVE
Fleet Policy	NO
Policy Number	VA1/GA047212
Cover Note Number	

Driver

Name of Driver	ERIC CHIAM CHOON GUAN
NRIC No	S7207019D
Date Of Birth	23/01/1972
Occupation	INDOOR
Date Of Driving Pass	12/12/1989
Driving Experience	28 YEARS AND 0 MONTHS
Gender	MALE
Mobile Number	(LOCAL) +65-92393313
Fax Number	
Contact Number	OFFICE-90092899
Email Address	ERIC@MINMED.SG

Address	13 YARROW GARDENS
Postcode	455018
Was driver an employee of the Insured's Company	YES
If No, Relationship of the Driver with the Insured	
Vehicle Registration Number of Driver's Own Vehicle	-
	-
	-
Insurance Company of Driver's Own Vehicle	-
	-
	-

General Information of the Accident

Type Of Accident	COLLISION - MAJOR/MINOR RD
Weather Conditions	CLEAR
Road Surface	DRY

Other Information

Was any foreign vehicle involved in this accident?	NO
Number of vehicles involved in the accident	2
Was any body injured in the Accident?	NO
Was any injured conveyed to hospital by ambulance?	NO
Was any other material or property damaged?	YES
I have been approached by unknown person(s) soliciting/offering accident claims assistance.	NO
Number of Passengers (Including Driver)	5
Passenger 1	NAME: : CHEN LISA GENDER: : FEMALE
Passenger 2	NAME: : ANDRE CHIAM GENDER: : MALE
Passenger 3	NAME: : ETHAN CHIAM GENDER: : MALE
Passenger 4	NAME: : SOPHIA CHIAM GENDER: : FEMALE

Details of Police Action

Was the accident reported to the police?	NO
If Yes, Please state which Police Station	
Was notice of intended Prosecution given?	NO
If Yes, against whom?	

Circumstances of Accident

REFER TO SKETCH PLAN

Attachment(s)

Are accident photos available for attachment?	YES
Was there any video captured by Car Camera?	YES
Was there any audio recorded?	NO

DETAILS OF OTHER VEHICLE PROPERTY 1

Vehicle Registration Number	WC3082E
Vehicle Make/Model/Colour	ISUZU CEMENT TRUCK
Details Of Properties	VEH. B
Vehicle Category	GOODS VEHICLE
Name of Driver	KANAGARAJAN KARTHIKEYAN

NRIC/Passport Number	
Contact Number	81175756
Address	
Postcode	
Insurance Company Name	
Nature Of Damage	RH PORTION
No. Of Passenger (Including Driver)	2

SKETCH PLAN

IMPORTANT NOTICE

1. Please report correctly the details of the accident to speed up the claims process.
2. This Form must be completed by the Policyholder and/or the Authorised Driver.
3. Information provided must be as truthful and accurate as possible. Any wilful misrepresentation or withholding of material facts may allow insurance companies to reassess policy liability.
4. The issue and acceptance of this Form by insurance companies is not an admission of policy liability on the part of the insurance companies.
5. Any false reporting may be referred to the Police for investigation.
6. The report will be forwarded by the Insurers of the GIA Records Management Centre established by the General Insurance Association of Singapore (GIA) for archiving and that copies of this report will for a fee be made available upon application by interested parties.
7. By the lodging of this report to the Insurers, you hereby consent to the archiving of this report at the centre and to copies of the report being made available aforesaid.
8. Consent under the Personal Data Protection Act (PDPA)

I understand, acknowledge, agree and consent that:

- (a) My insurer, my workshop and the General Insurance Association of Singapore ("GIA") may/are permitted to collect, use, disclose and/or process my personal data/personal information set out in this form and any other personal information provided by me or possessed by my insurer (collectively the "Personal Information") and disclose and transfer such Personal Information to all insurer(s) who have insured vehicle(s) involved in this accident (all insurer(s) who have insured vehicle(s) involved in this accident shall be collectively referred to as the "Insurers"), the Insurers' lawyers/law firms, the Monetary Authority of Singapore and any relevant government agency/authority (such as the police), for the purpose(s) of:
 - (i) processing, handling and/or dealing with my claims including the settlement of the claims and any necessary investigations relating to the claims;
 - (ii) investigating the accident and/or my claims;
 - (iii) carrying out and/or dealing with my instructions or responding to any enquiries by me;
 - (iv) administering my claims (including the mailing of correspondence, statements, invoices, reports or notices to me, which could involve disclosure of certain personal data about me in bring about delivery of the same as well as on the external cover of envelopes/mail packages); and/or
 - (v) complying with applicable law in administering, processing, handling and/or dealing with my claims (collectively the "Purposes")
- (b) all insurer(s) who have insured vehicle(s) involved in this accident and the Insurers' lawyers/law firms, may/are permitted to collect, use, disclose and/or process my Personal Information for one or more of the above purposes; and
- (c) my Personal Information may/can be disclosed by any of the Insurers and/or GIA to their third party service providers or agents (including their lawyers/law firms), which may be sited outside of Singapore, for one or more of the above purposes.
- (d) my Personal Information will also be collected and used to compile claims history for the purpose of fraud detection, investigation and management in present and all future claims.
- (e) the information so collected under (d) above may be shared / disclosed:
 - (i) to all Insurers and/or any other third parties that assist in evaluating, investigating, controlling or managing fraud, regulators, law enforcement and government agencies as reasonably required for the purposes stated, or
 - (ii) for complying with requirements under any regulations, laws or court orders.

Policyholder's Signature
Date & Time:

Driver's Signature
(If driver is not the policyholder)
Date & Time:

Reporting Centre Personnel's Signature
Name:
NRIC/ID No.:

GIA/BMC Sketch Plan Form V3

MINISTRY MEDICAL GROUP PTE LTD

100 Lorong 23 (Off Sims Avenue)

#08-02 D'Centennial

Singapore 368398

Tel: 6339 9339 Fax: 6339 9789

Reg. No. 201432854H

Chuan Chuan
Chuan ERC
8/1/14

Sketch Plan Pg. 2

SKETCH PLAN

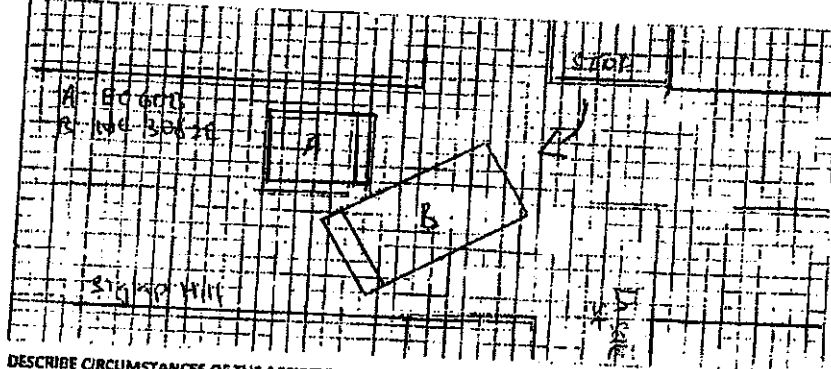

DESCRIBE CIRCUMSTANCES OF THE ACCIDENT

On 6/1/18 at 14.43h, I was driving along Singapore Hill. Weather was sunny and clear. As I approached the junction of LaSalle Street and Singapore Hill, I noticed a cement mixer coming down the LaSalle Street. It was moving and did not stop at the stop line.

I applied emergency brake and sounded the horn continuously immediately (Refer to audio audio/video clip). The cement mixer MC 3082E driven by Mr. Paragaran continued to move and turn right. The truck failed to stop until it collided against the front right end of my vehicle, which was stationary.

A video footage was captured in my front dashcam which is submitted for reference.

DECLARATION

I/We declare the foregoing particulars are true in every respect.

Policyholder's Signature
Date & Time:

GIMAC (1) (1/1/18) (1/1/18)

Driver's Signature
(If driver is not the policyholder)
Date & Time:

8/1/18

CHIAM HAN ZU
GIMAC

Reporting Officer/Personnel's Signature
Name:
NIC/IN No.:

MINISTRY MEDICAL GROUP PTE LTD

108 Lorong 23 (Off Sims Avenue)

#08-02 D'Centennial

Singapore 388398

Tel: 6339 9339 Fax: 6339 9789

Reg. No. 201432854H

Enquire PARF/COE Rebate for Registered Vehicle

Vehicle Owner Particulars

Owner ID Type:	Company
Owner ID:	2854H

Vehicle Details

Vehicle No.:	EC60B
Vehicle to be Exported:	No
Intended De-registration Date:	08 Jan 2018
Vehicle Make:	TOYOTA
Vehicle Model:	VELLFIRE 2.5Z-A EDITION A
Primary Colour:	Black
Manufacturing Year:	2015
Engine No.:	2ARH542091
Chassis No.:	AGH300007721
Maximum Power Output:	134.0 kW (179 bhp)
Open Market Value:	\$34,890.00
Original Registration Date:	24 Jun 2015
First Registration Date:	24 Jun 2015
Transfer Count:	0
Actual ARF Paid:	\$40,846.00

Intended PARF Rebate Details

PARF Eligibility:	Yes
PARF Eligibility Expiry Date:	23 Jun 2025
PARF Rebate Amount:	\$30,634.00

Intended COE Rebate Details

COE Expiry Date:	23 Jun 2025
COE Category:	B - Car above 1600cc or 97kW (130bhp)
COE Period(Years):	10
QP Paid:	\$75,000.00
COE Rebate Amount:	\$55,937.00
Total Rebate Amount:	\$86,571.00

The information contained herein is correct as at 08 Jan 2018

OK

MBM WHEELPOWER PTE LTD

Your Ref: WC3082E

Our Ref: EC60B

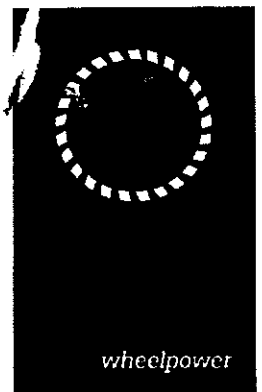

To: MSIG INSURANCE SINGAPORE

CC

Email

Fax

Date:

9/1/2018

From:

Jospeh

Fax:

62509015

Contact:

86865188

Make / Model:

TOYOTA VELLFIRE 2.5Z A

Chassis No.:

AGH300007721

Engine No.:

2ARH542091

Year of Make:

2015

Accident Date:

6 January 2018

ESTIMATE FOR VEHICLE NO. : EC60B

DESCRIPTION

HEAD LAMP RH

SIGNAL LAMP RH

FRONT BUMPER

FRONT BUMPER CLIPS

FRONT BUMPER SIDE SUPPORT RH

FRONT BUMPER SUPPORT LOWE SIDE RH

FRONT BUMPER SPONGE

FRONT BUMPER REINFORCEMENT

FRONT BUMPER HOLE COVER ASSY RH

FRONT BUMPER HOLE COVER RH

FRONT RH FENDER

FRONT RH FENDER INNER SHIELD

FRONT RH FENDER INNER SHIELD CLIPS

FRONT RH SHOCK ABSORBER

FRONT RH KNUCKLE ARM

FRONT RH KNUCKLE ARM BEARING

FRONT RH STABILIZER

FRONT RH BALL JOINT

QTY

1

1

1

1

1

1

1

1

1

1

1

1

1

1

1

1

1

1

1

List Price

CM 4,300.00

CM 120.00

CM 2,200.00

40 200.00

120.00

120.00

150.00

650.00

290.00

90.00

1,650.00

320.00

80.00

550.00

700.00

650.00

200.00

350.00

LKK Auto Consultants hence notify the Repairer of the following:

- To resurvey before/after spray painting
- To display damaged part(s) during resurvey
- Parts prices are subject to confirmation
- Third party survey is on a "Without Prejudice" basis
- No illegal modification(s) is allowed
- Supplementary item(s) must be resurveyed and is subject to final approval from Insurance Company

Acknowledged by Repairer

Signature:

Date:

Mbm wheelpower pte ltd

160 SIN MING DRIVE

#06-02

SIN MING AUTOCITY

t 66430983 f 64529823

Company Registration Number : 200204110W

FRONT RH TIE ROD END
FRONT RH RIM

1	\$	220.00	X
1	\$	900.00	nc 3,100.00
Total:		\$	15,940.00
LESS 25%		\$	(3,985.00)
Parts Total:		\$	11,955.00

SPECIAL NETT

ANTI RUST COATING

1 \$ 150.00

BODY SEALANT

1 \$ 120.00 X

FRONT BUMPER SENSORS

1 SET \$ 300.00

TYRE

1 \$ 280.00

LABOUR

TO REMOVE, REFIT & REPAIR AFFECTED DAMAGED PARTS. INCLUDING TO KNCOK-OUT, STRAIGHTEN, ON THE AFFECTED AREAS

\$ 1,200.00

TO CHECK & RECONNECT ALL NECESSARY WIRING

\$ 80.00

TO DISMANTLE AND REPLACE OF UNDERCARRIAGE

\$ 200.00

TO CONDUCT ALL WHEEL COMPUTERISED ALIGNMENT

\$ 80.00

TO SPRAY PAINTING ON THE AFFECTED AREA

\$ 1,000.00

Total: \$ 15,365.00

7% GST: \$ 1,075.55

Grand Total: \$ 16,440.55

Please survey the vehicle at :-
160 SIN MING DRIVE,
#06-09 SIN MING AUTOCITY,
SINGAPORE 575722

(Kindly contact Jospheh @ 86865188)

Mbm wheelpower pte ltd
160 SIN MING DRIVE
#06-02
SIN MING AUTOCITY
t 62828888 f 64529823

Company Registration Number : 200204110W

Kf



MBM WHEELPOWER PTE LTD

Your Ref: WC3082E

Our Ref: EC60B

To: MSIG INSURANCE SINGAPORE

Date: 9/1/2018

CC

From: Joseph

Fax: 62509015

Email

Contact: 86865188

Make / Model: TOYOTA VELLFIRE 2.5Z A

Fax

Chassis No.: AGH300007721

Engine No.: 2ARH542091

Year of Make: 2015

Accident Date: 6 January 2018

ESTIMATE FOR VEHICLE NO.: EC60B

DESCRIPTION	QTY	List Price
HEAD LAMP RH 3876.50	1	\$ 4,300.00 ✓
SIGNAL LAMP RH	1	\$ 120.00 ✓
FRONT BUMPER 1890.30	1	\$ 2,200.00 ✓
FRONT BUMPER CLIPS 10 20	40	\$ 80.00 ✓
FRONT BUMPER SIDE SUPPORT RH	1	\$ 120.00 ✓
FRONT BUMPER SUPPORT LOWE SIDE RH	1	\$ 120.00 ✓
FRONT BUMPER SPONGE	1	\$ 150.00 ✓
FRONT BUMPER REINFORCEMENT	1	\$ 650.00 ✓
FRONT BUMPER HOLE COVER ASSY RH	1	\$ 280.00 ✓
FRONT BUMPER HOLE COVER RH	1	\$ 90.00 ✓
FRONT RH FENDER 1276.20	1	\$ 1,850.00 ✓
FRONT RH FENDER INNER SHIELD 230.00	1	\$ 320.00 ✓
FRONT RH FENDER INNER SHIELD CLIPS 45 10	50	\$ 80.00 ✓
FRONT RH SHOCK ABSORBER	1	\$ 550.00 ✓
FRONT RH KNUCKLE ARM	1	\$ 700.00 ✓
FRONT RH KNUCKLE ARM BEARING	1	\$ 650.00 ✓
FRONT RH STABILIZER	1	\$ 200.00 ✓
FRONT RH BALL JOINT	1	\$ 350.00 ✓

LKK Auto Consultants hereto notify the Repairer of the following:

- To resurvey before/after spray painting
- To display damaged part(s) during resurvey
- Parts prices are subject to confirmation
- Third party survey is on a "Without Prejudice" basis
- No illegal modification(s) is allowed
- Supplementary item(s) must be resurveyed and is subject to final approval from Insurance Company

Acknowledged by Repairer

Signature:

Date:

MBM wheelpower pte ltd

100 SIN MING DRIVE

#08-02

SIN MING AUTOCITY

T 65430993 / 64528623

Company Registration Number: 200204110W

FRONT RH TIE ROD END
FRONT RH RIM

1 \$ 220.00 X
1 \$ 900.00 net 3,100.00
Total: \$ 15,940.00
LESS 25% \$ (3,985.00)
Parts Total: \$ 11,955.00

SPECIAL NETT
ANTI RUST COATING
BODY SEALANT
FRONT BUMPER SENSORS
TYRE

1 \$ 150.00
1 \$ 120.00 X
1 SET \$ 300.00
1 \$ 196.50 net 280.00
700.00

LABOUR
TO REMOVE, REFIT & REPAIR AFFECTED DAMAGED PARTS. INCLUDING TO
KNOCK-OUT, STRAIGHTEN, ON THE AFFECTED AREAS
TO CHECK & RECONNECT ALL NECESSARY WIRING
TO DISMANTLE AND REPLACE OF UNDERCARRIAGE
TO CONDUCT ALL WHEEL COMPUTERISED ALIGNMENT
TO SPRAY PAINTING ON THE AFFECTED AREA

\$ 1,200.00
\$ 80.00
\$ 200.00
\$ 80.00
\$ 1,000.00
Total: \$ 15,365.00
7% GST: \$ 1,075.55
Grand Total: \$ 16,440.55

Please survey the vehicle at :-
160 SIN MING DRIVE,
#06-09 SIN MING AUTOCITY,
SINGAPORE 675722

(Kindly contact Joseph @ 8885188)

Mbm wheelpower pte ltd
160 SIN MING DRIVE
#06-02
SIN MING AUTOCITY
1 8282888 / 64528823

Company Registration Number : 200204110W

...CLAIM SUBFOLDER...(Pending for Survey Report)

CLAIM SUBFOLDER TRACKING							
Case	Notified	Est Submitted	Adj Assigned	Adj Rpt	Adj Submitted	Ins Auth'ed	Status
Main	09 Jan 2018		09 Jan 2018 15:49 Edit Adj Rpt	S\$8,368.25 Edit Estimates	S\$8,368.25 View Rpt		Pending for Survey Report Cancel Case

Main	Reference	Claim Details	Documents	Show All					
CLAIM SUBFOLDER DETAILS [Created by insurer]									
Insured:	SAMWOH READY MIX PTE LTD , Co. Reg. No.: 200409069N								
Main Claimant:	MINISTRY MEDICAL GROUP PTE LTD , Co. Reg. No.: 201432854H								
Vehicle Reg. No.:	EC60B	Date of Loss:	06/01/2018 14:00 - :59 [30 Months and 13 Days From LTA Reg Date (Man Yr)]						
Claim Type:	TP / 545046	Policy/Cover Note No.:	28744780MKC (Comprehensive) Coverage: 05/06/2017 - 04/06/2018						
Vehicle Reg. No. (Insured):	WC3082E	Policy No. (Claimant):							
		Excess:	S\$2,000.00						
Repairer:	MBM Wheelpower Pte Ltd (HQ) 160 Sin Ming Drive #06-02, Sin Ming AutoCity, 575722 Sin Ming - Tel: 6262 8888								
Handling Insurer:	MSIG Insurance (Singapore) Pte. Ltd. (HQ) - Tel: +65 6827 7888 ... [Handled by Irene Tan Gek Ing - 6594 2541]								
Adjuster:	LKK Auto Consultants Pte Ltd (HQ) - Tel: 6256-3561 ... [Handled by KENNETH KONG] ... [Final Rpt due 08/02/2018]								
ASSOCIATED MAIL RECEIVED View All Compose Case Mail									
There are no mail for this case.									
ALL ASSOCIATED TASKS <input type="checkbox"/> View All Search Tasks Create New Task Complete									
Due Date	Priority	Type	Task Group	Subject	Handler	Assigned By	Completed On	Created On	Done?
No results.									

Claim Documents

*EC60B (545046)
[WC3082E]
TP
MINISTRY MEDICAL GROUP PTE LTD
Jan 6 2018 2:00PM
[SAMWOH READY MIX PTE LTD]
MBM Wheelpower Pte Ltd

Upload Documents Upload Photos Compose New Letter			View View in Browser	
Assessment Reports			1 per page <input checked="" type="checkbox"/>	
No	Finalized On	LKK Auto Consultants Pte Ltd (HQ)	Thumbnail	Print
1	17/01/18 13:29	Adjuster Immediate Advice	Load HTM	<input checked="" type="checkbox"/>
Photos/Images				
			3 per page <input checked="" type="checkbox"/>	
No	Relabel/Reorder	LKK Auto Consultants Pte Ltd (HQ)	Thumbnail	Print
1	15/05/18 12:13	General View	Load JPG	<input checked="" type="checkbox"/>
2	15/05/18 12:13	General View	Load JPG	<input checked="" type="checkbox"/>
3	15/05/18 12:13	General View	Load JPG	<input checked="" type="checkbox"/>
4	15/05/18 12:13	General View	Load JPG	<input checked="" type="checkbox"/>
5	15/05/18 12:13	General View	Load JPG	<input checked="" type="checkbox"/>
6	15/05/18 12:13	General View	Load JPG	<input checked="" type="checkbox"/>
7	15/05/18 12:13	General View	Load JPG	<input checked="" type="checkbox"/>
8	15/05/18 12:13	General View	Load JPG	<input checked="" type="checkbox"/>
9	15/05/18 12:13	General View	Load JPG	<input checked="" type="checkbox"/>
10	15/05/18 12:13	General View	Load JPG	<input checked="" type="checkbox"/>
11	15/05/18 12:13	General View	Load JPG	<input checked="" type="checkbox"/>
12	15/05/18 12:13	General View	Load JPG	<input checked="" type="checkbox"/>
13	15/05/18 12:13	General View	Load JPG	<input checked="" type="checkbox"/>
14	15/05/18 12:13	General View	Load JPG	<input checked="" type="checkbox"/>
15	15/05/18 12:13	General View	Load JPG	<input checked="" type="checkbox"/>
16	15/05/18 12:14	Reinspection Photo	Load JPG	<input checked="" type="checkbox"/>
17	15/05/18 12:14	Reinspection Photo	Load JPG	<input checked="" type="checkbox"/>
18	15/05/18 12:14	Reinspection Photo	Load JPG	<input checked="" type="checkbox"/>
Documentation			1 per page <input checked="" type="checkbox"/>	
No	Finalized On	MSIG Insurance (Singapore) Pte. Ltd. (HQ)	Thumbnail	Print
1	09/01/18 15:50	Email from TP for survey	Load PDF	<input checked="" type="checkbox"/>
2	09/01/18 15:50	TP estimate & GIA REPORT	Load PDF	<input checked="" type="checkbox"/>

Documents Checklist

DOCUMENTS CHECKLIST		Reset Save Print
There are no document checklists configured.		
Our Checklist Remarks - LKK Auto Consultants Pte Ltd (HQ) <div style="border: 1px solid black; height: 40px; margin-top: 5px;"></div>		
Show Remarks To: <input type="checkbox"/> Handling Insurer <small>Note: Remarks are private unless you show it to other parties.</small>		

LKK Auto Consultants Pte Ltd (Co.Reg.No:199607198R)

51 Ubi Ave 1 #01-25, Paya Ubi Industrial Park

Singapore 408933

Tel: 6256-3561 Fax: 6844-8805 Email: sur@lkkauto.com;assignments@lkkauto.com

VEHICLE DAMAGE INSPECTION REPORT

Our File No: CS/MSG18000564/KTD3E2

Date: 22/05/2018

REFERENCE

Handling Insurer: MSIG Insurance (Singapore) Pte. Ltd.

Policy No: 28744780MKC

Claimant Vehicle EC60B

Insured Vehicle No : WC3082E

No :

Date of Loss: 06/01/2018

Nature of Claim: TP

Claim No: 545046

DESCRIPTION & IDENTIFICATION OF VEHICLE

Reg No: EC60B

Make & Model: TOYOTA VELLFIRE, 2.5 Z G-EDITION CVT (A)

Engine No: 2ARH542091

Reg. Date: 24/06/2015 (Man. Year: 2015)

Chassis No: AGH300007721

Colour: Metallic Black

Odometer: 53544 km

Engine Capacity: 2493 cc

Market Value/New Car Price: N/A

Sum Insured (S\$): Market Value/New Car Price

CONDITION OF VEHICLE AT THE TIME OF SURVEY

General Condition: Steering (Serviceable): Yes Footbrake (Serviceable): Yes

Handbrake (Serviceable): Yes Engine Modification: No Pre-accident Condition: Yes

CONDITION OF TYRES

Front Tyre Size: 235/50 R18

Rear Tyre Size: 235/50 R18

Front Left Side: Toyo 7 mm

Rear Left Side: Toyo 8 mm

Front Right Side: Toyo 7 mm

Rear Right Side: Toyo 8 mm

The above values represent the remaining tyre treads depth

COST OF CLAIMS	Repairer's	Adjuster's	Difference	Diff %
Parts	12,655.00	7,098.25	5,556.75	43.91
Miscellaneous Items	0.00	0.00	0.00	
Labour	2,710.00	1,270.00	1,440.00	53.14
Paintwork Labour	0.00	0.00	0.00	
Towing	0.00	0.00	0.00	
Gross Total (S\$)	15,365.00	8,368.25	6,996.75	45.54
+ GST 7.00/7.00% (S\$)	1,075.55	585.78	489.77	45.54
Nett Amount (S\$)	16,440.55	8,954.03	7,486.52	45.54

INSPECTION

Date of Assignment: 09/01/2018

Date Inspected: 11/01/2018 Inspected At:

MBM Wheelpower Pte Ltd (HQ)
160 SIN MING DRIVE #06-02, SIN MING
AUTOCITY
Singapore 575722

Estimated Period of Repair: 5.0 days

Adjuster: KENNETH KONG

Manager: DENISE TAY KWEE CHENG

NOTE: This report represents our findings at the time and place of inspection stated herein. Such inspection has been carried out to the best of our knowledge and ability but any other liability under any other circumstances is hereby expressly excluded.

REPAIR DETAILS

Reference

Part Source: MRM-SG **Version:** 1.0 (Last Synchronised: 22 May 2018)
Parts: M1-MPV TOYOTA VELLFIRE 2.5 Z G-EDITION CVT (A) (Catalogue:Merimen Singapore 1.0)
Labour: Repairer's (Price-denominated Standard List)
Print Code: (Unsubmitted, no print-code for EC60B)
Validity: These estimates are valid only if they contain the print code (above) on all estimate pages, running page numbers with the END OF ESTIMATES marker on the last estimate page
Further Info: Items/values not in reference catalogue are prefixed with an asterisk *.

Recommended Parts

No.	Qty	Part No. Particulars	Condition	Repairer's	Amount
1	1	*HEAD LAMP RH	Cracked	4,300.00 FL	*3,876.50 FL
2	1	*SIGNAL LAMP RH	Cracked	120.00 FL	*120.00 FL
3	1	*FRONT BUMPER	Cracked	2,200.00 FL	*1,890.30 FL
4	1	*FRONT BUMPER CLIPS (20PCS)	Necessary-only 10 pcs	80.00 FL	*40.00 FL
5	1	*FRONT BUMPER SIDE SUPPORT RH	Distorted	120.00 FL	*120.00 FL
6	1	*FRONT BUMPER SUPPORT LOWER SIDE RH	Serviceable	120.00 FL	*- FL
7	1	*FRONT BUMPER SPONGE	Serviceable	150.00 FL	*- FL
8	1	*FRONT BUMPER REINFORCEMENT	Repair	650.00 FL	*- FL
9	1	*FRONT BUMPER HOLE COVER ASSY RH	Serviceable	290.00 FL	*- FL
10	1	*FRONT BUMPER HOLE COVER RH	Serviceable	90.00 FL	*- FL
11	1	*FRONT RH FENDER	Bent	1,650.00 FL	*1,276.20 FL
12	1	*FRONT RH FENDER INNER SHIELD	Distorted	320.00 FL	*230.00 FL
13	1	*FRONT RH FENDER INNER SHIELD CLIPS (15 PCS)	Necessary-only 10 pcs	80.00 FL	*50.00 FL
14	1	*FRONT RH SHOCK ABSORBER	Serviceable	550.00 FL	*- FL
15	1	*FRONT RH KNUCKLE ARM	Serviceable	700.00 FL	*- FL
16	1	*FRONT RH KNUCKLE ARM BEARING	Not Necessary	650.00 FL	*- FL
17	1	*FRONT RH STABILIZER	Serviceable	200.00 FL	*- FL
18	1	*FRONT RH BALL JOINT	Serviceable	350.00 FL	*- FL
19	1	*FRONT RH TIE ROD END	Serviceable	220.00 FL	*- FL
20	1	*FRONT RH RIM	Dented	2,325.00 FS	*900.00 FS
21	1	*BODY SEALANT	Not Necessary	120.00 FS	*- FS
22	1	*SET FRONT BUMPER SENSORS	Dented	300.00 FS	*300.00 FS
23	1	*TYRE (70%)	Punctured	280.00 FS	*196.00 FS

F=Franchise part. S=SpcNett. L=ListItemDisc.

Sub Total (S\$)	15,865.00	8,999.00
- List Item Discount on L Items 25.00/25.00% (S\$)	3,210.00	1,900.75
Total Parts (S\$)	12,655.00	7,098.25

Report was unsubmitted during this print-out.

Recommended Miscellaneous Items

There are no new miscellaneous items selected.

Recommended Labour

No	Particulars	Lab.Type	Repairer's	Amount
Labour Items				
1	ANTI RUST COATING	New	150.00	30.00
2	TO REMOVE, REFIT & REPAIR AFFECTED DAMAGED PARTS. INCLUDING TO KNOCK-OUT, STRAIGHTEN, ON THE AFFECTED AREAS	New	1,200.00	500.00
3	TO CHECK & RECONNECT ALL NECESSARY WIRING	New	80.00	20.00
4	TO DISMANTLE AND REPLACE OF UNDERCARRIAGE	New	200.00	160.00
5	TO CONDUCT ALL WHEEL COMPUTERISED ALIGNMENT	New	80.00	60.00
6	TO SPRAY PAINTING ON THE AFFECTED AREA	New	1,000.00	500.00
Gross Labour Cost (S\$)			2,710.00	1,270.00

Report was unsubmitted during this print-out.

< END OF ESTIMATES >