

ASS: REC. BY:

REF: CS3/FCI17023676/71d392

Special Instructions:

Surveyor:

Taufik

ASSIGNMENT (Office)

CWS

From (Person):

Karen Tan

of

FCI

Date/Time: 2:06pm @ 13/12/17

Estimated Cost:

Bill to:

OD / TP / WS / TP RES / OD RES / EVA / INV / MV / CS

To Inspect Vehicle No:

SGC9475E

Insured:

SHA 4886J

at Workshop m/s

Z-One Automotive

Tel:

62502115 / 97552115

of

7 Soon Lee Street Ispace #01-27/47, 627608

Policy No:

Claim No:

D17611472MFSH

Sum Insured:

Excess:

Make of Veh:

D.O.A.

12/12/2017

(Client's Record)

CA / REV / REP. / REV 24 HRS

(wp)

H.G.D. Endorsement:

Date/Time:

2:16pm @ 13/12/17

Person Contacted:

Yvonne

Vehicle IN/OUT

Date/Time	Action/Instruction (X) Estimate
	SGC9475E - X
	SHA 4886J - CS/TMI16012120/H1qbn2
	Dismantle: 14/12/2017

D.O.A: 29/06/2016

First Capital Insurance Limited

A FAIRFAX Company

Company Reg. No. 195000106C

GST Reg. No. M2-0001676-9

MOTOR SURVEY ASSIGNMENT

Date	12-12-2017	Our Ref No. D17011472MFSH
Accident Date	12-12-2017	Claim Type. Third Party
Insured Vehicle	SHA4886J	Third Party Vehicle. SGC9457E
Survey Location	7 SOON LEE STREET ISPACE#01-27/47 S 627608	
Contact Person.	YVONNE	
Contact No.	62502115/ 97552115	Fax No. 0
Survey Type	WITHOUT PREJUDICE:	
Appointed Surveyor	LKK AUTO CONSULTANTS PTE LTD	
Contact Person	NA	Fax No. 68416315
Contact Number.	NA	

FOR DIRECT SETTLEMENT

Please submit to us the Tax Invoice together with letter of claim for Rental OR Loss of use (based on NIMA Benchmark rates) together with your survey report.

THIRD PARTY SURVEY REQUEST

Cc : Workshop	Z-ONE AUTOMOTIVE PTE LTD	Attention. NIL
Cc : TP Solicitor	CROSSBORDERS LLC	TP Solicitor Fax No. NA
Officer Incharge	KARENT	

IMPORTANT NOTE

Kindly submit the survey report via CWS within 14 days for survey assignment and 7 days for re-inspection.
This is a computer generated letter, no signature required.

Job Sheet (/ClaimWS/Surveyor/JobSheet/231822)



PRI Documents



Close



PRI Header Details

Claim No	D17011472MFSH	Policy No	D-15072701MFSH	Claimant S.No & Name	1 & CROSS BC
Workshop Name	Z-ONE AUTOMOTIVE PTE LTD (Contact Person : YVONNE)	Survey Location & Contact Details	7 SOON LEE STREET ISPACE#01-27/47 S 627608 Mobile: 97552115 , Phone: 62502115 , Fax: 0 EmailId: HUITING@CROSSBORDERSLLC.COM		
Our Surveyor	LKK AUTO CONSULTANTS PTE LTD	Instructions To Surveyor	WITHOUT PREJUDICE:		
Insured Name	COMFORT TRANSPORTATION PTE LTD	Insured Vehicle No	SHA4886J	TP Vehicle No	SGC9457E
PRI Recieved Date	12-12-2017 09:23:07 PM	Surveyor Appointed Date	13-12-2017 02:06:01 PM	Surveyor Accept Date	13-12-2017 0.

Survey Report Upload

Surveyor Inspection Date *:	<input type="text"/>	Surveyor Report Date	13-12-2017	Upload Survey Report *:	<input type="button" value="Choose File"/>
-----------------------------	----------------------	----------------------	------------	-------------------------	--

Vehicle Particulars

Make	<input type="text" value="Please Select Make"/>	Model	<input type="text" value="Please Select Model"/>	Year	<input type="text" value="Select Year"/>
Chasis No	<input type="text"/>	Engine No	<input type="text"/>	Mileage	<input type="text"/>
Color	<input type="text"/>	Cubic Capacity	<input type="text"/>		

Multiple Documents Upload

File Name

Action

Surveyor Job Remarks

Remarks	<input type="text"/>	<input type="button" value="Save"/>
---------	----------------------	-------------------------------------

MSME17163780 / SME Motor Pte Ltd - Kaki Bukit
ENTRY DATE & TIME: 13/12/2017 10:06

SINGAPORE ACCIDENT STATEMENT

IMPORTANT NOTICE

1. Please report correctly the details of the accident to speed up the claims process.
2. This Form must be completed by the Policyholder and/or the Authorised Driver.
3. Information provided must be as truthful and accurate as possible. Any wilful misrepresentation or withholding of material facts may allow insurance companies to repudiate policy ability.
4. The issue and acceptance of this Form by insurance companies is not an admission of policy liability on the part of the insurance companies.
5. Any false reporting may be referred to the Police for investigation.
6. This report will be forwarded by the insurers of the insurers of the GIA Records Management Centre established by the General Insurance Association of Singapore (GIA) for archiving and that copies of this report will for a fee be made available upon application by interested parties.
7. By the lodgement of this report to the insurers, you hereby consent to the archiving of this report at the centre and to copies of the report being made available aforesaid.

ACCIDENT STATEMENT

Date Of Report	13/12/2017 10:06
Date Of Accident	12/12/2017 08:55
Exact Location Of Accident	INTERNATIONAL RD TURNING TO PIONEER RD NORTH
Country/State of Loss	SINGAPORE

DETAILS OF OWN VEHICLE

Vehicle Registration Number	SGC9475E
Insured/Policyholder	
Name Of Registered Owner	TAN CHIN WAH
NRIC No	S1816291A
Email Address	NOEMAIL
Mobile Phone No	(LOCAL) +65-96800734
Alternative Phone No	OFFICE-96800734
Vehicle Particulars	
Manufacturer	NISSAN
Model	LATIO
Exact Purpose for which vehicle was being used at time of accident	
Are you claiming under your own insurance policy for repair to your vehicle?	NO
If No, Please state action to be taken	THIRD PARTY
Vehicle Category	PRIVATE CAR
Insurance Company	
Name of Insurance Company	NTUC INCOME INSURANCE CO-OPERATIVE LTD
Type Of Coverage	COMPREHENSIVE
Fleet Policy	NO
Policy Number	5096320441
Cover Note Number	
Driver	
Name of Driver	TAN CHIN WAH
NRIC No	S1816291A
Date Of Birth	09/01/1967
Occupation	INDOOR
Date Of Driving Pass	23/01/1995
Driving Experience	22 YEARS AND 10 MONTHS
Gender	MALE
Mobile Number	(LOCAL) +65-96800734
Fax Number	
Contact Number	OFFICE-96800734
Email Address	NOEMAIL

Address BLK 673A JURONG WEST ST 65 #13-18
 Postcode 641673
 Was driver an employee of the Insured's Company NO
 If No, Relationship of the Driver with the Insured OWNER
 Vehicle Registration Number of Driver's Own Vehicle -
 -
 Insurance Company of Driver's Own Vehicle -
 -
 -

General Information of the Accident

Type Of Accident COLLISION - HEAD TO REAR
 Weather Conditions CLEAR
 Road Surface DRY

Other Information

Was any foreign vehicle involved in this accident? NO
 Was any body injured in the Accident? YES
 Was any other material or property damaged? YES
 I have been approached by unknown person(s) soliciting/offering accident claims assistance. NO
 Number of Passengers (Including Driver) 2

Details of Police Action

Was the accident reported to the police? YES
 If Yes, Please state which Police Station
 Police Station Name JURONG WEST NEIGHBOURHOOD POLICE CENTRE
 Police Station Address ROAD: 700 CORPORATION ROAD , POSTCODE: 649618 , COUNTRY: SINGAPORE
 Police Station Contact TEL NO: 1800-2689999 - FAX NO: 62672438
 Was notice of intended Prosecution given? NO
 If Yes, against whom?

Circumstances of Accident

REFER TO POLICE REPORT: T/20171212/2040.

Attachment(s)

Are accident photos available for attachment? YES
 Was there any video captured by Car Camera? NO
 Was there any audio recorded? NO

DETAILS OF OTHER VEHICLE PROPERTY 1

Vehicle Registration Number SHA4886J
 Vehicle Make/Model/Colour
 Details Of Properties VEHICLE B
 Name of Driver YEONG KOK KONG
 NRIC/Passport Number
 Contact Number
 Address
 Postcode
 Insurance Company Name
 Nature Of Damage
 No. Of Passenger (Including Driver)

Details of Witness

Name
 Phone Number

Email Address

DETAILS OF INJURED PERSON 1

Name TAN CHIN WAH

Approximate Age

Injuries Sustain

Injured person in which vehicle? SGC9475E

Were seat belts worn?

Was injured conveyed to hospital by ambulance?

Address

Postcode

Sketch Plan Pg. 1

SKETCH PLANIMPORTANT NOTICE

1. Please report correctly the details of the accident to speed up the claims process.
2. This Form must be completed by the Policyholder and/or the Authorised Driver.
3. Information provided must be as truthful and accurate as possible. Any wilful misrepresentation or withholding of material facts may allow insurance companies to repudiate policy liability.
4. The issue and acceptance of this Form by insurance companies is not an admission of policy liability on the part of the insurance companies.
5. Any false reporting may be referred to the Police for investigation.
6. The report will be forwarded by the insurers of the GIA Records Management Centre established by the General Insurance Association of Singapore (GIA) for archiving and that copies of this report will for a fee be made available upon application by interested parties.
7. By the lodgment of this report to the insurers, you hereby consent to the archiving of this report at the centre and to copies of the report being made available aforesaid.
8. Consent under the Personal Data Protection Act (PDPA)

I understand, acknowledge, agree and consent that:

- (a) My insurer, my workshop and the General Insurance Association of Singapore ("GIA") may/are permitted to collect, use, disclose and/or process my personal data/personal information set out in this [form] and any other personal information provided by me or possessed by my insurer (collectively the "Personal Information") and disclose and transfer such Personal Information to all insurer(s) who have insured vehicle(s) involved in this accident (all insurer(s) who have insured vehicle(s) involved in this accident shall be collectively referred to as the "Insurers"), the Insurers' lawyers/law firms, the Monetary Authority of Singapore and any relevant government agency/authority (such as the police), for the purpose(s) of :
 - (i) processing, handling and/or dealing with my claims including the settlement of the claims and any necessary investigations relating to the claims;
 - (ii) investigating the accident and/or my claims;
 - (iii) carrying out and/or dealing with my instructions or responding to any enquiries by me;
 - (iv) administering my claims (including the mailing of correspondence, statements, invoices, reports or notices to me, which could involve disclosure of certain personal data about me to bring about delivery of the same as well as on the external cover of envelopes/mail packages); and/or
 - (v) complying with applicable law in administering, processing, handling and/or dealing with my claims (collectively the "Purposes")
- (b) all insurer(s) who have insured vehicle(s) involved in this accident and the Insurers' lawyers/law firms, may/are permitted to collect, use, disclose and/or process my Personal Information for one or more of the above Purposes; and
- (c) my Personal Information may/can be disclosed by any of the Insurers and/or GIA to their third party service providers or agents (including their lawyers/law firms), which may be sited outside of Singapore, for one or more of the above Purposes.
- (d) my Personal Information will also be collected and used to compile claims history for the purpose of fraud detection, investigation and management in present and all future claims.
- (e) the information so collected under (d) above may be shared / disclosed:
 - (i) to all Insurers and/or any other third parties that assist in evaluating, investigating, controlling or managing fraud, regulators, law enforcement and government agencies as reasonably required for the purposes stated, or
 - (ii) for complying with requirements under any regulations, laws or court orders.

Policyholder's Signature
Date & Time:

Driver's Signature
(If driver is not the policyholder)
Date & Time:

Reporting Centre Personnel's Signature
Name:
NRIC/FIN No.:

SKETCH PLAN

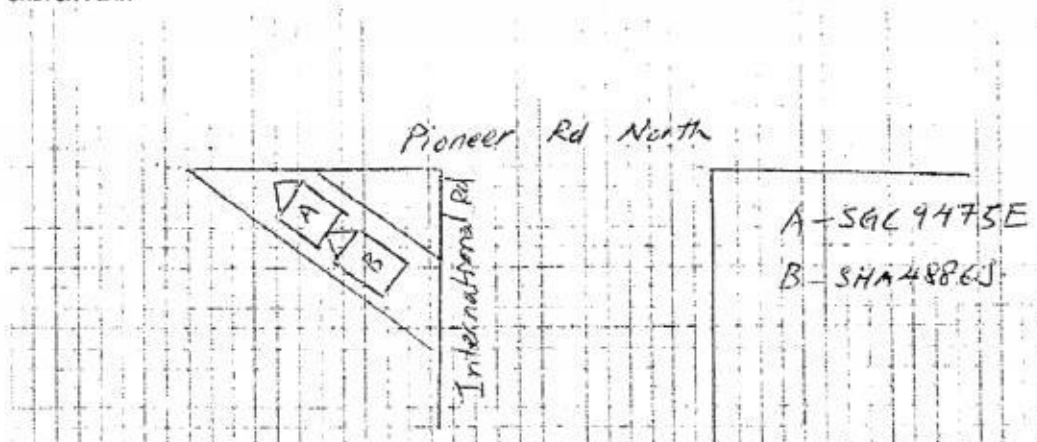

Follow as Police Report

I/We declare the foregoing particulars are true in every respect.

Reporting Centre Personnel's Signature
Name:
NRIC/FIN No.:

Sketch Plan #3 Pg. 1



**SINGAPORE
POLICE FORCE**



T/20171212/2040

1 of 3

Police Station Of Origin:
Jurong West N.P.C
700 Corporation Road SINGAPORE 649818
Tel No: 1800-2689999

Report No. T/20171212/2040

REPORT OF A TRAFFIC ACCIDENT

Date/Time Report Made: 12/12/2017 10:53	Vide Report No.:	Station Diary No.: 30
--	------------------	--------------------------

Informant's Particulars

Name of Informant: TAN CHIN WAH	Address: APT BLK 673A JURONG WEST STREET 65 #13-18 SINGAPORE 641673		
ID Type / ID No.: NRIC NO / S1816291A	Contact No.:	Mobile: 96800734	
Nationality: SINGAPORE CITIZEN	Home/Office:	Email:	
Sex: Male	Age: 50	Date of Birth: 09/01/1967	Type of Informant: Driver
Race: Chinese	Language:	Institution / School Name:	
Occupation: SELF EMPLOYED	Driving Licence Information: Class: 3		Date of Expiry:

General Information of the Accident

General Information of the Accident				
Type of Accident:	Injury Others	Drink Drive: No	Date/Time of Accident: 12/12/2017 08:55	Type of Location: Bend
Location: Along Road 1 Traveling Toward Road 2 INTERNATIONAL ROAD PIONEER ROAD NORTH AT THE SLIP ROAD				
Weather: Clear		Road Surface: Dry	Road Speed Limit:	
Traffic Flow: One Way		Traffic Control: Not Controlled	Traffic Volume: Heavy	
Type of Collision: Between Moving Vehicles - Head To Rear			Anyone conveyed by ambulance: No	

Details of Vehicle Involved

Vehicle No.	Type	Make	Model	Color	Condition	No of Passenger
SGC9475E	Car	NISSAN	LATIO 1.5L A	Black	Seriously Damaged	1
SHA4886J	Car	TOYOTA	PRIUS HYBRID 1.8 CVT	Blue	Slightly Damaged	0

Details of Vehicle Insurance

Vehicle No.	Insurance Company	Insurance No	Effective	Expiry Date
-------------	-------------------	--------------	-----------	-------------

Sketch Plan #4 Pg. 1



**SINGAPORE
POLICE FORCE**



T/20171212/2040

2 of 3

Police Station Of Origin:
Jurong West N.P.C
700 Corporation Road SINGAPORE 649818
Tel No: 1800-2689999

Report No. T/20171212/2040

CONTINUATION OF REPORT

Details of Vehicle Insurance				
Vehicle No.	Insurance Company	Insurance No	Effective	Expiry Date
SGC9475E	NTUC Income Insurance Co-Operative Limited	5096320441	29/11/2017	28/11/2018

Details of Person Involved			
Any Pedestrian Involved: No			
No. of Pedestrians Injured: NIL		Use of Pedestrian Crossing: NA	
Driver			
Name	TAN CHIN WAH	ID No.	S1816291A
Related Vehicle	SGC9475E (Car)	Contact No.	95800734
Hospital/Clinic	NIL	Class of Driving Licence & Expiry Date	Class: 3 Date of Expiry: NIL
Date Treatment	NIL	Date Discharge	NIL
No. of Days granted Medical Leave	NIL	Degree of Injury	NIL
Driver			
Name	YEONG KOK KONG	ID No.	S0002261F
Related Vehicle	SHA4886J (Car)	Contact No.	96217113
Hospital/Clinic	NIL	Class of Driving Licence & Expiry Date	Class: NIL Date of Expiry: NIL
Date Treatment	NIL	Date Discharge	NIL
No. of Days granted Medical Leave	NIL	Degree of Injury	NIL

Brief Details.

On 12/12/2017 at 0853hrs I was driving my vehicle, V1 SGC9475E, towards Pioneer Road North as I was about to merge into pioneer road north, The vehicle which was behind me, V2 SHA4886J hit onto the rear of my vehicle V2. Subsequently, I came out of my vehicle made checks and exchanged particulars with the driver of V2. Due to the accident my vehicle, V1's rear bumper, boot and reverse sensor was badly damaged.

I wish to state that I do not have an in car camera in my vehicle and police and ambulance was not at scene.

Sketch Plan #5 Pg. 1



SINGAPORE
POLICE FORCE



T/20171212/2040

3 of 3

Police Station Of Origin:
Jurong West N.P.C
700 Corporation Road SINGAPORE 649818
Tel No: 1800-2689999

Report No. T/20171212/2040

CONTINUATION OF REPORT

Sketch Plan

Informant is not able to provide sketch plan

IMPORTANT: Please attach a copy of your vehicle's Insurance Certificate to this report. If you don't have the certificate with you now, please fax a copy to 65474885 stating the report number as reference.

Signature Of Officer Recording The Report:

J/

Sgt 2 CHIA SHUN ZHENG

SGT SUNDATAPANDI

Signature Of Interpreter:

Not applicable

Officer In Charge Of Case:

TP / AEIT /

SSI KASMAWATI BTE SAMIAN

Contact No.: 65476179

Authentication Stamp

NP166

Signature Of Informant:

Date/Time:

12/12/2017 10:53

Classification Of Case:

Enquire PARF/COE Rebate for Registered Vehicle

Vehicle Owner Particulars	
Owner ID Type:	Singapore NRIC
Owner ID:	6291A
Vehicle Details	
Vehicle No.:	SGC9475E
Vehicle to be Exported:	No
Intended De-registration Date:	16 Apr 2018
Vehicle Make:	NISSAN
Vehicle Model:	LATIO 1.5L A
Primary Colour:	Black
Manufacturing Year:	2005
Engine No.:	HR15240631
Chassis No.:	SC11039431
Maximum Power Output:	80.0 kW (107 bhp)
Open Market Value:	\$15,164.00
Original Registration Date:	26 Jan 2006
First Registration Date:	26 Jan 2006
Transfer Count:	2
Actual ARF Paid:	\$16,681.00
Intended PARF Rebate Details	
PARF Eligibility:	Forfeited
PARF Eligibility Expiry Date:	-
PARF Rebate Amount:	\$0.00
Intended COE Rebate Details	
COE Expiry Date:	25 Jan 2021
COE Category:	E - Open Category
COE Period(Years):	5
PQP Paid:	\$28,317.00
COE Rebate Amount:	\$15,711.00
Total Rebate Amount:	\$15,711.00
Message	
Please note that the 5-year COE for this vehicle cannot be further renewed. The vehicle must be de-registered upon COE expiry or when the vehicle reaches its statutory lifespan (if applicable), whichever is earlier.	

The information contained herein is correct as at 16 Apr 2018

OK

Nissan Latio Used Vehicle List (17 vehicles)

Car Model	Price	Depreciation	Reg Date	Eng Cap	Mileage	Company	Availability
Nissan Latio 1.5A (COE till 11/2020)	\$20,799	\$8,040 /yr	16-Nov-2005	1,498 cc	22,500 km		Available
Comfortable Car, Well Maintained. Spacious For A 1500cc Car. Easy To Maintain. Fuel Efficient. Bargain Buy! Only Drive To School And Back Home Unless Need To Run Errands. Selling As Going Overseas For...							
Office No. - - Kumar - 90284729							
Nissan Latio 1.5A (COE till 11/2020)	\$20,800	\$8,000 /yr	21-Nov-2005	1,498 cc	150,000 km	Dickson Automobile	Available
Monthly At \$400 Plus Only! 2 Owner Only! Super Low Mileage! Very Affordable! Extended Warranty Available! High Trade In! Well Maintained Responsive Yet Spacious Sedan, A Car You Must Own! Buy It From ...							
Office No. - 68447667 Jez Teo - 90044370 Jonathan Quah - 91901666 Eric Lee - 91827304							
Nissan Latio 1.5A (COE till 02/2026)	\$52,666	\$6,730 /yr	09-Feb-2006	1,498 cc	57,000 km	Platinum Group Pte Ltd	Available
Consignment Unit. High COE, Super Low Genuine Mileage. Extremely Well Maintained By Fussy Owner. Loan And Trade In Available. Call To Enquire Now! Viewing Strictly By Appointment Only.							
Office No. - 69177880 Vincent - 86882400 Gabriel - 90017900 Jackson - 97735487							
Nissan Latio 1.5A (OPC) (COE till 03/2021)	\$24,500	\$8,430 /yr	13-Mar-2006	1,498 cc	93,000 km		Available
1 Careful Owner, 100% Accident Free, No Repairs Required, Excellent Engine Power, Full Use On Saturday And Sunday, Seldom Driven. Pay \$100 Admin Fee To Convert To Normal Car.							
Office No. - - Mr Lim - 96970910							
Nissan Latio 1.5A (COE till 03/2026)	\$58,888	\$7,400 /yr	30-Mar-2006	1,498 cc	120,000 km		Available
Very Good Condition! No Repair Needed! Very Quiet Car. View To Believe!							
Office No. - - Sim - 91135115							
Nissan Latio 1.5A (COE till 07/2021)	\$24,000	\$7,380 /yr	17-Jul-2006	1,498 cc	122,000 km	Carro	Available
Great Condition, Spacious, Comfortable, Reliable And Low Fuel Consumption Japanese Reliability Sedan. Used To Be OPC Car Before COE Renewal. Schedule A Test Drive Today, Viewings Strictly Via Appointm...							
Office No. - 67146652 Jace - 81394200							
Nissan Latio 1.5A (COE till 08/2021)	\$20,800	\$6,160 /yr	06-Sep-2006	1,498 cc	178,000 km	Singapore Mobil Hub Pte Ltd	Available
\$5000 Drive Away With 6 Months Warranty For Gear Box. Very Reliable Yet Economical Mid Size Sedan Ever Built, Great For Beginner Or Family, Call And View Now, Loan And Trade In Welcome!							
Office No. - - David Cheng - 94505007 Marc Chan - 90050606							
Nissan Latio 1.5A Sports (COE till 08/2021)	\$24,838	\$7,350 /yr	07-Sep-2006	1,498 cc	148,000 km	Hoe Beng Auto Trading	Available
\$5k Drive Away! Free 1 Year Car Service! Beautiful Latio 1.5A Sport Model Come With Beautiful Paint, Leather Seats. Non Smoker Unit, Suitable For All Ages! Idea For Grab, No Repair Needed! We Deliver ...							
Office No. - 67450138 / 65523003 Eric - 83538778 Agnes - 93680138							
Nissan Latio 1.5A Sports (COE till 11/2021)	\$22,800	\$6,400 /yr	08-Nov-2006	1,498 cc	70,000 km	Platinum Group Pte Ltd	Available
Consignment Unit. Extremely Well Maintained By Owner. All Wear And Tear Replaced, Superb Condition For Daily Work-Horse With Low Maintenance. Loan And Trade In Available. Call Now To Enquire. Viewing ...							
Office No. - 69177880 Vincent - 86882400 Jackson - 97735487 Gabriel - 90017900							

**LKK Auto Consultants Pte Ltd**

51 Ubi Ave 1 #01-25 Paya Ubi Industrial Park, Singapore 408933

TEL: 6256 3561 FAX: 6256 4315

Reg. No: 199607198R GST Reg. No. 19-9607198-R

Page No.: 1 of 1

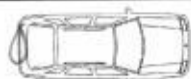
PRE-REPAIR INSPECTION REPORT			
FIRST CAPITAL INSURANCE LTD		Ref: CS3/FCI17023676/T1d3s2	
36 ROBINSON ROAD		Date: 25-04-2018	
#16-01 CITY HOUSESINGAPORE 068877		Code: FCI2	
1. Policy Particulars :- (THIRD PARTY CLAIM)			
Insured Veh.	SHA 4886J	Veh. Inspected	SGC 9475E
Policy No.	D-15072701MFSH	Coverage (\$)	0.00
Claim No.	D17011472MFSH	Excess (\$)	0.00
Assign From	KAREN TAN	Assign Date	13/12/2017
2. Vehicle Particulars & Condition			
Make & Model	NISSAN LATIO	c.c	1498
Engine No.	HIDDEN	Year of Reg.	2006
Chassis No.	SC11039431	Colour	BLACK
Odometer	166576 KM	Steering	IN ORDER
Brakes	IN ORDER	Modification	SPORTS RIM
General	GOOD		
3. Conditions of Tyres			
	Size	Make	Balance
R/H Front Tyre	185/65R15	KUMHO	6 mm
L/H Front Tyre	185/65R15	KUMHO	6 mm
R/H Rear Tyre	185/65R15	KUMHO	6 mm
L/H Rear Tyre	185/65R15	KUMHO	6 mm
4. Description of Damages			
THE VEHICLE SUSTAINED DAMAGES AT THE REAR PORTION.			
5. General Information			
Accident Date	12/12/2017	Inspect Date / Time	13/12/2017 (04:50 PM)
Survey held at	7 SOON LEE STREET ISPACE # 01-27/47, 627608		
Repairer	Z-ONE AUTOMOTIVE PTE LTD		
5a. Remarks			
A) THE INSPECTION WAS CONDUCTED ON A "WITHOUT PREJUDICE" BASIS. B) THE REPAIR ESTIMATE WAS NOT PRESENTED AT THE TIME OF INSPECTION. THE REPAIRER WAS TOLD TO PREPARE THE ESTIMATE. C) ENCLOSED PLEASE FIND DAMAGED VEHICLE PHOTOGRAPHS. D) MARKET VALUE: \$22,000.00			

Report Ref No. CS3/FCI17023676/T1d3s2

Inspected By



MOHAMAD TAUFIKH

M.MATAI, AMSAE-A

Automotive Assessor



K.K.LAU CPT(RET)

BEng(Hons), B.Bus, MBA, PEng, PE, MinstAEA, MASME, MIRTE

REGD Auto Consultant-SAE, Licensed Appraiser

DISCLAIMER OF LIABILITY TO THIRD PARTIES:- This Report is made solely for the use and benefit of the Client named on the front page of this Report.

No liability of responsibility whatsoever, in contract or tort, is accepted to any third party who may rely on the Report wholly or in part. Any third party acting or relying on this Report, in whole or in part, does so at his or her own risk.