

NATIONAL Assessment Centre Services (wef 1 Jan 2005)

Date In: 05/12/17	Job description	Date & Time Completed	Done by
Ref No: NA/LAC/7029073/13	SAS e-filing		
Veh No: SFZ1717B	E-mail (within 8hrs, AIC 2hrs)		
D.O.A: 04/12/17 2100	i-Motor Claim Form		
OD: (TP) Reporting Only	i-Motor W/O (Within: OD 2hrs, TP 4hrs)		
	i-Photo Uploaded		
TP Insurer:	Assessment/Survey Report		
	Ass't Report by Fax / Hand to Owner/Wksp		

Preferred Wksp / INC Assign Wksp / QW: (**TEAMWORK**) Tel: Fax:)

TP Particulars:	Veh No: SGZ7136	INC () / Non-INC ()
Owner / Driver: ()	Tel: ()	
Policy No: ()	Period: ()	Cover Type: ()
Confirmed by: () Date: Time: ()		
Insured/Driver Liability: () % [Note-Est. Status (WO): N: 0-20%; P: 21-79%; F: 80-100%]		
Year of Registration: () Warranty: YES () / NO ()		
Excess: (\$) Loading: \$1,000 () / \$2,000 ()		

General Remarks:-

() Walk-In Customer: Customer's information strictly Confidential & Strictly NO refer of repairer.

() Total Loss Case: to e-mail Insurer URGENTLY.

Drive-In () / Towed-In (); Invoice: YES () / NO (); Towing Co. ()

Remarks:- (INC hotline: 6788 6616)	Date & Time Completed	Done by
1) Apply for Transport Allowance () / Courtesy Car ()		
2) QC Check / Post Repair Inspection ()		
3) Upload Resurvey Photo [Repair Cost > \$3000] ()		

Injury: _____

Date/Time	Actions

	Invoice Preparation Checklist	Amt (\$) 1st Bill	Amt (\$) Add Bill
Claimant's Particulars :-	1) AR: Accident Reporting (\$30);		
Driver/Owner:	2) DA: Damage Assessment (\$100); INC (\$80)		
Contact No:	3) TF: Towing Fee \$40/\$45		
Damaged Portion:	4) FT: Follow-Through Survey \$120		
QC Checked by (Engr-In-Charge):	5) iT: Follow-Through Survey (Resurvey) \$30		
Auditors' Comments :-	For claiming against INC Only (wef 10 Jan 2005)		
Cat. 1:	6) TR: Re-inspection \$75		
Cat. 2/3:	7) N1: Idac DA + SMRT Survey \$160		
	8) NTUC Additional Services:-		
	OD:		
	*N5: Courtesy Car / Tpt Allowance \$5		
	*N6: Repair Co-ordination \$10		
	*N7: Post Repair Inspection \$25		
	*N8: DV / Collect Excess Coordination \$5		
	TP (N11): TP (Non INC) against INC \$20		
	9) N12: Idac Mobile 30		
	Invoice dated	Fee Charged	
	Invoice dated	Fee Charged	

SINGAPORE ACCIDENT STATEMENT

IMPORTANT NOTICE

1. Please report correctly the details of the accident to speed up the claims process.
2. This Form must be completed by the Policyholder and/or the Authorised Driver.
3. Information provided must be as truthful and accurate as possible. Any wilful misrepresentation or withholding of material facts may allow insurance companies to repudiate policy ability.
4. The issue and acceptance of this Form by insurance companies is not an admission of policy liability on the part of the insurance companies.
5. **Any false reporting may be referred to the Police for investigation.**
6. This report will be forwarded by the insurers of the insurers of the GIA Records Management Centre established by the General Insurance Association of Singapore(GIA) for archiving and that copies of this report will for a fee be made available upon application by interested parties.
7. By the lodgement of this report to the insurers, you hereby consent to the archiving of this report at the centre and to copies of the report being made available aforesaid.

ACCIDENT STATEMENT

Date Of Report	05/12/2017 16:25
Date Of Accident	04/12/2017 21:00
Exact Location Of Accident	BEDOK RESERVOIR RD TWDS BLK 151 CARPARK
Country/State of Loss	SINGAPORE

DETAILS OF OWN VEHICLE

Vehicle Registration Number	SFZ1717B
Insured/Policyholder	
Name Of Registered Owner	HARRY TAN JI-KIEN
NRIC No	S8140974I
Email Address	NOEMAIL
Mobile Phone No	(LOCAL) +65-97450139
Alternative Phone No	OTHERS-90107604

Vehicle Particulars

Manufacturer	MERCEDES-BENZ
Model	E250
Exact Purpose for which vehicle was being used at time of accident	PRIVATE USE
Are you claiming under your own insurance policy for repair to your vehicle?	NO
If No, Please state action to be taken	THIRD PARTY
Vehicle Category	PRIVATE CAR

Insurance Company

Name of Insurance Company	LONPAC INSURANCE BHD
Type Of Coverage	COMPREHENSIVE
Fleet Policy	NO
Policy Number	Z17VP05014454
Cover Note Number	

Driver

Name of Driver	HARRY TAN JI-KIEN
NRIC No	S8140974I
Date Of Birth	05/12/1981
Occupation	OUTDOOR
Date Of Driving Pass	24/03/2006
Driving Experience	11 YEARS AND 8 MONTHS
Gender	MALE
Mobile Number	(LOCAL) +65-97450139
Fax Number	
Contact Number	OTHERS-90107604
Email Address	NOEMAIL

Address	BLK 895 TAMPINES ST 81 #10-946
Postcode	520895
Was driver an employee of the Insured's Company	NO
If No, Relationship of the Driver with the Insured	OWNER
Vehicle Registration Number of Driver's Own Vehicle	-
	-
	-
Insurance Company of Driver's Own Vehicle	-
	-
	-

General Information of the Accident

Type Of Accident	SIDE SWIPE
Weather Conditions	CLEAR
Road Surface	DRY

Other Information

Was any foreign vehicle involved in this accident?	NO
Was any body injured in the Accident?	YES
Was any other material or property damaged?	YES
I have been approached by unknown person(s) soliciting/offering accident claims assistance.	NO
Number of Passengers (Including Driver)	1

Details of Police Action

Was the accident reported to the police?	NO
If Yes, Please state which Police Station	
Was notice of intended Prosecution given?	NO
If Yes, against whom?	

Circumstances of Accident

PLOS REFER TO THE ATTACHED STATEMENT.

Attachment(s)

Are accident photos available for attachment?	YES
Was there any video captured by Car Camera?	NO
Was there any audio recorded?	NO

DETAILS OF OTHER VEHICLE PROPERTY 1

Vehicle Registration Number	SGZ713G
Vehicle Make/Model/Colour	
Details Of Properties	
Name of Driver	PEK LIAN TEEK
NRIC/Passport Number	S0208932G
Contact Number	
Address	
Postcode	
Insurance Company Name	
Nature Of Damage	
No. Of Passenger (Including Driver)	

Details of Witness

Name	
Phone Number	
Email Address	

DETAILS OF INJURED PERSON 1

Name	HARRY TAN JI-KIEN
------	-------------------

Approximate Age

Injuries Sustain

BODY

Injured person in which vehicle?

SFZ1717B

Were seat belts worn?

YES

Was injured conveyed to hospital by ambulance?

NO

Address

Postcode

SKETCH PLAN

IMPORTANT NOTICE

1. Please report correctly the details of the accident to speed up the claims process.
2. This Form must be completed by the Policyholder and/or the Authorised Driver.
3. Information provided must be as truthful and accurate as possible. Any willful misrepresentation or withholding of material facts may allow insurance companies to repudiate policy liability.
4. The issue and acceptance of this Form by insurance companies is not an admission of policy liability on the part of the insurance companies.
5. Any false reporting may be referred to the Police for investigation.
6. The report will be forwarded by the Insurers of the GIA Records Management Centre established by the General Insurance Association of Singapore (GIA) for archiving and that copies of this report will for a fee be made available upon application by interested parties.
7. By the lodgment of this report to the Insurers, you hereby consent to the archiving of this report at the centre and to copies of the report being made available aforesaid.
8. Consent under the Personal Data Protection Act (PDPA)

I understand, acknowledge, agree and consent that:

- (a) My insurer, my workshop and the General Insurance Association of Singapore ("GIA") may/are permitted to collect, use, disclose and/or process my personal data/personal information set out in this [form] and any other personal information provided by me or possessed by my insurer (collectively the "Personal Information") and disclose and transfer such Personal Information to all insurer(s) who have insured vehicle(s) involved in this accident (all insurer(s) who have insured vehicle(s) involved in this accident shall be collectively referred to as the "Insurers"), the Insurers' lawyers/law firms, the Monetary Authority of Singapore and any relevant government agency/authority (such as the police), for the purpose(s) of:
 - (i) processing, handling and/or dealing with my claims including the settlement of the claims and any necessary investigations relating to the claims;
 - (ii) investigating the accident and/or my claims;
 - (iii) carrying out and/or dealing with my instructions or responding to any enquiries by me;
 - (iv) administering my claims (including the mailing of correspondence, statements, invoices, reports or notices to me, which could involve disclosure of certain personal data about me to bring about delivery of the same as well as on the external cover of envelopes/mail packages); and/or
 - (v) complying with applicable law in administering, processing, handling and/or dealing with my claims (collectively the "Purposes")
- (b) all insurer(s) who have insured vehicle(s) involved in this accident and the Insurers' lawyers/law firms, may/are permitted to collect, use, disclose and/or process my Personal Information for one or more of the above Purposes; and
- (c) my Personal Information may/can be disclosed by any of the Insurers and/or GIA to their third party service providers or agents (including their lawyers/law firms), which may be sited outside of Singapore, for one or more of the above Purposes.
- (d) my Personal Information will also be collected and used to compile claims history for the purpose of fraud detection, investigation and management in present and all future claims.
- (e) the information so collected under (d) above may be shared / disclosed:
 - (i) to all Insurers and/or any other third parties that assist in evaluating, investigating, controlling or managing fraud, regulators, law enforcement and government agencies as reasonably required for the purposes stated, or
 - (ii) for complying with requirements under any regulations, laws or court orders.

Policyholder's Signature
Date & Time:

Driver's Signature
(If driver is not the policyholder)
Date & Time:

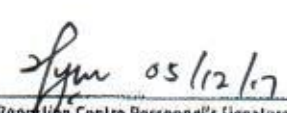
 05/12/17
Reporting Centre Personnel's Signature
Name:
NRIC/FIN No.:

SKETCH PLAN

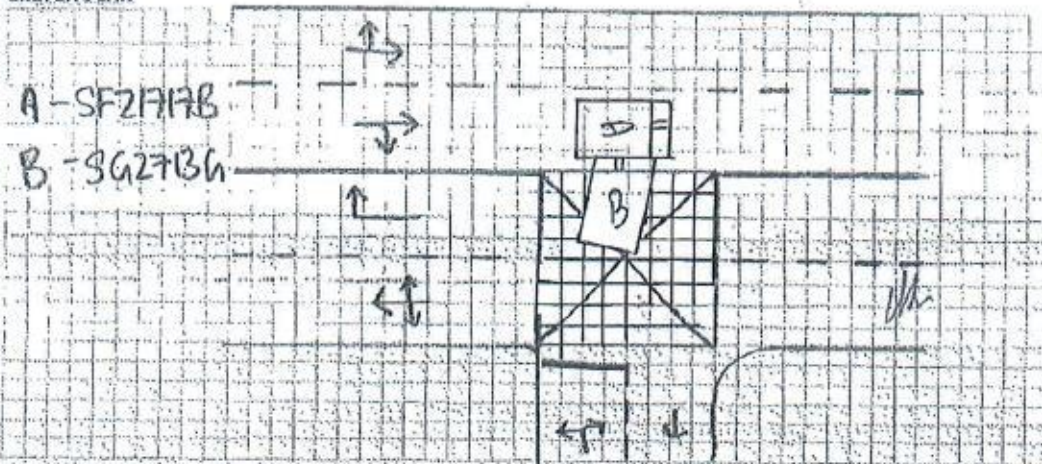

DESCRIBE CIRCUMSTANCES OF THE ACCIDENT

I WAS TRAVELLING STRAIGHT ALONG BEDOK RESERVOIR ROAD. OUT OF SUDDEN, VEHICLE (B) CAME FROM MY RIGHT AND COLLIDED ONTO MY VEHICLE RIGHT SIDE DOOR PORTION. AFTER I GOT DOWN, I THEN REALISED THAT ACTUALLY VEHICLE (B) WAS TURNING OUT FROM THE CARPARK OF BLOCK 151 BEDOK RESERVOIR ROAD INTO THE MAJOR ROAD OF BEDOK RESERVOIR ROAD.

Policyholder's Signature
Date & Time:

Signature of Policyholder

Driver's Signature :
(If driver is not the policyholder)
Date & Time:

Reporting Centre Personnel's Signature
Name:
NRIC/PIN No.:

Signature 05/12/17

SINGAPORE ACCIDENT STATEMENT

IMPORTANT NOTICE

- ❖ Complete and submit this form to the individual insurance authorised reporting centre.
- ❖ Please report correctly on the details of the accident to speed up the claim process.
- ❖ This form must be filled up by the policy holder and/or authorised driver.
- ❖ Information provided must be truthful and accurate as possible. Any willful misrepresentation or withholding of material facts may allow insurance companies to repudiate policy liability.
- ❖ The issue and acceptance of this form by insurance companies is not an admission of policy liability on the part of the insurance companies.
- ❖ Any false reporting may be referred to the traffic police department for investigation.

Accident details

Date and time of accident	Date: 4/12/2017 (DD/MM/YY) Time: 21 00 (HH:MM)
Exact location of accident	Bedok Reservoir Road twds Blk 151 Carpark

Details of vehicle

Vehicle registration number	SFZ177B
Vehicle make and model	Mercedes D50
Type of vehicle	Saloon <input checked="" type="checkbox"/> MPV <input type="checkbox"/> CRV <input type="checkbox"/> Van <input type="checkbox"/> Lorry <input type="checkbox"/> Bus <input type="checkbox"/> Motorcycle <input type="checkbox"/> Others: <input type="checkbox"/>
Vehicle category	Private <input checked="" type="checkbox"/> Commercial <input type="checkbox"/> Motorcycle <input type="checkbox"/>
Purpose of using at said time	
Are you claiming under your own insurance company?	Yes <input type="checkbox"/> No <input checked="" type="checkbox"/> If no, please select: Third party claim <input type="checkbox"/> Reporting only <input type="checkbox"/>

Insurance information

Insurance company	Lon Pac
Policy number	217VPO5014454
Type of policy	Comprehensive <input type="checkbox"/> Third party fire & theft <input type="checkbox"/> TP only <input type="checkbox"/>

Insured / Policy holder

Name	Tan Ji-Kien, Harry	Male <input checked="" type="checkbox"/> Female <input type="checkbox"/>
NRIC / Fin / Passport number	38140974I	
Contact	9745 0139 / 9610 7604 (W, 82)	
Address	APT. Blk 89.5 Tampines Street 81 #10-946 Singapore 520895	

Driver

Same as Insured above ☒ (skip to D.O.B)

Name		Male <input type="checkbox"/> Female <input type="checkbox"/>
NRIC / Fin / Passport number		
Contact		
Address		
Email address		
Date of birth	05/12/1981	
Occupation	Indoor <input type="checkbox"/> Outdoor <input checked="" type="checkbox"/>	
Driving date pass	24/03/2006	

General information of the accident

Was driver an employee of the insured's company?	Yes <input type="checkbox"/> No <input checked="" type="checkbox"/>	If no, relationship of the driver and insured: <u>owner</u> (Inclusive of driver)
No of passenger	1	
Accident captured by camera?	Yes <input type="checkbox"/> No <input checked="" type="checkbox"/>	
Weather condition	Clear <input checked="" type="checkbox"/> Raining <input type="checkbox"/> Others: _____	
Road surface	Dry <input checked="" type="checkbox"/> Wet <input type="checkbox"/>	

Other information

Was anybody injured?	Yes <input checked="" type="checkbox"/> No <input type="checkbox"/>
Was other vehicle damaged?	Yes <input checked="" type="checkbox"/> No <input type="checkbox"/>

Details of police action

Reported to police?	Yes <input type="checkbox"/> No <input checked="" type="checkbox"/> If yes, please state which police station.
Police station name	

Third party vehicle 1

Name	<u>Pek Lian Teck</u>
Contact number	
NRIC / Fin / Passport number	<u>S02089320</u>
Vehicle registration number	<u>SGZ 7130</u>
Vehicle make model	

Third party vehicle 2

Name	
Contact number	
NRIC / Fin / Passport number	
Vehicle registration number	
Vehicle make model	

Third party vehicle 3

Name	
Contact number	
NRIC / Fin / Passport number	
Vehicle registration number	
Vehicle make model	

Third party vehicle 4

Name	
Contact number	
NRIC / Fin / Passport number	
Vehicle registration number	
Vehicle make model	

Witness 1

Name	
------	--

Witness 2

Name	
------	--

Injured person 1

Name	Tan Ji-kien, Harry
Injuries sustained	Body
Which vehicle person in?	SEZ 1717B
Were seat belts worn?	Yes <input checked="" type="checkbox"/> No <input type="checkbox"/>
Was injured conveyed to hospital by ambulance?	Yes <input type="checkbox"/> No <input checked="" type="checkbox"/>

Injured person 2

Name	
Injuries sustained	
Which vehicle person in?	
Were seat belts worn?	Yes <input type="checkbox"/> No <input type="checkbox"/>
Was injured conveyed to hospital by ambulance?	Yes <input type="checkbox"/> No <input type="checkbox"/>

Injured person 3

Name	
Injuries sustained	
Which vehicle person in?	
Were seat belts worn?	Yes <input type="checkbox"/> No <input type="checkbox"/>
Was injured conveyed to hospital by ambulance?	Yes <input type="checkbox"/> No <input type="checkbox"/>

Injured person 4

Name	
Injuries sustained	
Which vehicle person in?	
Were seat belts worn?	Yes <input type="checkbox"/> No <input type="checkbox"/>
Was injured conveyed to hospital by ambulance?	Yes <input type="checkbox"/> No <input type="checkbox"/>

REPUBLIC OF SINGAPORE

Identity Card No. S81409741

Name: TAN JI-KIEN, HARRY (CHEN JIJIAN, HARRY)

Birth Date: 05 Dec 1981

Issue Date: 24 Mar 2006

001408281E

REPUBLIC OF SINGAPORE

IDENTITY CARD NO. S81409741

NAME

TAN JI-KIEN, HARRY (CHEN JIJIAN, HARRY)

陈 继 建

Race: CHINESE

Date of birth: 05-12-1981

Sex: M

Country of birth: SINGAPORE

S81409741

YOU ARE LICENSED TO DRIVE VEHICLES IN THE FOLLOWING CLASS(ES)

1. 300kg with ≤ 7 passengers, exclusive of the driver; and other motor vehicles ≤ 2500 kg

PASS DATE: 24 Mar 2006

NP 428A

Licence No: S81409741

403506

Barcode

NPIC No: S81409741

Fingerprint

Date of issue: 15-03-2012

Address: APT BLK 895 TAMPINES STREET 81 #10-946 SINGAPORE 520895



LONPAC INSURANCE BHD (S98FC5635C)

(Incorporated in Malaysia)

Singapore Office: 300, Beach Road #17-04/07, The Concourse, Singapore 199555.

Tel: (65) 6250 7388 Fax: (65) 6296 3767 Website: www.lonpac.com.sg

GST Reg No.: F0-0005635-C

MXI

CERTIFICATE OF INSURANCE

MOTOR VEHICLES (THIRD PARTY RISKS AND COMPENSATION) ACT (CAP 189) REPUBLIC OF SINGAPORE.
MOTOR VEHICLES (THIRD PARTY RISKS AND COMPENSATION) RULES 1960 (REPUBLIC OF SINGAPORE).
ROAD TRANSPORT ACT 1987 (MALAYSIA).
MOTOR VEHICLES (THIRD PARTY RISKS) RULES, 1959 (MALAYSIA).

Certificate No. : Z17VP05014454

Type of Cover : COMPREHENSIVE

1. Index Mark and Vehicle Registration Number

MERCEDES-BENZ E250 CGI AVANTGARDE 1.8
- SFZ1717B

2. Name of Policy Holder

HARRY TAN JI-KIEN

3. Effective Date of the Commencement of Insurance
for the purpose of the Act

16/07/2017

4. Date of Expiry of the Insurance

15/07/2018

5. Persons or Classes of Persons entitled to drive

(A) THE POLICYHOLDER (B) ANY OTHER PERSON WHO IS DRIVING ON THE POLICYHOLDER'S ORDER OR WITH HIS/HER PERMISSION
Provided that the person driving is permitted in accordance with the licensing or other laws or regulations to drive the Motor Vehicle or has been so permitted and is not disqualified by order of a Court of Law or by reason of any enactment or regulation in that behalf from driving the Motor Vehicle.

6. Limitations as to use

USE ONLY FOR SOCIAL, DOMESTIC AND PLEASURE PURPOSES AND FOR THE POLICYHOLDER'S BUSINESS. THE POLICY DOES NOT
COVER USE FOR HIRE OR REWARD, RACING, PACE-MAKING, RELIABILITY TRIAL, SPEED-TESTING OR THE CARRIAGE OF GOODS
(OTHER THAN SAMPLES) IN CONNECTION WITH ANY TRADE OR BUSINESS OR USED FOR ANY PURPOSE IN CONNECTION WITH THE
MOTOR TRADE.

Excess

: S\$ 0.00 (SECTION 1) INSURED / NAMED DRIVERS
S\$ 1,000.00 (SECTION 1) UNNAMED DRIVERS
S\$ 3,000.00 (SECTION 1) ADDITIONAL EXCESS FOR ELDERLY OR YOUNG AND/OR INEXPERIENCED DRIVERS
S\$ 100.00 WINDSCREEN EXCESS

LONPAC'S AUTHORISED WORKSHOPS

Condition

: ACCIDENT REPAIRS AT LONPAC'S AUTHORISED WORKSHOPS OR DISTRIBUTOR-OWNED MOTOR WORKSHOP

* Limitations rendered inoperative by Section 95 of the Road Transport Act 1987 (Malaysia) or Section 8 of the Motor Vehicles (Third Party Risks and Compensation) Act (Cap 189) Republic of Singapore are not included under heading.

I/WE hereby certify that this covering Note is issued in accordance with the provisions of Part IV of the Road Transport Act 1987 (Malaysia) and Motor Vehicles (Third-Party Risks and Compensation) Act (Cap 189) Republic of Singapore.

H.P. Owner : SINGAPURA FINANCE LTD

CHIEF EXECUTIVE
(Singapore Branch)

User ID: CINDYSIM

Date Issued: 05/07/2017