

22/03/2002

ASS. REC. BY:

REF: CS/MSG17023018/R1qbn2 Special Instruction:

SUPERVISOR

Rasul

ASSIGNMENT (Office)

From (Person):

Jocelyn Ng

of

MSIG

Date/Time: 4/12/17 @ 5:05pm

Estimated Cost:

Bill to:

☒ OD / TP / WS / TP RES / OD RES / EVA / INV / MV / CS

To Inspect Vehicle No:

SCL7752T

Insured:

at Workshop m/s

Volkswagen

Tel: 6305 7216

of

247 Alexandra Road

Policy No: A2899808/AVW

Claim No:

538850

Sum Insured:

Excess:

\$1,500.00

Make of Veh:

D.O.A. 30/11/2017

(Client's Record)

CA / ☒ REV / REP. / REV 24 HRS

H.O.D. Endorsement:

Date/Time:

9:45am 05/12/17

Person Contacted:

Meiy

Vehicle ☒ IN ☐ OUT

Date/Time

Action/Instruction (✓) Estimate

SCL7752T-X

06/12/17 @ 2:22pm revert to Jocelyn Ng via Meimen.

07/12/17 @ 9:41am Keny Ong informed C/A via Meimen.

07/12/17 @ 10:03am Informed Meiy C/A &amp; ex: \$1500 by email.

18/1/18 @ 12:08pm confirmed with Pearllyn final fig \$5938.79, 4 days.

(led to 4769.73, 45%)

Rasul

REF:

11241

## ASSIGNMENT

From: \_\_\_\_\_ Date: \_\_\_\_\_

Estimated Cost: \_\_\_\_\_

OD / TP / WS / TP RES / OD RES / EVA / INV / MV

To inspect Vehicle No: **SCL 7152T**at Workshop this **Volkswagen**of **247, MERSHAK RD**

Insured: \_\_\_\_\_

Policy No: \_\_\_\_\_

Claims No: \_\_\_\_\_

Sum Insured: \_\_\_\_\_ Excess: **1500**

(Client's Record)

Make of Veh: \_\_\_\_\_

(Policy Condition)

Remark: The veh had commenced its repair at the time of inspection.

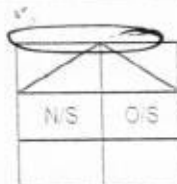
Bal. or Market Value: **146K**

IDAO Accident Report: \_\_\_\_\_ Consistent? : Yes or No

GIA / PR Seen: \_\_\_\_\_ Consistent? : Yes or No

Est. Repairs: **4** days Res: Yes or No

Lum Sum: \_\_\_\_\_ % 3 Val: Yes or No

CA / **REV** / REP. / 24 HRS

Date: \_\_\_\_\_ Person Contacted: \_\_\_\_\_

Vehicle: IN / OUT

Veh No: **SCL 7152T** Vn Regn: **2017 July**Type: **M.Cycle / Bus / Van / Lorry / Taxi / Prime Mover /**

Truck / Trailer or

Make: **Volkswagen PASSAT 1.8A** d.o **1798**Colour: **WHITE** A/C Insured / Std / Nil / NASp. Reading: **5336** T. Radio Insured / Std / Nil / NA

Eng No: \_\_\_\_\_

C.No: **WUW 2223C ZHE 05 0064**Gen. Cond: Good / **Fair** / Poor / BurntSteering: **Order** / Jammed / Leaked / Burnt orBrake: **Order** / Jammed / Leaked / Burnt orMod: Nil / **S/Rim** / STD A/Rim orTyre Size: F: **215/55 R17**R: **215/55 R17**

BS / DUN / EXNOVA / GY / FS / LIZA / MIC / OHTSU / PIR / SUMI /

TOYO / YOKO or **CONTINENTAL**

Front

Rear

R/Bal: **6** mm R/Bal: **6** mmL/Bal: **6** mm L/Bal: **6** mmD.O.A: **30/11/17** D.O.I: **05/12/17**Survey held at: **Volkswagen MERSHAK RD**Des. of Damages: **F7** / Rear / O/S / N/S / U/C / Rooftop or

The U/C / Chassis frame / Body Structure affected due to collision.

Date / Time Action / Instruction

RECEIVED 19 JAN 2018

*[Signature]*  
18/1/2018

Date/Time File Pass to: ☐ : Preli. Report19/1/2018 ☐ : Final Report

Date/Time File Return to: \_\_\_\_\_

Days Of Repair: **4**Resurvey No. of Trip: **1**

Survey Fee

Transporter

300

10

300

10

300

10

Add Fee: ☐Site Insp: ☐Interview: ☐Tech Insp: ☐Witness: ☐Report Format: **MER-0D**Lump Sum / L.Bill: **5938.09**

310



# LKK Auto Consultants Pte Ltd

51 Ubi Ave 1 #01-25 Paya Ubi Industrial Park, Singapore 408933

TEL: 6256 3561 FAX: 6256 4315

Reg. No: 199607198R GST Reg. No. 19-9607198-R

Affiliated to Federation Internationale Des Experts En Automobile				
MSIG INSURANCE (SINGAPORE) PTE LTD			Ref : CS/MSG17023018/R1qb	
16 RAFFLES QUAY #24-01 HONG LEONG BLDG SINGAPORE 048581			Date : 05-12-2017	
			Code : MSG	
<b>1. Policy Particulars :- OWN DAMAGE</b>				
Insured Veh.			Veh. Inspected	SCL 7752T
Policy No.	A28998081AVW		Coverage (\$)	0.00
Claim No.	538850		Excess (\$)	1,500.00
Assign From	MERIMEN (JOCELYN NG)		Assign Date	05/12/2017
<b>2. Vehicle Particulars &amp; Condition</b>				
Make & Model			c.c	0
Engine No.	HIDDEN		Year of Reg.	
Chassis No.			Colour	
Odometer			Steering	
Brakes			Modification	
General				
<b>3. Conditions of Tyres</b>				
	Size	Make	Balance	
R/H Front Tyre			mm	
L/H Front Tyre			mm	
R/H Rear Tyre			mm	
L/H Rear Tyre			mm	
<b>4. Description of Damages</b>				
<b>5. General Information</b>				
Accident Date	30/11/2017		Inspection Date	05/12/2017
Survey held at	VOLKSWAGEN CENTRE SINGAPORE 247 ALEXANDRA ROAD SINGAPORE 159934			
<b>5a. Remarks</b>				
A)THE MARKET VALUE IS S\$------(EST. AVERAGE) B)IN ACCORDANCE TO YOUR INSTRUCTIONS, WE HAVE AUTHORISED REPAIRS.				

# Survey Department Check List (Case Handler)

Reference No: 23/MSG/7073018/2196  
Policy Type: OD/TP/TP RES/TL/EVA

SEL 7752T

Case Handler

Typist

Admin ( Cather ): Case handler to make sure all information created by the assignment team are ACCURATE.

## (1) Office Assign Form

- C Reference No.
- C Customer Code
- N Assign From
- C Assign Date
- C Veh No (Inspected)
- C Veh No (Insured)
- C D.O.A
- C Policy No
- C Claim No
- C Insurance Authorisation (CA/REV/REP)
- C Report Type
- C Weekend Charges
- N Survey held at/Repairer
- C Excess

Y-Date	N-Date	Y-Date	N-Date
<input checked="" type="checkbox"/>	<input checked="" type="checkbox"/>		
<input checked="" type="checkbox"/>	<input checked="" type="checkbox"/>		
<input checked="" type="checkbox"/>	<input checked="" type="checkbox"/>		
<input checked="" type="checkbox"/>	<input checked="" type="checkbox"/>		
<input checked="" type="checkbox"/>	<input checked="" type="checkbox"/>		
<input checked="" type="checkbox"/>	<input checked="" type="checkbox"/>		
<input checked="" type="checkbox"/>	<input checked="" type="checkbox"/>		
<input checked="" type="checkbox"/>	<input checked="" type="checkbox"/>		
<input checked="" type="checkbox"/>	<input checked="" type="checkbox"/>		
<input checked="" type="checkbox"/>	<input checked="" type="checkbox"/>		
<input checked="" type="checkbox"/>	<input checked="" type="checkbox"/>		
<input checked="" type="checkbox"/>	<input checked="" type="checkbox"/>		
<input checked="" type="checkbox"/>	<input checked="" type="checkbox"/>		

Surveyor ( Rasul )

: Case handler to make sure the surveyor completed all required information.

## (1) Assignment Form

- C Vehicle No
- C Regn Month/Year
- N Vehicle Type
- N Make & Model
- C Engine Capacity. (C.C)
- N Colour
- C Odometer. (Sp.Reading)
- C Chassis No
- N General Condition
- N Steering
- N Brake
- N Modification (Modi)
- C Tyre Size
- N Tyre Make
- C Tyre Balance
- C Date of Inspection
- N Survey held
- N Des.of Damages

<input checked="" type="checkbox"/>		
<input checked="" type="checkbox"/>		
<input checked="" type="checkbox"/>		
<input checked="" type="checkbox"/>		
<input checked="" type="checkbox"/>		
<input checked="" type="checkbox"/>		
<input checked="" type="checkbox"/>		
<input checked="" type="checkbox"/>		
<input checked="" type="checkbox"/>		
<input checked="" type="checkbox"/>		
<input checked="" type="checkbox"/>		
<input checked="" type="checkbox"/>		
<input checked="" type="checkbox"/>		
<input checked="" type="checkbox"/>		
<input checked="" type="checkbox"/>		
<input checked="" type="checkbox"/>		
<input checked="" type="checkbox"/>		
<input checked="" type="checkbox"/>		
<input checked="" type="checkbox"/>		

## (2) System - (Views/Merimen)

- C Damaged Vehicle Photographs Uploaded

<input checked="" type="checkbox"/>		
-------------------------------------	--	--

## (3) Workshop Estimate/Assignment Form

- N ALL Parts condition
- C Market Value for OD cases
- C Estimate Repair Cost for PRI (RSI, TMI, MSIG)
- C Days of repair
- C Finalised Amount
- C Re-inspection Cases to Finalize within 5 Days

<input checked="" type="checkbox"/>		
<input checked="" type="checkbox"/>		
<input checked="" type="checkbox"/>		
<input checked="" type="checkbox"/>		
<input checked="" type="checkbox"/>		
<input checked="" type="checkbox"/>		

## (4) System - (Views/Merimen)

- C Resurvey photo Uploaded

<input checked="" type="checkbox"/>		
-------------------------------------	--	--

Check By:

Case Handler

Date

\*C: Critical \*N: Non-Critical

21/05/2014

## ...CLAIM SUBFOLDER...(New Assignment)

### CLAIM SUBFOLDER TRACKING

Case	Notified	Est Submitted	Adj Assigned	Adj Rpt	Adj Submitted	Ins Auth'd	Status
Main	30 Nov 2017		04 Dec 2017 17:05 <a href="#">Assign</a>				<b>New Assignment</b> <a href="#">Cancel Case</a>

Main

Reference

Claim Details

Documents

[Show All](#)

### CLAIM SUBFOLDER DETAILS

[Created by insurer]

Insured:	TOO MENG NGEE, ID: S7211124I, Tel: +6590217404, Email: ahtoobahn@gmail.com		
Vehicle Reg. No.:	SCL7752T	Date of Loss:	30/11/2017 08:00 - :59
Claim Type:	OD / 538850	Policy/Cover Note No.:	A28998081AVW (Comprehensive) Coverage: 31/07/2017 - 30/07/2018
		Excess:	S\$1,500.00
Repairer:	Volkswagen Centre Singapore (Alexandra) 247 Alexandra Road, 159934 Alexandra - Tel: 64748288		
Handling Insurer:	MSIG Insurance (Singapore) Pte. Ltd. (HQ) - Tel: +65 6827 7888 ... [Handled by Jocelyn Ng Shin Bun]		
Adjuster:	LKK Auto Consultants Pte Ltd (HQ) - Tel: 6256-3561 ... [Imm.Advice due 05/12/2017]		
Driver/Custodian:	TOO MENG NGEE (45 / Male), NRIC: S7211124I, Tel: +6590217404		
Adj Asg. Remarks:	Please revert, thank you.		

### ASSOCIATED MAIL RECEIVED

[View All](#)[Compose Case Mail](#)

- MSIG\_SG (04/12/2017): Pls take note. Survey on 05-12-17(Tuesday, Tomorrow) 11am at Alexandra. Owner wa...

### ALL ASSOCIATED TASKS

[View All](#)[Search Tasks](#)[Create New Task](#)[Complete](#)

Due Date	Priority	Type	Task Group	Subject	Handler	Assigned By	Completed On	Created On	Done?
No results.									

## Shiau Chan (LKKAUTO)

---

**From:** Shiau Chan (LKKAUTO)  
**Sent:** Thursday, 18 January 2018 12:08 PM  
**To:** 'Cheong, Pearlyn (VWG Singapore)'; Rasul (LKKAUTO); SUR; Admin A; Admin-D (LKKAUTO)  
**Cc:** Kong, Charmaine (VWG Singapore); Wong, Mei (VWG Singapore); Foo, John (VWG Singapore)  
**Subject:** RE: SCL7752T - FINALISE

Dear Pearlyn,

Confirm final fig \$5,938.29 before excess \$1,500.00 & GST and 4 repair days.

Please send the relevant documents to MSIG insurance company.

Best Regards,

**Shiau Chan (Ms)** | Case Handler

**LKK Auto Consultants Pte Ltd**

Phone: 6256-3561 | email: [siewsc@lkkauto.com](mailto:siewsc@lkkauto.com) | fax: 6256-4315

Blk 51, Paya Ubi Industrial Park, Ubi Avenue 1, #02-25 | S(408933)

---

**From:** Cheong, Pearlyn (VWG Singapore) [mailto:[Pearlyn.cheong@vw.com.sg](mailto:Pearlyn.cheong@vw.com.sg)]  
**Sent:** Friday, 29 December 2017 8:57 AM  
**To:** Rasul (LKKAUTO) <[Rasul@lkkauto.com](mailto:Rasul@lkkauto.com)>; SUR <[sur@lkkauto.com](mailto:sur@lkkauto.com)>; Admin A <[admin-a@lkkauto.com](mailto:admin-a@lkkauto.com)>; Admin-D (LKKAUTO) <[admin-d@lkkauto.com](mailto:admin-d@lkkauto.com)>  
**Cc:** Kong, Charmaine (VWG Singapore) <[charmaine.kong@vw.com.sg](mailto:charmaine.kong@vw.com.sg)>; Wong, Mei (VWG Singapore) <[meiy.wong@vw.com.sg](mailto:meiy.wong@vw.com.sg)>; Foo, John (VWG Singapore) <[John.Foo@vw.com.sg](mailto:John.Foo@vw.com.sg)>  
**Subject:** RE: SCL7752T - FINALISE

Dear Rasul,

FYI

Best regards,

Pearlyn Cheong  
Service Advisor  
Aftersales Body & Paint Department

Volkswagen Group Singapore (Alexandra)  
247 Alexandra Road  
Singapore 159934

Direct line: +65 6305 7288  
Mobile : +65 9236 1336  
Main line: +65 6305 7299  
Main Fax: +65 6474 3643  
[pearlyn.cheong@vw.com.sg](mailto:pearlyn.cheong@vw.com.sg)  
<http://www.vw.com.sg>

## Shiau Chan (LKKAuto)

---

**From:** Shiau Chan (LKKAuto)  
**Sent:** Thursday, 7 December, 2017 10:03 AM  
**To:** Wong, Meiy (VWG Singapore); Tan, William (VWG Singapore); Cheong, Pearlyn (VWG Singapore); Kong, Charmaine (VWG Singapore); Foo, John (VWG Singapore)  
**Cc:** SUR  
**Subject:** VEHICLE 7752T (DOA: 30/11/2017)

Dear Meiy,

As instructed by our client **MSIG Insurance**, please proceed to repair the insured vehicle **SCL 7752T (Excess \$1,500/-)**.

If there are any check items or supplementary items please inform our office's Assignment Team at Tel: 6741 8434 to arrange our surveyor for inspection.

All supplementary items and unconfirm items are subjected to further approval from insurance company before completion of the repair.

\*Our client reserve their right **not to pay** if there is no valid approval obtained before repair.

Best Regards,

**Shiau Chan (Ms)** | Case Handler

**LKK Auto Consultants Pte Ltd**

Phone: 6256-3561 | email: [siewsc@lkkauto.com](mailto:siewsc@lkkauto.com) | fax: 6256-4315

Blk 51, Paya Ubi Industrial Park, Ubi Avenue 1, #02-25 | S(408933)

## Claim Audit

### AUDIT TRAIL

No.	On	Audit	Remarks	By
1	30 Nov 2017 13:45	<b>Clim Veh Model Changed</b>	(201585) VOLKSWAGEN PASSAT 1.8 TSI (B7) (A).	[I] Jocelyn Ng Shin Bun
2	30 Nov 2017 13:45	<b>Clim Created</b>	Reg No: SCL7752T. Policy No: A28998081AVW. Acct Date: 2017/11/30. Claim Type: SC. Insurer: MSIG Insurance (Singapore) Pte. Ltd. (HQ). Ins.Status => Notification. Created from SAS: MVGS17157833-01	[I] Jocelyn Ng Shin Bun
3	01 Dec 2017 11:35	<b>Notification Status Changed</b>	Ins.Status => Incoming Claim	[I] Jocelyn Ng Shin Bun
4	01 Dec 2017 11:35	<b>Clim Registration Modified</b>	Setl.Type:3->0. Rep:1137->200076. Claim Type:SC->OD.	[I] Jocelyn Ng Shin Bun
5	01 Dec 2017 11:36	<b>Adj Co Assigned</b>	MSIG Insurance (Singapore) Pte. Ltd. (Internal Surveyor):PLEASE PROCEED (A IF C)	[I] Jocelyn Ng Shin Bun
6	01 Dec 2017 11:36	<b>Adj Next Rpt Changed</b>	Next Rpt:Im. Advice.Due Date:2017/12/02	[I] Jocelyn Ng Shin Bun
7	01 Dec 2017 11:36	<b>Adj Mandate Set</b>	Approved:25000.00.Reinsp:Adj decides.	[I] Jocelyn Ng Shin Bun
8	01 Dec 2017 14:18	<b>Assignment 1st Accessed</b>		[A] Ho Pei Fang
9	04 Dec 2017 17:04	<b>Adj Assignment Cancelled</b>	Survey on 05-12-17(Tuesday, Tomorrow) 11am at Alexandra. Owner waiting. IHS unable to attend (IHS Appt full)	[I] Jocelyn Ng Shin Bun
10	04 Dec 2017 17:04	<b>Adj Est Details Deleted</b>	Deleting Est Details For Cancelling Adjuster Assignment	[I] Jocelyn Ng Shin Bun
11	04 Dec 2017 17:05	<b>Adj Co Assigned</b>	LKK Auto Consultants Pte Ltd (HQ):Please revert, thank you.	[I] Jocelyn Ng Shin Bun
12	04 Dec 2017 17:05	<b>Adj Next Rpt Changed</b>	Next Rpt:Im. Advice.Due Date:2017/12/05	[I] Jocelyn Ng Shin Bun
13	04 Dec 2017 17:05	<b>Adj Mandate Set</b>	Approved:25000.00.Reinsp:Adj decides.	[I] Jocelyn Ng Shin Bun
14	04 Dec 2017 17:05	<b>Assignment 1st Accessed</b>		[A] CATHERINE CHONG KAI LING
15	05 Dec 2017 13:19	<b>Adj Adjuster Assigned</b>	[None] -> MOHD RASUL	[A] CATHERINE CHONG KAI LING
16	06 Dec 2017 14:10	<b>Adj Rpt Initiated</b>		[A] SHIAU CHAN
17	06 Dec 2017 14:14	<b>Adj Im. Advice Submitted</b>	Next Rpt:Final Rpt.Due Date:2018/01/03	[A] SHIAU CHAN
18	06 Dec 2017 14:14	<b>Adj Next Rpt Changed</b>	Next Rpt:Final Rpt.Due Date:2018/01/03	[A] SHIAU CHAN
19	06 Dec 2017 14:22	<b>Adj Mandate Request</b>	Cur.Req:8758.02:DAMAGES CONSISTENT. REPAIR COST ECONOMICAL. WE HAVE NOT AUTHORISE REPAIR.	[A] SHIAU CHAN
20	07 Dec 2017 09:41	<b>Adj Next Rpt Changed</b>	Next Rpt:Final Rpt.Due Date:2018/01/03. Mandate Remarks: a if c	[I] Keny Ong Thiam Beng
21	07 Dec 2017 09:41	<b>Adj Mandate Set</b>	Approved:6837.10:a if c	[I] Keny Ong Thiam Beng

### ACTIVITY

[04/12/2017 16:58] Pauline Soh Li Ping:  
Mely confirmed survey on 05-12-17(Tuesday, Tomorrow) 11am at Alexandra. Owner waiting. IHS unable to attend (IHS Appt full)  
[01/12/2017 14:19] Ho Pei Fang:  
Pending for workshop to arrange survey appt.

### Merimen Billing for this case - Transaction History

Bill Ref No	Bill Date	Acc Type	Acc Name	Co Name (Branch)	Ref 1	Ref 2	Amount
1659484	06/12/2017 14:10	Motor	LKK Auto Consultants Pte Ltd	LKK Auto Consultants Pte Ltd (HQ)	SCL7752T		10.70

**Note: This document has not been finalised.****LKK Auto Consultants Pte Ltd** (Co.Reg.No:199607198R)

51 Ubi Ave 1 #01-25, Paya Ubi Industrial Park

Singapore 408933

Tel: 6256-3561 Fax: 6844-8805 Email: sur@lkkauto.com;assignments@lkkauto.com

To: MSIG Insurance (Singapore) Pte. Ltd.  
4 Shenton Way  
#21-01 SGX Centre 2  
Singapore 068807

From: LKK Auto Consultants Pte Ltd  
51 Ubi Ave 1 #01-25  
Paya Ubi Industrial Park  
Singapore 408933

Attn: Jocelyn Ng Shin Bun

Date: 06 Dec 2017

**Preliminary Advice**

Vehicle No	: SCL7752T	Accident Date	: 30/11/2017
Make	: VOLKSWAGEN PASSAT	Policy No.	: A28998081AVW
Assignment Date	: 04/12/2017	Excess	: S\$1,500.00
Date of Inspection	: 05/12/2017	Est. Duration of Repair	: 5.00
Inspection At	: VOLKSWAGEN CENTRE SINGAPORE (ALEXANDRA) 247 ALEXANDRA ROAD SINGAPORE 159934		

**Point of Impact / General Description of Damages**

The vehicle sustained impact / damages front portion and parts claimed are consistent to the accident.

Repairer's Estimate (Gross)	:S\$	10,708.02
Revised Amount	:S\$	6,837.10
Check Items (Estimated)	:S\$	1,920.92
Total	:S\$	8,758.02

Lump Sum Repair	:S\$	
-----------------	------	--

**Total Loss Consideration**

New for Old Value	:S\$	
Pre-Accident Value	:S\$	146,000.00
COE / PARF Rebate	:S\$	71,424.00
Salvage Value	:S\$	
Margin for Repair	:S\$	74,576.00

**Remarks**

( X ) The vehicle is economical for repair.

( X ) The above survey was conducted on a 'without prejudice' basis. WE HAVE NOT AUTHORISE REPAIR.

## Enquire PARF/COE Rebate for Registered Vehicle

<b>Vehicle Owner Particulars</b>	
Owner ID Type	Singapore NRIC
Owner ID	1124I
<b>Vehicle Details</b>	
Vehicle No.	SCL7752T
Vehicle to be Exported	No
Intended De-registration Date	06 Dec 2017
Vehicle Make	VOLKSWAGEN
Vehicle Model	PASSAT B8 1.8 TFSI AT SR NAV 17W 3G24JZ
Primary Colour	White
Manufacturing Year	2016
Engine No.	CJS177255
Chassis No.	WVWZZZ3CZHE050064
Maximum Power Output	132.0 kW (177 bhp)
Open Market Value	\$31,366.00
Original Registration Date	31 Jul 2017
First Registration Date	31 Jul 2017
Transfer Count	0
Actual ARF Paid	\$30,913.00
<b>Intended PARF Rebate Details</b>	
PARF Eligibility	Yes
PARF Eligibility Expiry Date	30 Jul 2027
PARF Rebate Amount	\$23,184.00
<b>Intended COE Rebate Details</b>	
COE Expiry Date	30 Jul 2027
COE Category	B - Car above 1600cc or 97kW (130bhp)
COE Period(Years)	10
QP Paid	\$50,001.00
COE Rebate Amount	\$48,240.00
<b>Total Rebate Amount</b>	<b>\$71,424.00</b>

The information contained herein is correct as at 06 Dec 2017

OK

146,000  
71,424  
74,576



Please read through the [Privacy Statement](#), [Terms of Use](#), and [Disclaimer](#).

Please do not use the Back or Forward buttons on your browser as this may alter the results of the transactions.

Best viewed with IE 10 and above, Chrome, Firefox, and Safari.

Copyright 2017 LTA [Privacy Statement](#) [Terms of Use](#) [Disclaimer](#) [Rate the Website](#) [Rate this e-Service](#)

Last updated on 19 Nov 2017 at 12:12 AM

## SINGAPORE ACCIDENT STATEMENT

### IMPORTANT NOTICE

1. Please report correctly the details of the accident to speed up the claims process.
2. This Form must be completed by the Policyholder and/or the Authorised Driver.
3. Information provided must be as truthful and accurate as possible. Any wilful misrepresentation or withholding of material facts may allow insurance companies to repudiate policy ability.
4. The issue and acceptance of this Form by insurance companies is not an admission of policy liability on the part of the insurance companies.
5. Any false reporting may be referred to the Police for investigation.
6. This report will be forwarded by the insurers of the insurers of the GIA Records Management Centre established by the General Insurance Association of Singapore (GIA) for archiving and that copies of this report will for a fee be made available upon application by interested parties.
7. By the lodgement of this report to the insurers, you hereby consent to the archiving of this report at the centre and to copies of the report being made available aforesaid.

### ACCIDENT STATEMENT

Date Of Report	30/11/2017 08:33
Date Of Accident	30/11/2017 08:00
Exact Location Of Accident	PIE TOWARDS TUAS AT EUNOS SIDE
Country/State of Loss	SINGAPORE

### DETAILS OF OWN VEHICLE

Vehicle Registration Number	SCL7752T
<b>Insured/Policyholder</b>	
Name Of Registered Owner	TOO MENG NGEE
NRIC No	S7211124I
Email Address	AHTOOBAHN@GMAIL.COM
Mobile Phone No	(LOCAL) +65-90217404
Alternative Phone No	OTHERS-90217404

### Vehicle Particulars

Manufacturer	VOLKSWAGEN
Model	PASSAT 1.8 TSI HIGHLINE17IN
Exact Purpose for which vehicle was being used at time of accident	
Are you claiming under your own insurance policy for repair to your vehicle?	YES
If No, Please state action to be taken	
Vehicle Category	PRIVATE CAR

### Insurance Company

Name of Insurance Company	MSIG INSURANCE (SINGAPORE) PTE. LTD.
Type Of Coverage	COMPREHENSIVE
Fleet Policy	NO
Policy Number	A 28998081 AVW
Cover Note Number	

### Driver

Name of Driver	TOO MENG NGEE
NRIC No	S7211124I
Date Of Birth	29/03/1972
Occupation	INDOOR
Date Of Driving Pass	04/08/1993
Driving Experience	24 YEARS AND 3 MONTHS
Gender	MALE
Mobile Number	(LOCAL) +65-90217404
Fax Number	
Contact Number	OTHERS-90217404
Email Address	AHTOOBAHN@GMAIL.COM

Address	11 BEDOK RESERVOIR VIEW #03-04
Postcode	478931
Was driver an employee of the Insured's Company	NO
If No, Relationship of the Driver with the Insured	OWNER
Vehicle Registration Number of Driver's Own Vehicle	-
	-
	-
Insurance Company of Driver's Own Vehicle	-
	-
	-

#### General Information of the Accident

Type Of Accident	COLLISION - HEAD TO REAR
Weather Conditions	CLEAR
Road Surface	DRY

#### Other Information

Was any foreign vehicle involved in this accident?	NO
Was any body injured in the Accident?	NO
Was any other material or property damaged?	YES
I have been approached by unknown person(s) soliciting/offering accident claims assistance.	NO
Number of Passengers (Including Driver)	1

#### Details of Police Action

Was the accident reported to the police?	NO
If Yes, Please state which Police Station	
Was notice of intended Prosecution given?	NO
If Yes, against whom?	

#### Circumstances of Accident

#### Attachment(s)

Are accident photos available for attachment?	YES
Was there any video captured by Car Camera?	YES
Remarks/ Reasons:	NOT DOWNLOADED YET
Was there any audio recorded?	NO

#### DETAILS OF OTHER VEHICLE PROPERTY 1

Vehicle Registration Number	SJP7889D
Vehicle Make/Model/Colour	
Details Of Properties	
Name of Driver	EUNICE
NRIC/Passport Number	
Contact Number	90706263
Address	
Postcode	
Insurance Company Name	
Nature Of Damage	
No. Of Passenger (Including Driver)	

#### Details of Witness

Name	
Phone Number	
Email Address	

#### DETAILS OF OTHER VEHICLE PROPERTY 2

Vehicle Registration Number	UNKNOWN
-----------------------------	---------

Vehicle Make/Model/Colour

VAN

Details Of Properties

Name of Driver

NRIC/Passport Number

Contact Number

Address

Postcode

Insurance Company Name

Nature Of Damage

No. Of Passenger (Including Driver)

**Details of Witness**

Name

Phone Number

Email Address

# Sketch Plan Pg. 1

## SKETCH PLAN

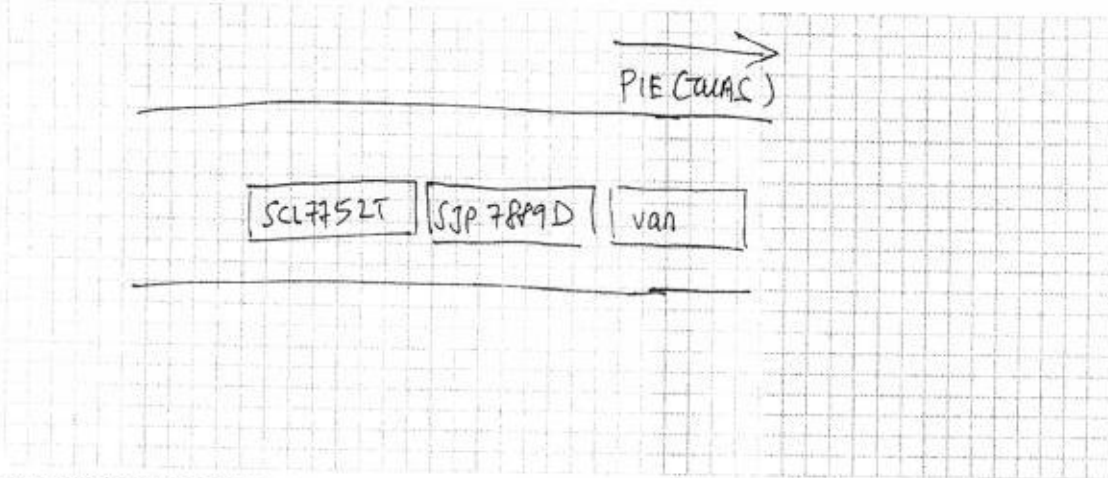

## DESCRIBE CIRCUMSTANCES OF THE ACCIDENT

On 30 Nov around 8:00am, along PIE (Tuar) around Ender area, my vehicle SCL7752T hit the rear of vehicle SJP 7889D. ~~SJP 7889D~~.

SJP 7889D driver is Ms Eunice (90706263).

There is another van in front of SJP 7889D, but I did not take note of the van's details.

## DECLARATION

I/We declare the foregoing particulars are true in every respect.

Policyholder's Signature  
Date & Time: 30/11/2017 8:00am

Driver's Signature  
(If driver is not the policyholder)  
Date & Time:

Reporting Centre Personnel's Signature  
Name:  
NRIC/FIN No.:

**SKETCH PLAN**

**IMPORTANT NOTICE**

1. Please report correctly the details of the accident to speed up the claims process.
2. This Form must be completed by the Policyholder and/or the Authorised Driver.
3. Information provided must be as truthful and accurate as possible. Any wilful misrepresentation or withholding of material facts may allow insurance companies to repudiate policy liability.
4. The issue and acceptance of this Form by insurance companies is not an admission of policy liability on the part of the insurance companies.
5. Any false reporting may be referred to the Police for investigation.
6. The report will be forwarded by the insurers of the GIA Records Management Centre established by the General Insurance Association of Singapore (GIA) for archiving and that copies of this report will for a fee be made available upon application by interested parties.
7. By the lodgment of this report to the insurers, you hereby consent to the archiving of this report at the centre and to copies of the report being made available aforesaid.
8. **Consent under the Personal Data Protection Act (PDPA)**

I understand, acknowledge, agree and consent that:

- (a) My insurer, my workshop and the General Insurance Association of Singapore ("GIA") may/are permitted to collect, use, disclose and/or process my personal data/personal information set out in this [form] and any other personal information provided by me or possessed by my insurer (collectively the "Personal Information") and disclose and transfer such Personal Information to all insurer(s) who have insured vehicle(s) involved in this accident (all insurer(s) who have insured vehicle(s) involved in this accident shall be collectively referred to as the "Insurers"), the Insurers' lawyers/law firms, the Monetary Authority of Singapore and any relevant government agency/authority (such as the police), for the purpose(s) of:
  - (i) processing, handling and/or dealing with my claims including the settlement of the claims and any necessary investigations relating to the claims;
  - (ii) investigating the accident and/or my claims;
  - (iii) carrying out and/or dealing with my instructions or responding to any enquiries by me;
  - (iv) administering my claims (including the mailing of correspondence, statements, invoices, reports or notices to me, which could involve disclosure of certain personal data about me to bring about delivery of the same as well as on the external cover of envelopes/mail packages); and/or
  - (v) complying with applicable law in administering, processing, handling and/or dealing with my claims. (collectively the "Purposes")
- (b) all insurer(s) who have insured vehicle(s) involved in this accident and the Insurers' lawyers/law firms, may/are permitted to collect, use, disclose and/or process my Personal Information for one or more of the above Purposes; and
- (c) my Personal Information may/can be disclosed by any of the Insurers and/or GIA to their third party service providers or agents (including their lawyers/law firms), which may be sited outside of Singapore, for one or more of the above Purposes.
- (d) my Personal Information will also be collected and used to compile claims history for the purpose of fraud detection, investigation and management in present and all future claims.
- (e) the information so collected under (d) above may be shared / disclosed:
  - (i) to all insurers and/or any other third parties that assist in evaluating, investigating, controlling or managing fraud, regulators, law enforcement and government agencies as reasonably required for the purposes stated, or
  - (ii) for complying with requirements under any regulations, laws or court orders.

Policyholder's Signature

Date & Time: 30/11/2017 8:30am

Driver's Signature

(If driver is not the policyholder)  
Date & Time:

Reporting Centre Personnel's Signature

Name:

NRIC/FIN No.:

30 NOV 2017

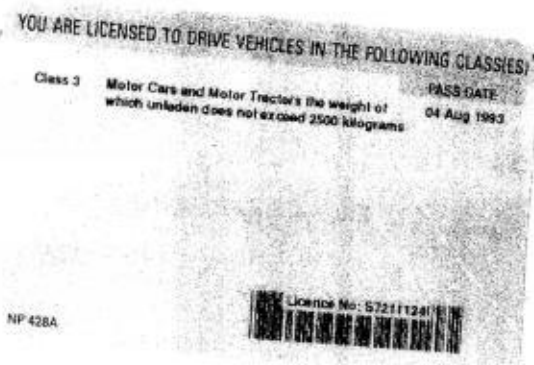

**MSIG**

MSIG Insurance (Singapore) Pte. Ltd.  
 4 Shenton Way, # 21-01, SGX Centre 2, Singapore 071507  
 Tel: +65 6827 7888, Fax: +65 6827 7800  
 Co. Reg. No. M0412212G GST Reg. No. 20-0411170

## Certificate of Insurance

ROAD TRANSPORT ACT 1987 (MALAYSIA)  
 THE MOTOR VEHICLES (THIRD-PARTY RISKS) RULES, 1969 (FEDERATION OF MALAYSIA)  
 THE MOTOR VEHICLES (THIRD-PARTY RISKS AND COMPENSATION) ACT (CAP. 189 OF THE REVISED EDITION)  
 (REPUBLIC OF SINGAPORE)  
 THE MOTOR VEHICLES (THIRD-PARTY RISK AND COMPENSATION) RULES, 1996 EDITION (REPUBLIC OF SINGAPORE)  
 OR ANY AMENDMENT, ACT OR ACTS PASSED IN SUBSTITUTION THEREOF.

Form M.X.1  
 Individual Ownership

VW DRIVEEASY  
 Comprehensive

Certificate No. A 28998081 AVW

Excess: SGD1,500  
 Windscreen Excess: SGD100

1. **Index Mark and Registration Number of Vehicle**  
 SCL7752T
2. **Name of Policyholder**  
 Too Meng Ngee
3. **Effective Date of the Commencement of Insurance for the purposes of the Act**  
 31/07/2017
4. **Date of Expiry of Insurance**  
 30/07/2018
5. **Persons or Classes of Persons entitled to drive\***  
 Too Meng Ngee  
 Any other person provided he is driving on the Policyholder's order or with the Policyholder's permission.  
 \* Provided that the person driving is permitted in accordance with the licensing or other laws or laws or regulations to drive the Motor Vehicle or has been so permitted and is not disqualified by order of a Court of Law or by reason of any enactment or regulation in that behalf from driving the Motor Vehicle.
6. **Limitations as to use\***  
 Use only for social domestic and pleasure purposes and for the Policyholder's business.  
 The Policy does not cover use for hire or reward racing pace-making reliability trial speed-testing the carriage of goods other than samples in connection with any trade or business or use for any purpose in connection with the Motor Trade.  
 \* Limitations rendered inoperative by Section 8 of the Motor Vehicles (Third-Party Risks and Compensation) Act (Chapter 189) and Section 95 of the Road Transport Act, 1987 (Malaysia), are not to be included under these headings.

**PLEASE NOTE ALL CLAIMS RELATED REPAIR MUST BE CARRIED OUT AT VOLKSWAGEN CENTRE SINGAPORE.**

This Certificate is not transferable to a new owner of the vehicle. If for any reason the Policy is terminated during its currency, the Certificate must be returned to the Insurer within 7 days of the termination or if the Certificate has been lost or destroyed, a Statutory Declaration to that effect must be made. Failure to comply with this obligation is an offence under the Motor Vehicles (Third-Party Risks and Compensation) Act (Cap. 189).

I/WE HEREBY CERTIFY that the Policy to which this Certificate relates is issued in accordance with the provisions of the Motor Vehicles (Third-Party Risks and Compensation) Act (Chapter 189) and Part IV of the Road Transport Act, 1987 (Malaysia) or any Amendment, Act or Acts passed in substitution thereof.

MSIG Insurance (Singapore) Pte. Ltd.  
 Approved Insurers

  
 for Chief Executive Officer

Accident Photo



Accident Photo



Accident Photo

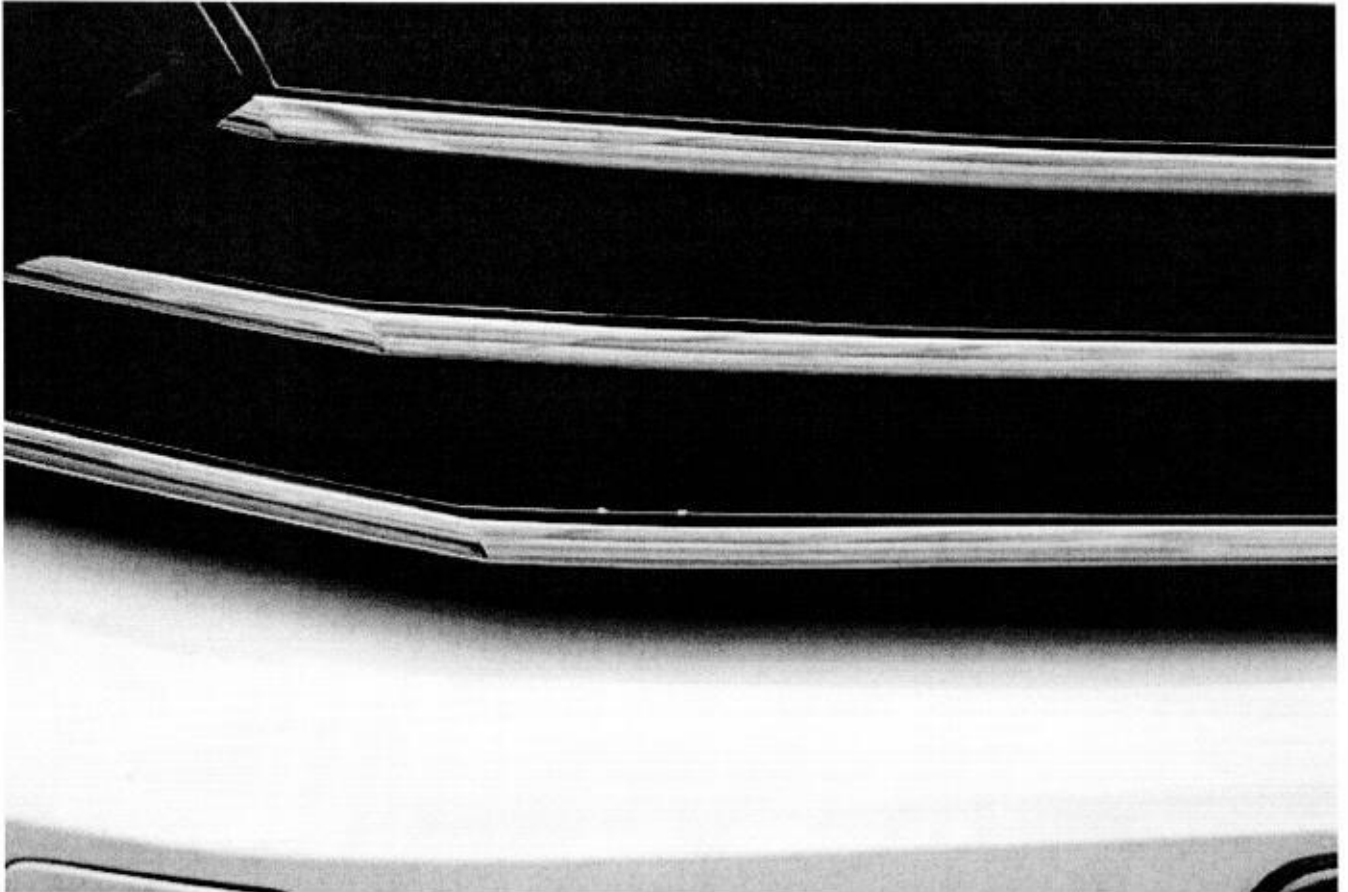

Accident Photo



Accident Photo



# Addendum Sheet Pg. 1



GENERAL INSURANCE ASSOCIATION OF SINGAPORE RECORDS MANAGEMENT CENTRE  
6 Raffles Quay #18-00 Singapore 048580  
Tel (65) 6224 0010 Fax (65) 6224 0030  
Operating Hours : Monday to Friday, 09:00 - 17:00  
UEN: S665500206 / GST Reg. No.: M400017735

**IMPORTANT NOTE:** Please submit the completed Addendum form to the same Authorised Reporting Centre with whom you submitted the Original Report.

## ADDENDUM

### (A) PARTICULARS OF PERSON MAKING THE AMENDMENTS:

Original Report No : \_\_\_\_\_ Vehicle Registration No: SEL 7752T  
Name(as shown in NRIC) : TOO MENG NGEE NRIC/FIN/Passport No : \_\_\_\_\_  
(\*Vehicle Driver / Vehicle Owner) (\*) Please delete as appropriate  
Address : \_\_\_\_\_ Singapore( )  
Contact (Tel) : \_\_\_\_\_ Mobile No. : \_\_\_\_\_  
Email Address : \_\_\_\_\_  
Date of Accident : \_\_\_\_\_ Time of Accident : \_\_\_\_\_  
Place of Accident : \_\_\_\_\_  
Insurance Company: M&I

### (B) ADDITIONAL INFORMATION / AMENDMENTS:

I have made a report on the above mentioned accident and would like to include additional information or make the following amendments:

VEHICLE No: SEL 7752T - TYPO ERROR -

---

---

---

---

---

---

---

---

---

---



Policyholder / Driver's Signature  
Date:

Reporting Centre Person's Signature  
Name:  
NRIC/FIN No.:  
Date:

MSB Linnay  
 OD email: 30/11/17

PDI TUAS

PDI TUAS

TOO MENG NGEE  
 (ZHU MINYI)  
 11 BEDOK RESERVOIR VIEW  
 #03-04  
 Singapore, 478931  
 Singapore

@ 90217404  
 TWS - 04/12/17 - 11am

Phone No.  
 Fax No.  
 E-Mail

VAT Registration No. M20098505-2  
 Tax No. 199101494Z

## Service Quote

Customer No. CV009616  
 Quote No. SER/QUO/1701996  
 QuoteDate 30/11/17  
 Salesperson Daniel Wee  
 Page 1

THIS IS NOT AN OFFICIAL TAX INVOICE

Make	Model Description	Mileage	Service Advisor
Volkswagen Passeng	Passat 1.8 TSI Highline17in	782	Kong Charmaine
License No.	VIN	Initial Registration	Sales Advisor
SCL7752T	WVWZZZ3CZHE050064	31/07/17	Daniel Wee
Engine Code	Labor Type	Engine No.	Model Code
	1P	CJS 177255	3G24JZ

No.	Description	Qty.	UoM	Unit Price	Amount
P B&P ALEX LABOUR	LABOUR	4	UNIT		950 <del>1,000.00</del>
P B&P ALEX PAINT	SPRAY PAINT	4	UNIT		1000 <del>2,000.00</del>
P B&P NUMBER PLATE	B&P NUMBER PLATE -NETT	1	pcs		80.00
P B&P DIAG	PROGRAMMING & CALIBRATION COMPULSORY TO DO AFTER AC	1	Time Un		360.00
P B&P MECH	ELECT WIRING & MECH COMPO	1	Time Un		200.00
	Nett				
	Sum Labor				4,540.00
P 3G0805903E 9B9	FRT LOWER SPOILER	1	Pieces		255.18
P 3G0807049	BUMPER BRACKET LH	1	Pieces		53.70
P 3G0807050	BUMPER BRACKET RH	1	Pieces		52.98
P 3G0807109F	BEAM	1	Pieces		652.72
P 3G0807177	BUMPER GUIDE LH	1	Pieces		91.95
P 3G0807178	BUMPER GUIDE RH	1	Pieces		91.95
P 3G0807217K GRU	FRT BUMPER COVER	1	Pieces		1,668.15
P 3G0807251	FOAM INSERT	1	Pieces		152.68
P 3G0807287 9B9	NUMBER PLATE BASE PLATE	1	Pieces		96.67
P 3G0807651B	MEMBER	1	Pieces		176.49
P 3G0807889	BUMPER CENTRE BRACKET	1	Pieces		117.04
P 3G0823031A	BONET HOOD	1	Pieces		945.97
P 3G0853245 2ZZ	CHROME MOLDING CENTER	1	Pieces		208.33
P 3G0853254 2ZZ	RHS CHROME MOLDING	1	Pieces		121.25
P 3G0853601B DPJ	VW SIGN-FRT GRILLE	1	Pieces		91.84
P 3G0853651A BKZ	Use Predecessor 3G0853601B JZ GRILLE	1	Pieces		749.16
Sum carried forward					10,066.06

Payments to: - BBN: - Acc.-No.:

## PDI TUAS

PDI TUAS

TOO MENG NGEE  
(ZHU MINYI)  
11 BEDOK RESERVOIR VIEW  
#03-04  
Singapore, 478931  
Singapore

Phone No.  
Fax No.  
E-Mail

VAT Registration No. M20098505-2  
Tax No. 199101494Z

## Service Quote

Customer No. CV009616  
Quote No. SER/QUO/1701996  
QuoteDate 30/11/17  
Salesperson Daniel Wee  
Page 2

THIS IS NOT AN OFFICIAL TAX INVOICE

Make	Model Description	Mileage	Service Advisor
Volkswagen Passeng	Passat 1.8 TSI Highline17in	782	Kong Charmaine
License No.	VIN	Initial Registration	Sales Advisor
SCL7752T	WVWZZZ3CZHE050064	31/07/17	Daniel Wee
Engine Code	Labor Type	Engine No.	Model Code
	1P	CJS 177255	3G24JZ

Continued			10,066.06
P 3G0853671 9B9	CENTER VENT GRILLE	1 Pieces	134.70 <sup>CAS?</sup> 187.08 ✓
P 3G0854322 9B9	CHROME COVERSTRIP RHS	1 Pieces	69.92 <sup>cut</sup> 97.11 ✓
P 3G0854662 9B9	GRILLE RHS	1 Pieces	71.41 <sup>CAS?</sup> 99.16 ✓
P 3G0998493	SENSOR BRACKET SET	1 Pieces	58.17 <sup>new</sup> 80.79 ✓
P D 180KU2A1	2KADHESIVE	1 Pieces	74.64 <sup>new</sup> 103.66 ✓
P D 822150A1	BONDAGENT	1 Pieces	53.40 <sup>new</sup> 74.16 ✓
	Sum Item		6,168.02

Sum Labor 4,540.00  
Sum Item 6,168.02

Total SGD 10,708.02  
7% GST 749.56  
Total SGD Incl. GST 11,457.58

## Explanations

P = Proportionately Charged

## Payment Terms

No Credit

**LKK Auto Consultants** hence notify the Repairer of the following:

- To resurvey before/after spray painting
- To display damaged part(s) during resurvey
- Parts prices are subject to confirmation
- Third party survey is on a "Without Prejudice" basis
- No illegal modification(s) is allowed
- Supplementary item(s) must be resurveyed and is subject to final approval from Insurance Company

Acknowledged by Repairer  
Signature:  
Date:

RASUL  
Hp 90010068  
4-5 days  
05/12/17 @ 1110  
EXCESS: 1500  
REURER  
Resurvey by part

Payments to: - BBN: - Acc.-No..:

Model	Year	MG	SG	Illustration	Restrictions	UPD	16:31	30.11.2017	ETKA	
PA	2017	8	53	853-000	3C-H-000 001 >>	1200			 Volkswagen	

EC	TC	ITC	VIN	Production	Sales Type
CJSA	RRL	TO	WWWZZZ3CZHE050064	17.08.2016	3G24JZ

# FI SUGGESTION

Pos	Part Number	Description	Remark	Qty	Model
11	3G0 854 321	Vent grille	left	1	
	08/14 9B9	Cover trim			
		Satin black			
(11)	3G0 854 322	Cover trim	right	1	
	08/14 9B9	Satin black			
12	3G0 853 671	Vent grille with trim strip	center	1	PR-DF4, DN4+ 2JC, 2JL, 2JP, 2JR
		D - 16.11.2015>>			
	11/15 9B9	Satin black			

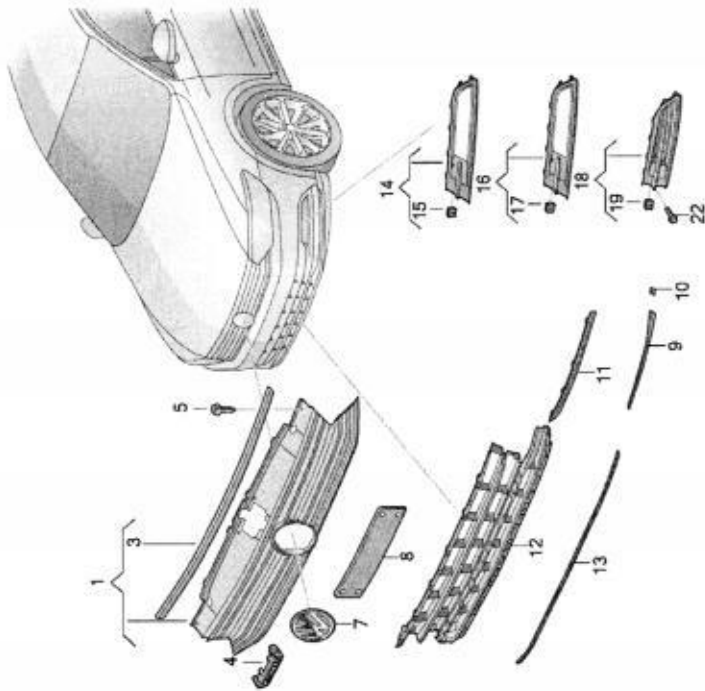

## Service Order Confirmation

SERVICE ORDER NO: 17IP3308

CUSTOMER NO.: CV009616

CUSTOMER NAME: TOO MENG NGEE

TELEPHONE NO.:

ADDRESS: 11 BEDOK RESERVOIR VIEW #03-04

Singapore

**VEH No.: SCL7752T**

Order Date: 05/12/17

Reg Date: 31/07/17

KM: 5,431

VIN NO.: WVVZZZ3CZHE050064

ENGINE NO:

SA: Kong Charmaine

MODEL: Passat 1.8 TSI Highline 17in

MODEL NO.: 3G24JZ

No.	DESCRIPTION	QTY	UOM	UNIT PRICE	DISC %	AMOUNT
<b>Labor</b>						
1	B&P DIAG PROGRAMMING & CALIBRATION- NETT	1	TU	360		360
2	B&P MECH ELECT WIRING & MECH COMPONENT CHECK NETT	1	TU	200		200
3	B&P INSURANCE EXCESS INSURANCE EXCESS / DEDUCTIBLE	1	TU	-1,500		-1,500
4	B&P NUMBER PLATE B&P NUMBER PLATE -NETT	1	ST	80		80
5	B&P ALEX LABOUR LABOUR	2	UNIT	475		950
6	B&P ALEX PAINT SPRAY PAINT	2	UNIT	500		1,000
7	EXT00037 Tow SVC- Quality Recovery Services	1	UNIT	0		0
8	EXT00037 Tow SVC- Quality Recovery Services	1	UNIT	0		0
<b>Item</b>						
9	3G0807217K GRU FRT BUMPER COVER	1	PCS	1,668.15	28 1201.06	1,201.07
10	3G0807049 BUMPER BRACKET LH	1	PCS	53.70	28	38.66
11	3G0807050 BUMPER BRACKET RH	1	PCS	52.98	28 38.14	38.15
12	3G0853851A BKZ GRILLE	1	PCS	749.16	28	539.40
13	3G0853601B DPJ VW SIGN-FRT GRILLE	1	PCS	91.84	28	66.12
14	3G0854322 9B9 CHROME COVERSTRIP RHS	1	PCS	97.11	28	69.92
15	3G0853254 2ZZ RHS CHROME MOLDING	1	PCS	121.25	28	87.30
16	3G0853245 2ZZ CHROME MOLDING CENTER	1	PCS	208.33	28	150.00
17	3G0823031A BONET HOOD	1	PCS	945.97	28	681.10
18	3G0998493 SENSOR BRACKET SET	1	PCS	80.79	28	58.17
19	D 180KU2A1 2KADHESIVE	1	PCS	103.66	28	74.64
20	D 822150A1 BONDAGENT	1	PCS	74.16	28	53.40
21	3G0807889 BUMPER CENTRE BRACKET	1	PCS	117.04	28	84.27
22	3G0854662 9B9 FOG LAMP GRILLE RH	1	PCS	99.18	28	71.41
23	3G0853671 9B9 CENTRE LOWER GRILLE	1	PCS	187.08	28	134.70

Remarks : MSIG WINNER OD

DOA 30/11/2017

SURVEYOR LKK RASUL

EXCESS \$1500

## Service Order Confirmation

SERVICE ORDER NO: 17IP3308

CUSTOMER NO.: CV009616

CUSTOMER NAME: TOO MENG NGEE

TELEPHONE NO.:

ADDRESS: 11 BEDOK RESERVOIR VIEW #03-04

Singapore

**VEH No.: SCL7752T**

Order Date: 05/12/17

Reg Date: 31/07/17

KM: 5,431

VIN NO.: WVGZZZ3CZHE050064

ENGINE NO:

SA: Kong Charmaine

MODEL: Passat 1.8 TSI Highline17in

MODEL NO.: 3G24JZ

<u>No.</u>	<u>DESCRIPTION</u>	<u>QTY</u>	<u>UOM</u>	<u>UNIT PRICE</u>	<u>DISC %</u>	<u>AMOUNT</u>
------------	--------------------	------------	------------	-------------------	---------------	---------------

TOTAL	4,438.29
GST AMOUNT	310.68
TOTAL AMOUNT	4,748.97

On Behalf Of "COMPANY"

Certified Goods/Service received:

\_\_\_\_\_  
Authorized Signature

\_\_\_\_\_  
Customer

NOTE: THIS IS NOT AN OFFICIAL RECEIPT

## LKK Auto Consultants Pte Ltd (Co.Reg.No:199607198R)

51 Ubi Ave 1 #01-25, Paya Ubi Industrial Park

Singapore 408933

Tel: 6256-3561 Fax: 6844-8805 Email: sur@lkkauto.com; assignments@lkkauto.com

## VEHICLE DAMAGE INSPECTION REPORT

MSIG Insurance (Singapore) Pte. Ltd.  
4 Shenton Way, #21-01 SGX Centre 2  
Singapore 068807

Our File No: CS/MSG17023018/R1QBN2

Date: 19/01/2018

## REFERENCE

Insured/Claimant: TOO MENG NGEE Policy No: A28998081AVW  
Date of Loss: 30/11/2017 Nature of Claim: OD Claim No: 538850

## DESCRIPTION &amp; IDENTIFICATION OF VEHICLE

Reg No: SCL7752T  
Make & Model: VOLKSWAGEN PASSAT, 1.8 TSI (B7) (A) Engine No: CJS177255  
Reg. Date: 31/07/2017 (Man. Year: 2016) Chassis No: WVVZZZ3CZHE050064  
Colour: White Odometer: 5336 km  
Engine Capacity: 1798 cc  
Market Value/New Car Price: S\$146,000.00  
Sum Insured (S\$): Market Value/New Car Price

## CONDITION OF VEHICLE AT THE TIME OF SURVEY

General Condition: Steering (Serviceable): Yes Footbrake (Serviceable): Yes  
Handbrake (Serviceable): Yes Engine Modification: No Pre-accident Condition:

## CONDITION OF TYRES

Front Tyre Size: 215/55 R17 Rear Tyre Size: 215/55 R17  
Front Left Side: Continental 6 mm Rear Left Side: Continental 6 mm  
Front Right Side: Continental 6 mm Rear Right Side: Continental 6 mm

The above values represent the remaining tyre treads depth

COST OF CLAIMS	Repairer's	Adjuster's	Difference	Diff %
Parts	6,248.02	3,428.29	2,819.73	45.13
Miscellaneous Items	0.00	0.00	0.00	
Labour	4,460.00	2,510.00	1,950.00	43.72
Paintwork Labour	0.00	0.00	0.00	
Towing	0.00	0.00	0.00	
<b>Calculated Gross Total (S\$)</b>	<b>10,708.02</b>	<b>5,938.29</b>	<b>4,769.73</b>	<b>44.54</b>
<b>- Excess (S\$)</b>	<b>1,500.00</b>	<b>1,500.00</b>	<b>0.00</b>	<b>0.00</b>
<b>(S\$)</b>	<b>9,208.02</b>	<b>4,438.29</b>	<b>4,769.73</b>	<b>51.80</b>
<b>+ GST 7.00/7.00% (S\$)</b>	<b>644.56</b>	<b>310.68</b>	<b>333.88</b>	<b>51.80</b>
<b>Nett Amount (S\$)</b>	<b>9,852.58</b>	<b>4,748.97</b>	<b>5,103.61</b>	<b>51.80</b>

## INSPECTION

Date of Assignment: 04/12/2017

Date Inspected: 05/12/2017 Inspected At:

Volkswagen Centre Singapore  
(Alexandra)  
247 Alexandra Road  
Singapore 159934

Estimated Period of Repair: 4.0 days

Adjuster: MOHD RASUL

Manager: SHIAU CHAN

NOTE: This report represents our findings at the time and place of inspection stated herein. Such inspection has been carried out to the best of our knowledge and ability but any other liability under any other circumstances is hereby expressly excluded.

## REPAIR DETAILS

## Reference

<b>Part Source:</b>	MRM-SG	Version: 1.0 (Last Synchronised: 19 Jan 2018)
<b>Parts:</b>	143	VOLKSWAGEN PASSAT 1.8 TSI (B7) (A) (Catalogue:Merimen Singapore 1.0)
<b>Labour:</b>	Repairer's	(Price-denominated Standard List)
<b>Print Code:</b>	(Unsubmitted, no print-code for SCL7752T)	
<b>Validity:</b>	These estimates are valid only if they contain the print code (above) on all estimate pages, running page numbers with the END OF ESTIMATES marker on the last estimate page	
<b>Further Info:</b>	Items/values not in reference catalogue are prefixed with an asterisk *.	

## Recommended Parts

No.	Qty	Part No.	Particulars	Condition	Repairer's	Amount
1	1		*FRT LOWER SPOILER	Serviceable	255.18 FS	*- FS
2	1		*BUMPER BRACKET LH	Necessary	53.70 FS	*38.66 FS
3	1		*BUMPER BRACKET RH	Necessary	52.98 FS	*38.14 FS
4	1		*BEAM	Serviceable	652.72 FS	*- FS
5	1		*BUMPER GUIDE LH	Serviceable	91.95 FS	*- FS
6	1		*BUMPER GUIDE RH	Serviceable	91.95 FS	*- FS
7	1		*FRT BUMPER COVER	Deformed	1,668.15 FS	*1,201.06 FS
8	1		*FOAM INSERT	Serviceable	152.68 FS	*- FS
9	1		*NUMBER PLATE BASE PLATE	Serviceable	96.67 FS	*- FS
10	1		*MEMBER	Serviceable	176.49 FS	*- FS
11	1		*BUMPER CENTRE BRACKET	Cracked	117.04 FS	*84.27 FS
12	1		*BONET HOOD	Bent	945.97 FS	*681.10 FS
13	1		*CHROME MOLDING CENTER	Cut	208.33 FS	*150.00 FS
14	1		*RHS CHROME MOLDING	Cut	121.25 FS	*87.30 FS
15	1		*VW SIGN-FRT GRILLE	Missing	91.84 FS	*66.12 FS
16	1		*GRILLE	Cracked	749.16 FS	*539.40 FS
17	1		*CENTER VENT GRILLE	Cracked	187.08 FS	*134.70 FS
18	1		*CHROME COVERSTRIP RHS	Cut	97.11 FS	*69.92 FS
19	1		*GRILLE RHS	Cracked	99.16 FS	*71.41 FS
20	1		*SENSOR BRACKET SET	Necessary	80.79 FS	*58.17 FS
21	1		*2KADHESIVE	Necessary	103.66 FS	*74.64 FS
22	1		*BONDAGENT	Necessary	74.16 FS	*53.40 FS
23	1		*B&P NUMBER PLATE	Bent	80.00 FS	*80.00 FS
Total Parts (S\$)					6,248.02	3,428.29

F=Franchise part. S=SpcNett.

Report was unsubmitted during this print-out.

## Recommended Miscellaneous Items

There are no new miscellaneous items selected.

## Recommended Labour

No	Particulars	Lab.Type	Repairer's	Amount
<b>Labour Items</b>				
1	LABOUR	New	1,900.00	950.00
2	SPRAY PAINT	New	2,000.00	1,000.00
3	PROGRAMMING & CALIBRATION COMPULSORY TO DO AFTER AC	New	360.00	360.00
4	ELECT WIRING & MECH COMPO	New	200.00	200.00
Gross Labour Cost (\$\$)			<b>4,460.00</b>	<b>2,510.00</b>

Report was unsubmitted during this print-out.

< END OF ESTIMATES >