

NATIONAL Assessment Centre Services

(wef 1 Jan 2005)

MNA 117155584

Date In: 24/11/17 15:59	Job description: SAS e-filing	Date & Time Completed:	Done by:
Ref No: NAI CTI 17022455/h4			
Veh No: SJR 4671 Z	E-mail (within 8hrs, MOC 2hrs)		
D.O.A: 22/11/17 03:45	i-Motor Claim Form		
OD / TP / Repairing Only	i-Motor W/O (Within: OD 2hrs, TP 4hrs)		
	i-Photo Uploaded		
TP Insurer:	Assessment/Survey Report		
	Ass't Report by Fax / Hand to Owner/Wksp		

Preferred Wksp / INC Assign Wksp / QW: (Tel: (Fax: (
TP Particulars:	Veh No: Unknown.	INC () / Non-INC ()
Owner / Driver: (Tel: (
Policy No: (Period: (Cover Type: (
Confirmed by: (Date: (Time: (
Insured/Driver Liability: (%)	[Note-Est. Status (WO): N: 0-20%; P: 21-79%; F: 80-100%]	
Year of Registration: (Warranty: YES () / NO ()	
Excess: (\$	Loading: \$1,000 () / \$2,000 ()	

General Remarks:-

() Walk-In Customer : Customer's information strictly Confidential & Strictly NO refer of repairer.

() Total Loss Case : to e-mail Insurer URGENTLY.

Drive-In () / Towed-In () ; Invoice: YES () / NO () ; Towing Co: ()

Remarks:- (INC hotline: 6788 6616)	Date & Time Completed	Done by
1) Apply for Transport Allowance () / Courtesy Car ()		
2) QC Check / Post Repair Inspection ()		
3) Upload Resurvey Photo [Repair Cost > \$3000] ()		

Injury : _____

Date/Time	Actions

NA 1707302	Invoice Preparation Checklist		Amt (\$) 1st Bill	Amt (\$) Add Bill
Claimant's Particulars :-	1) AR: Accident Reporting (\$30)		30.00	
Driver/Owner:	2) DA: Damage Assessment (\$100); INC (\$80)			
Contact No:	3) TF: Towing Fee \$40/\$45			
Damaged Portion:	4) FT: Follow-Through Survey \$120			
QC Checked by (Engr-In-Charge):	5) FT: Follow-Through Survey (Resurvey) \$90			
Auditors' Comments :-	For claiming against INC Only (wef 10 Jan 2005)			
	6) TR: Re-inspection \$75			
	7) N1: Idac DA + SMRT Survey \$160			
	8) NTUC Additional Services:-			
	OD:			
	*N5: Courtesy Car / Tpt Allowance \$5			
	*N6: Repair Co-ordination \$10			
	*N7: Post Repair Inspection \$25			
	*N8: DV / Collect Excess Coordination \$5			
	TP (N11): TP (N-n INC) against INC \$20			
	9) N12: Idac Mobile \$0			
	Invoice dated	Fee Charged		
	Invoice dated	Fee Charged		

SINGAPORE ACCIDENT STATEMENT

IMPORTANT NOTICE

1. Please report correctly the details of the accident to speed up the claims process.
2. This Form must be completed by the Policyholder and/or the Authorised Driver.
3. Information provided must be as truthful and accurate as possible. Any wilful misrepresentation or withholding of material facts may allow insurance companies to repudiate policy ability.
4. The issue and acceptance of this Form by insurance companies is not an admission of policy liability on the part of the insurance companies.
5. Any false reporting may be referred to the Police for investigation.
6. This report will be forwarded by the insurers of the insurers of the GIA Records Management Centre established by the General Insurance Association of Singapore (GIA) for archiving and that copies of this report will for a fee be made available upon application by interested parties.
7. By the lodgement of this report to the insurers, you hereby consent to the archiving of this report at the centre and to copies of the report being made available aforesaid.

ACCIDENT STATEMENT

Date Of Report	24/11/2017 15:59
Date Of Accident	22/11/2017 03:45
Exact Location Of Accident	HOME SUITE VIEW HOTEL EXIT TO LOR 12 GEYLANG
Country/State of Loss	SINGAPORE

DETAILS OF OWN VEHICLE

Vehicle Registration Number	SJR4671Z
Insured/Policyholder	
Name Of Registered Owner	MR YEO ENG CHER GARY
NRIC No	S1647122D
Email Address	10GECY@GMAIL.COM
Mobile Phone No	(LOCAL) +65-91713500
Alternative Phone No	OFFICE-91713500

Vehicle Particulars

Manufacturer	RENAULT
Model	MEGANE 1.6 AUTO 4DR ABS AIRBAG
Exact Purpose for which vehicle was being used at time of accident	PRIVATE USE
Are you claiming under your own insurance policy for repair to your vehicle?	NO
If No, Please state action to be taken	REPORTING ONLY
Vehicle Category	PRIVATE CAR

Insurance Company

Name of Insurance Company	CHINA TAIPING INSURANCE (SINGAPORE) PTE. LTD.
Type Of Coverage	COMPREHENSIVE
Fleet Policy	NO
Policy Number	DMPCSN1743531700
Cover Note Number	-

Driver

Name of Driver	MR YEO ENG CHER GARY
NRIC No	S1647122D
Date Of Birth	10/10/1964
Occupation	INDOOR
Date Of Driving Pass	01/06/2009
Driving Experience	8 YEARS AND 5 MONTHS
Gender	MALE
Mobile Number	(LOCAL) +65-91713500
Fax Number	
Contact Number	OFFICE-91713500
Email Address	10GECY@GMAIL.COM

Address	125 SELETAR HILLS DR
Postcode	807136
Was driver an employee of the Insured's Company	NO
If No, Relationship of the Driver with the Insured	OWNER
Vehicle Registration Number of Driver's Own Vehicle	-
	-
	-
Insurance Company of Driver's Own Vehicle	-
	-
	-

General Information of the Accident

Type Of Accident	COLLISION - MAJOR/MINOR RD
Weather Conditions	CLEAR
Road Surface	DRY

Other Information

Was any foreign vehicle involved in this accident?	NO
Was any body injured in the Accident?	NO
Was any other material or property damaged?	YES
I have been approached by unknown person(s) soliciting/offering accident claims assistance.	NO
Number of Passengers (Including Driver)	1

Details of Police Action

Was the accident reported to the police?	NO
If Yes, Please state which Police Station	
Was notice of intended Prosecution given?	NO
If Yes, against whom?	

Circumstances of Accident

PLEASE REFER TO ATTACHED STATEMENT.

Attachment(s)

Are accident photos available for attachment?	YES
Was there any video captured by Car Camera?	NO
Was there any audio recorded?	NO

DETAILS OF OTHER VEHICLE PROPERTY 1

Vehicle Registration Number	UNKNOWN
Vehicle Make/Model/Colour	WHITE COLOR VAN
Details Of Properties	
Name of Driver	
NRIC/Passport Number	
Contact Number	
Address	
Postcode	
Insurance Company Name	
Nature Of Damage	
No. Of Passenger (Including Driver)	

Details of Witness

Name	
Phone Number	
Email Address	

SKETCH PLAN

IMPORTANT NOTICE

1. Please report correctly the details of the accident to speed up the claims process.
2. This Form must be completed by the Policyholder and/or the Authorised Driver.
3. Information provided must be as truthful and accurate as possible. Any wilful misrepresentation or withholding of material facts may allow insurance companies to repudiate policy liability.
4. The issue and acceptance of this Form by insurance companies is not an admission of policy liability on the part of the insurance companies.
5. Any false reporting may be referred to the Police for investigation.
6. The report will be forwarded by the insurers of the GIA Records Management Centre established by the General Insurance Association of Singapore (GIA) for archiving and that copies of this report will for a fee be made available upon application by interested parties.
7. By the lodgment of this report to the insurers, you hereby consent to the archiving of this report at the centre and to copies of the report being made available aforesaid.
8. **Consent under the Personal Data Protection Act (PDPA)**

I understand, acknowledge, agree and consent that:

- (a) My insurer, my workshop and the General Insurance Association of Singapore ("GIA") may/are permitted to collect, use, disclose and/or process my personal data/personal information set out in this [form] and any other personal information provided by me or possessed by my insurer (collectively the "Personal Information") and disclose and transfer such Personal Information to all insurer(s) who have insured vehicle(s) involved in this accident (all insurer(s) who have insured vehicle(s) involved in this accident shall be collectively referred to as the "Insurers"), the Insurers' lawyers/law firms, the Monetary Authority of Singapore and any relevant government agency/authority (such as the police), for the purpose(s) of:
 - (i) processing, handling and/or dealing with my claims including the settlement of the claims and any necessary investigations relating to the claims;
 - (ii) investigating the accident and/or my claims;
 - (iii) carrying out and/or dealing with my instructions or responding to any enquiries by me;
 - (iv) administering my claims (including the mailing of correspondence, statements, invoices, reports or notices to me, which could involve disclosure of certain personal data about me to bring about delivery of the same as well as on the external cover of envelopes/mail packages); and/or
 - (v) complying with applicable law in administering, processing, handling and/or dealing with my claims.(collectively the "Purposes")
- (b) all insurer(s) who have insured vehicle(s) involved in this accident and the Insurers' lawyers/law firms, may/are permitted to collect, use, disclose and/or process my Personal Information for one or more of the above Purposes; and
- (c) my Personal Information may/can be disclosed by any of the Insurers and/or GIA to their third party service providers or agents(including their lawyers/law firms), which may be sited outside of Singapore, for one or more of the above Purposes.
- (d) my Personal Information will also be collected and used to compile claims history for the purpose of fraud detection, investigation and management in present and all future claims.
- (e) the information so collected under (d) above may be shared / disclosed:
 - (i) to all insurers and/or any other third parties that assist in evaluating, investigating, controlling or managing fraud, regulators, law enforcement and government agencies as reasonably required for the purposes stated, or
 - (ii) for complying with requirements under any regulations, laws or court orders.

Policyholder's Signature
Date & Time:

Driver's Signature
(If driver is not the policyholder)
Date & Time:

Reporting Centre Personnel's Signature
Name:
NRIC/FIN No.:

SKETCH PLAN

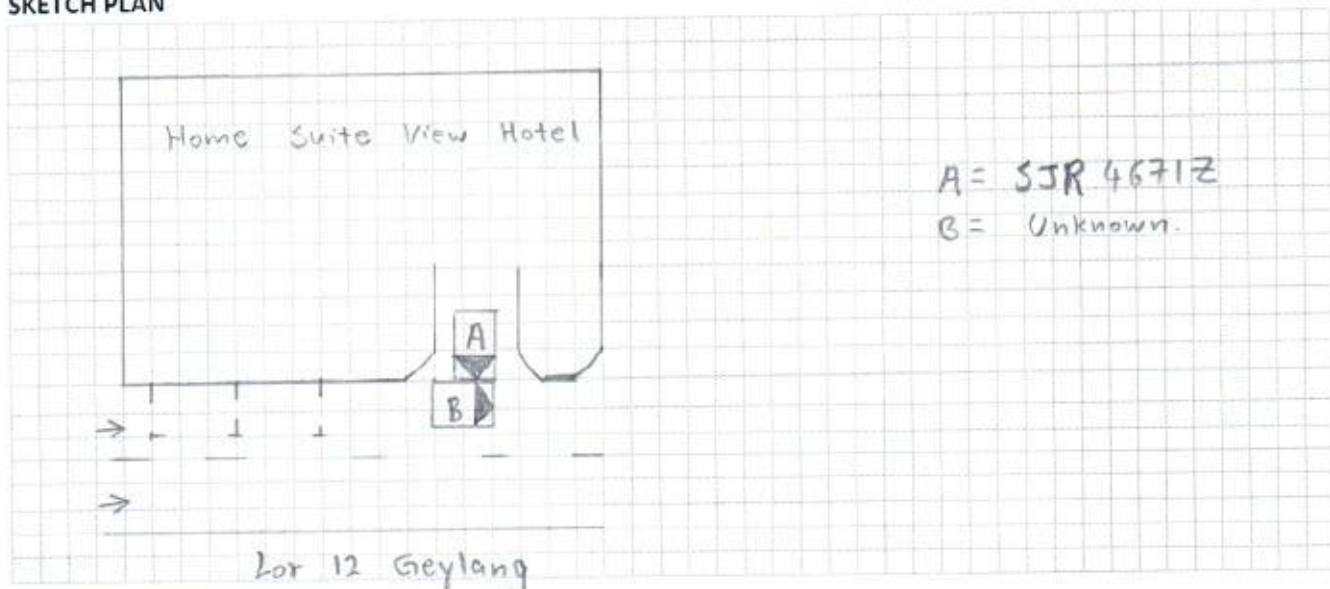

DESCRIBE CIRCUMSTANCES OF THE ACCIDENT

Please Refer to statement

DECLARATION

I/We declare the foregoing particulars are true in every respect.

Policyholder's Signature
Date & Time:

Driver's Signature
(If driver is not the policyholder)
Date & Time:

Reporting Centre Personnel's Signature
Name:
NRIC/FIN No.:

AFTER CHECKING TRAFFIC WAS CLEAR, I EXITING FROM THE HOME SUITE VIEW HOTEL TO THE LOR 12 GEYLANG. SUDDENLY A WHITE VAN COME SO FAST FROM THE MAIN ROAD, CAUSING BOTH VEH COME TO A COLLISION. AFTER THE INCIDENT I TOOK PHOTO FOR THE VAN. BUT AFTER FEW DAY LATER, I LOST THE PHOTO INSIDE MY PHONE AND CANNOT GET THE VAN LICENSE PLATE NUMBER.

ACCIDENT STATEMENT

ACCIDENT DATE: ²²~~28~~ / 11 / 17 (DD/MM/YYYY), TIME: (3 : 45) (HH:MM)

LOCATION: Home Suite View Hotel Exit to Lor 12 Geylang

1. DETAILS OF VEHICLE

- a) VEHICLE NUMBER: SJR 4671Z
b) INSURANCE COMPANY: CTI
c) POLICY NUMBER: _____
d) POLICY TYPE: (COMPREHENSIVE / THIRD PARTY / THIRD PARTY FIRE & THEFT)
e) MAKE & MODEL: _____
f) TYPE: (SALOON / COUPE / MPV / VAN / LORRY / MOTORCYCLE / OTHERS)
g) VEHICLE CATEGORY: (PRIVATE / COMMERCIAL / MOTORCYCLE)
h) PURPOSE OF USING AT ACCIDENT TIME: Private Use
i) ARE YOU CLAIMING UNDER YOUR OWN INSURANCE (YES/NO)
IF NO, PLEASE STATE (THIRD PARTY CLAIM / REPORTING ONLY)

2. INSURED / POLICY HOLDER

- A) NAME: Yeo Eng Cher Gary (MALE / FEMALE)
b) NRIC/FIN/PASSPORT: _____ CONTACT: 91713500
c) ADDRESS: _____

* CONTINUE TO 3.d IF DRIVER ALSO POLICY HOLDER

DRIVER

- a) NAME: As Above (MALE / FEMALE)
b) NRIC/FIN/PASSPORT: _____ CONTACT: _____
c) ADDRESS: _____

*d) DATE OF BIRTH: (____/____/____) (DD/MM/YYYY)

e) OCCUPATION: (INDOOR / OUTDOOR)

f) YEARS OF DRIVING EXPERIENCE: _____

4. WAS DRIVER AN EMPLOYEE OF THE INSURED'S COMPANY? (YES / NO)
IF NO, RELATIONSHIP OF THE DRIVER WITH INSURED: owner.

5. a) WEATHER CONDITION: (CLEAR / RAINING / OTHERS) _____
b) ROAD SURFACE: (DRY / WET / OTHERS) _____
6. WAS ANYBODY INJURED (YES / NO)
7. a) REPORTED TO POLICE (YES / NO)
IF YES, PLEASE STATE WHICH POLICE STATION: _____

8. THIRD PARTY VEHICLE

- a) VEHICLE NUMBER: Unknown. MODEL: White Van.
b) DRIVER'S NAME: _____
c) NRIC/FIN/PASSPORT: _____ CONTACT: _____

9. THIRD PARTY VEHICLE

- d) VEHICLE NUMBER: _____ MODEL: _____
e) DRIVER'S NAME: _____
f) NRIC/FIN/PASSPORT: _____ CONTACT: _____

Camera: No.

Waiting CI

email = 10gecy@gmail.com
fax = _____

10 geey @ gmail . com

REPUBLIC OF SINGAPORE DRIVING LICENCE

Licence Number: **S1647122D**

Name: **YEO ENG CHER GARY**

Birth Date: **10 Oct 1964**

Issue Date: **01 Jun 2009**

001748030K



REPUBLIC OF SINGAPORE

IDENTITY CARD NO. **S1647122D**

Name: **YEO ENG CHER GARY**

Race: **CHINESE**

Date of birth: **10-10-1964**

Country of birth: **SINGAPORE**

Sex: **M**

S1647122D





YOU ARE LICENSED TO DRIVE VEHICLES IN THE FOLLOWING CLASS(ES)

PASS DATE: **01 Jun 2009**

Class 3 Motor Cars=< 3000kg with =<7 passengers, exclusive of the driver, and other motor vehicles =< 2500kg

Licence No: **S1647122D**

NP 428A



3841359

NRIC No. **S1647122D**

Date of issue: **26-01-2006**

125 SELETAR HILLS DRIVE
SINGAPORE 807136

NRIC No: **S1647122D**

Date: **13/10/2008**

No: **6342091**





中国太平保险(新加坡)有限公司
CHINA TAIPING INSURANCE (SINGAPORE) PTE. LTD.
Co. Reg. No. 200208384E

MX1E
N SN
AN0357A
Cov.Type: C

MOTOR PRIVATE CAR R

CERTIFICATE OF INSURANCE

Motor Vehicles (Third-Party Risks and Compensation) Act (Chapter 189)
Motor Vehicles (Third-Party Risks and Compensation) Rules, 1960
Road Transport Act, 1987 (Malaysia)
Motor Vehicles (Third-Party Risks) Rules, 1959 (Malaysia)

ORIGINAL

CERTIFICATE No.

DMPCSN1743531700

Engine No :K4MC813R031713

ChaNo:VF1LM0J0E41449484

1. Index Mark and Registration
Number of Vehicle

SJR4671Z

AUTOSAFE

2. Name of Policy Holder

MR YEO ENG CHER GARY

3. Effective date of the Commencement of
Insurance for the purposes of the Regulations,
Ordinance or Enactment

25 June 2017

Named Drivers Ex Sect. I S\$800.00

Additional Ex Other than Named Drivers:

4. Date of Expiry of Insurance

24 June 2018

Ex Sect. I - Age <= 25..... S\$3,000.00

Ex Sect. I - Age >= 26..... S\$500.00

* Age as at date of accident

5. Persons or Classes of Persons entitled to drive*

EX ON WINDSCREEN S\$100.00

(a) The Policyholder.

(b) Any other person who is driving on the policyholder's order or with his permission.

Provided that the person driving is permitted in accordance with the licensing or other laws or regulations to drive the Motor Vehicle or has been so permitted and is not disqualified by order of a Court of Law or by reason of any enactment or regulation in that behalf from driving the Motor Vehicle.

6. Limitations as to use:

Use for social, domestic and pleasure purposes and for the Policyholder's business.

The policy does not cover use for hire or reward tuition driving test racing pace-making, reliability trial, speed-testing, the carriage of goods other than samples in connection with any trade or business or use for any purpose in connection with the Motor Trade.

Excess whichever is applicable for losses occurring outside Singapore (Constructive Total Loss/Theft) will be doubled.

One time waiver of Excess for the first S\$1,000 will apply to the Insured and Named Drivers in the event of Own Damage Claim at our Authorised Workshops for each Policy Year.

* Limitations rendered inoperative by Section 8 of the Motor Vehicles (Third-Party Risks and Compensation) Act (Chapter 189) and Section 95 of the Road Transport Act 1987 (Malaysia), are not to be included under these headings.

I/We hereby Certify that the policy to which this Certificate relates is issued in accordance with the provisions of the Motor Vehicles (Third-Party Risks and Compensation) Act (Chapter 189) and Part IV of the Road Transport Act, 1987 (Malaysia).

Please see reverse

For CHINA TAIPING INSURANCE (SINGAPORE) PTE. LTD.

Issued By:
Authorised Officer

.....
Authorised Signatory