

REF CS/AXA/7020335/R1rb52

ASS. REC. BY:

Rasul

Winnie ASSIGNMENT (Office)

AXA

Date/Time 24/10/17 @ 1:39pm

From (Person):

Yvonne Ang

Estimated Cost

OT/TP/WS/TP RES/OD RES/EVA/INV/MV/CS

To inspect Vehicle No:

XD 3957P

at Workshop info

ST Kinetics

of

No. 249 Jalan Berau Bay 619523

Policy No

P1893524

Claim No

C0456701

Excess

D.O.A 29/07/2017

Sum Insured

Make of Veh

(Client's Record)

31 Corporation Road

H.O.D. Endorsement

CA / (REV) / REP. / REV 24 HRS

Date/Time 24/10/17 @ 1:52pm Person Contacted

Juman

Vehicle IN OUT

Date/Time	Action/Instruction
	(✓) Estimate Investigation
	Please Check why there is delay in Submission of Claim
	XD 3957P - X
22/12/17	Sent preli to menimen - because they dont they are not about
05/1/18	Authorise repair. aware their cash repair
5/1/18	Inform Juman to proceed repairing cover include fire claim
8/6/18	Received Supplementary



LKK Auto Consultants Pte Ltd

51 Ubi Ave 1 #01-25 Paya Ubi Industrial Park, Singapore 408933

TEL: 6256 3561 FAX: 6256 4315

Reg. No: 199607198R GST Reg. No. 19-9607198-R

Affiliated to Federation Internationale Des Experts En Automobile				
AXA INSURANCE PTE LTD		Ref : CS/AXA17020335/R1rb		
8 SHENTON WAY #24-01 AXA TOWERSINGAPORE 068811		Date : 24-10-2017		
		Code : AXA2		
1. Policy Particulars :- OWN DAMAGE				
Insured Veh.		Veh. Inspected	XD 3957P	
Policy No.	P1893524	Coverage (\$)	0.00	
Claim No.		Excess (\$)	0.00	
Assign From	MERIMEN (YVONNE ANG)	Assign Date	24/10/2017	
2. Vehicle Particulars & Condition				
Make & Model		c.c	0	
Engine No.	HIDDEN	Year of Reg.		
Chassis No.		Colour		
Odometer	-	Steering		
Brakes		Modification		
General				
3. Conditions of Tyres				
	Size	Make	Balance	
R/H Front Tyre			mm	
L/H Front Tyre			mm	
R/H Rear Tyre			mm	
L/H Rear Tyre			mm	
4. Description of Damages				
5. General Information				
Accident Date	29/07/2017	Inspection Date	24/10/2017	
Survey held at	31 CORPORATION ROAD			
Repairer	-			
5a. Remarks				
A)THE MARKET VALUE IS S\$------(EST. AVERAGE) B)IN ACCORDANCE TO YOUR INSTRUCTIONS, WE HAVE AUTHORISED REPAIRS.				

Sold to dealer in Nov 2016.

- Letter from LTA Nov 30th 2016.

- not with del.

...CLAIM SUBFOLDER...(New Assignment)

Pending Driver License Fire Investigation

CLAIM SUBFOLDER TRACKING

Case	Notified	Est Submitted	Adj Assigned	Adj Rpt	Adj Submitted	Ins Auth'd	Status
Main	24 Oct 2017 11:54		24 Oct 2017 13:39 Assign				New Assignment Cancel Case

Main

Reference

Claim Details

Documents

[Show All](#)

CLAIM SUBFOLDER DETAILS

[Created by insurer]

Insured:	TSL LOGISTICS PTE LTD, Co. Reg. No.: 201309403M		
Vehicle Reg. No.:	XD3957P	Date of Loss:	29/07/2017 13:00 - :59
Claim Type:	OD	Policy/Cover Note No.:	P1893524 (TP, Fire & Theft)
		Excess:	S\$0.00
Repairer:	Singapore Technologies Kinetics Ltd (Jalan Boon Lay) STAR Building, No 249 Jalan Boon Lay, 619523 Boon Lay - Tel: 6515 3011		
Handling Insurer:	AXA Insurance Pte Ltd (HQ) - Tel: 6338 7288 ... [Handled by Yvonne Ang Ching Ching - 6880 4461]		
Adjuster:	LKK Auto Consultants Pte Ltd (HQ) - Tel: 6256-3561 ... [Final Rpt due 02/11/2017]		
Driver/Custodian:	CHAI WENCHAO (35 / Male), NRIC: G2611459X		
Adj Asg. Remarks:	PLEASE CONDUCT INVESTIGATION AND ALSO CHECK WHY THERE IS DELAY IN SUBMISSION OF CLAIM		

ASSOCIATED MAIL RECEIVED

[View All](#) [Compose Case Mail](#)

There are no mail for this case.

ALL ASSOCIATED TASKS

[View All](#) [Search Tasks](#) [Create New Task](#) [Complete](#)

Due Date	Priority	Type	Task Group	Subject	Handler	Assigned By	Completed On	Created On	Done?
No results.									

SINGAPORE ACCIDENT STATEMENT

IMPORTANT NOTICE

1. Please report correctly the details of the accident to speed up the claims process.
2. This Form must be completed by the Policyholder and/or the Authorised Driver.
3. Information provided must be as truthful and accurate as possible. Any wilful misrepresentation or withholding of material facts may allow insurance companies to repudiate policy ability.
4. The issue and acceptance of this Form by insurance companies is not an admission of policy liability on the part of the insurance companies.
5. Any false reporting may be referred to the Police for investigation.
6. This report will be forwarded by the insurers of the insurers of the GIA Records Management Centre established by the General Insurance Association of Singapore (GIA) for archiving and that copies of this report will for a fee be made available upon application by interested parties.
7. By the lodgement of this report to the insurers, you hereby consent to the archiving of this report at the centre and to copies of the report being made available aforesaid.

ACCIDENT STATEMENT

Date Of Report	31/07/2017 16:18
Date Of Accident	29/07/2017 13:00
Exact Location Of Accident	PANDAN LOOP 194 Pandan Loop #05-15 Pantech Biz Hub.
Country/State of Loss	SINGAPORE 196 Pandan Loop

DETAILS OF OWN VEHICLE

Vehicle Registration Number	XD3957P
Insured/Policyholder	
Name Of Registered Owner	TSL LOGISTICS PTE LTD - Didn't know had fire theft
Co Reg No	201309403M - Just put @ workshop.
Email Address	NOEMAIL - 1st quote 20k.
Mobile Phone No	
Alternative Phone No	OFFICE-67772724 - then found out have fire theft.

Vehicle Particulars

Manufacturer	MAN
Model	TGS 18.400-10.5 D 4X2 BLS (M)

Exact Purpose for which vehicle was being used at time of accident

Are you claiming under your own insurance policy for repair to your vehicle? ☒ YES

If No, Please state action to be taken

Vehicle Category	COMMERCIAL VEHICLE
------------------	--------------------

Insurance Company

Name of Insurance Company	AXA INSURANCE PTE LTD
Type Of Coverage	THIRD PARTY FIRE AND/OR THEFT
Fleet Policy	NO
Policy Number	P1893524
Cover Note Number	

Driver

Name of Driver	CHAI WENCHAO
Passport No/FIN	G2611459X
Date Of Birth	16/05/1982
Occupation	OUTDOOR
Date Of Driving Pass	03/11/2015
Driving Experience	1 YEAR AND 8 MONTHS
Gender	MALE
Mobile Number	
Fax Number	
Contact Number	
Email Address	NOEMAIL

From
Cover
Dunno fire cover insurance

Address

Postcode

Was driver an employee of the Insured's Company YES

If No, Relationship of the Driver with the Insured

Vehicle Registration Number of Driver's Own Vehicle

Insurance Company of Driver's Own Vehicle

General Information of the Accident

Type Of Accident FIRE, EXPLOSION OR LIGHTNING
Weather Conditions CLEAR
Road Surface DRY

Other Information

Was any foreign vehicle involved in this accident? NO
Was any body injured in the Accident? NO
Was any other material or property damaged? NO
I have been approached by unknown person(s) soliciting/offering accident claims assistance. NO
Number of Passengers (Including Driver) 0

Details of Police Action

Was the accident reported to the police? NO
If Yes, Please state which Police Station
Was notice of intended Prosecution given? NO
If Yes, against whom?

Circumstances of Accident

VEH WAS AT PARKED DURING THE FIRE POLICE REPORT WILL UPLOAD ON A LATER DATE

Attachment(s)

Are accident photos available for attachment? YES
Was there any video captured by Car Camera? NO
Was there any audio recorded? NO

Sketch Plan Pg. 1

*Motor Vehicles (Third-Party Risks and Compensation) Act, (Chapter 183) *Motor Vehicles (Third-Party Risks and Compensation) Rules, 1960 *Road Transport Act, 1987 (Malaysia) *Motor Vehicles (Third-Party Risks) Rules, 1959 (Malaysia)

CERTIFICATE NO. : VCC/P1893524 Account No. : 04437
 Coverage : Third Party Fire & Theft Only
 Sum Insured : Market Value At The Time Of Loss
 Name of Policy Holder : TSL LOGISTICS PTE LTD
 Vehicle Registration No. : XD3957P
 Period of Insurance : From 11/01/2017 To 23/03/2018 (Both Dates Inclusive)

PERSONS OR CLASSES OF PERSONS ENTITLED TO DRIVE*

Any person who is driving on the Policyholder's order or with their permission.

Provided that the person driving is permitted in accordance with the licensing or other laws or regulations to drive the Motor Vehicle or has been so permitted and is not disqualified by order of a Court of Law or by reason of any enactment or regulation in that behalf from driving the Motor Vehicle.

LIMITATIONS AS TO USE*

- (a) Use in connection with the Policyholder's business.
 - (b) Use for the carriage of passengers (other than for hire or reward) in connection with the Policyholder's business.
 - (c) Use for social, domestic and pleasure purposes.
- This Policy does not cover:
- (a) Use for hire or reward or for racing, pace-making, reliability trial or speed-testing.
 - (b) Use whilst drawing a trailer except the towing of any one disabled mechanically propelled vehicle.

(108)

* Limitations rendered inoperative by Section 8 of the Motor Vehicles (Third-Party Risks and Compensation) Act, (Chapter 183) and Section 92 of the Road Transport Act, 1987 (Malaysia), are not to be included under these headings.

I/We hereby certify that the policy to which this Certificate relates is issued in accordance with the provisions of the Motor Vehicles (Third-Party Risks and Compensation) Act, (Chapter 183) and Part IV of the Road Transport Act, 1987 (Malaysia).

AXA INSURANCE PTE LTD

Authorized Signature

Issued by : SGOGWT on 10/02/2017

IMPORTANT

Policyholders are warned that on the sale of a motor vehicle they must surrender the Certificate of Insurance and the Policy to the insurance company. If the Certificate of Insurance has been lost or destroyed a Statutory Declaration to the effect must be made. Failure to comply with this obligation is an offence under the Motor Vehicles (Third-Party Risks and Compensation) Act (Cap. 183).

The Friction Warranty Clause requires the premium to be paid in full within a specific period failing which there would be no liability under the policy, renewal certificate, covernote and endorsement etc.

ALLINK INSURANCE AGENCY
 Blk 153 Bukit Batok Street 11
 #02-280 Singapore 650153
 Tel: 6567 4722
 Fax: 6567 5480

Sketch Plan Pg. 2

31-07-17;14:40 ;Sagi Logistics Pte Ltd

:5777 2724

1/ 1

AXA INSURANCE PTE LTD

8 Shenlon Way, #24-01
 AXA Tower, Singapore 068811
 Customer Service Centre #01-01
 Tel: 6338 7288 Fax: 6338 2522
 Website: www.axa.com.sg
 GST Registration Number: 199903512M



Original

Agent Code: 04437

Policy No. (if any):

New Business

SmartDrive Quote Ref:

MOTOR COVER NOTE

No. CN807042

- The Motor Vehicle (Third Party Risks and Compensation) Act (Cap 189) - Republic of Singapore; or
- The Road Transport Act 1987 of Malaysia; or
- The Agreement between the Minister of Finance (Singapore) and the Motor Insurers' Bureau of Singapore dated 22 February 1976; or
- The Agreement between the Minister for Transport (Malaysia) and the Motor Insurers' Bureau of West Malaysia dated 30 March 1992;
- And any subsequent revisions to the above Acts and Agreements

The Insured mentioned in the Schedule, having proposed for insurance in respect of the Motor Vehicle described in the Schedule, is hereby HELD COVERED under the terms of the Company's usual form of Motor Policy applicable thereto for the period mentioned in the Schedule unless the cover be terminated by the Company by notice in writing in which case the insurance will thereupon cease and a proportionate part of the annual premium otherwise payable for such insurance will be charged for the time the Company has been on risk.

SCHEDULE

THE COMPANY	AXA INSURANCE PTE LTD
INSURED	TSL LOGISTICS PTE LTD
INSURED BUSINESS REGISTRATION NO.	201369403M
MAKE AND DESCRIPTION OF VEHICLE	MAN TGS 18,400 PRIME MOVER
VEHICLE REGISTRATION NO.	XD3957P
YEAR OF MANUFACTURE	2009
ENGINE NO.	50521103702113
CHASSIS NO.	WMA06SZZX9M53B399
ENGINE CAPACITY/TONNAGE	67 TONS
COVER TYPE	THIRD PARTY Fire & Theft
HIRE PURCHASE	Singapura Finance Ltd
VALUE (\$)	AS PER MARKET VALUE
PERIOD OF INSURANCE	FROM: 11/01/2017 TO: 23/03/2018
EXCESS (\$)	NIL
AXA PREMIUM WORKSHOP?	NO

WE HEREBY CERTIFY THAT POLICY TO WHICH THIS CERTIFICATE RELATES IS ISSUED IN ACCORDANCE WITH THE PROVISIONS OF THE MOTOR VEHICLES (THIRD-PARTY RISK AND COMPENSATION) ACT (CHAPTER 189) AND PART IV OF THE ROAD TRANSPORT ACT 1987 (MALAYSIA).

AXA INSURANCE PTE LTD

Issued by ALLINK INSURANCE AGENCY on 01/02/2017 11:49am

Authorised Signatory

Note: This Cover Note is only valid for 60 days from the date of issue unless replaced by the Certificate of Insurance issued by the Company.

- Premium for time on risk will be charged subject to minimum of S\$53.50 (inclusive of GST), if the policy is cancelled after the inception date.
- An administrative fee of S\$26.75 (inclusive of GST) will be charged:
 - Cover note issued and cancelled before inception.
 - Retaining the old registration number for a new vehicle insuring with AXA.

PREMIUM WARRANTY

For Individual Customers:

Please note that the premium in full should be paid before inception date shown above in order for the insurance cover to be valid.

For Non-Individual Customers:

Please note that where the period of cover is for more than 60 days, the premium in full should be paid within 60 days on inception / renewal / endorsement. For all other cases, the premium in full should be paid before inception.

MTRC/NOTE/01A/3

(R)

Sketch Plan Pg. 3



redefining / Insurance

Date: 31/07/2017

To: Owner of Vehicle Number: _____

The following has been advised to you via your workshop, _____ through their staff, _____

Please tick the applicable box if you had been advice on the content as seen below:

- ☒ You had been advised by the workshop that in the case that you wish to claim against your own policy, there is a Fourteen (14) days clause whereby the claim must be made within the stipulated timeframe from the day of occurrence.
- ☐ You had been advised by the workshop on the liability and merits of the case accordingly.
- ☐ You had been advised by the workshop on the claims procedure for the type of claim that you will be making due to this accident.
- ☐ There will be delay to your vehicle repair due to the unavailability of spare parts locally and there is no other option except to indent it from overseas.
- ☐ There will be no cancellation/withdrawal of the Own Damage claim once the order of the spare parts have been placed. If you wish to cancel/withdraw the claim, you shall bear all costs, expenses &/or related charges incurred directly &/or indirectly to the procurement of the spare parts.
- ☐ The estimated waiting time for the spare parts to arrive is _____. The estimated arrival time does not include the repair period.
- ☐ You will be driving the vehicle out despite being advised by the workshop mechanic/personnel that the vehicle may not be road worthy.
- ☐ For vehicles below Three (3) years old, your Insurance Company will use only genuine original parts to repair your vehicle.
- For vehicles above Three (3) years old, your Insurance Company will be carrying out repairs using any combination of genuine original parts and/or original equipment manufacturer (OEM) parts.
- ☐ You had been advised by the workshop of the Twelve (12) months warranty for Own Damage repairs on workmanship related to the accident.
- ☐ For vehicles that are under warranty with a local distributor, you have been advised by the workshop to check with your local distributor on any effect to your warranty prior to making this Own Damage claim.
- ☐ Others _____

Signed and acknowledge by:

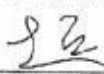
 CHAI Wenchao
G2611459X
Name and signature of policyholder/authorised driver

 _____
Name and signature of workshop personnel including company stamp

Describe Circumstances of the Accident

7月29号 中午1点钟 我把车停在 Pandan Loop 停好锁好
 我办公室单子, 车回20分钟左右 回来发现车内着火 打开
 车门把火扑灭 就向公司汇报了

82

Important:

You had been advised by the workshop that in the event that you wish to claim against your own policy (OD CLAIM), There is a FOURTEEN (14) DAYS CLAUSE WHEREBY MUST BE MADE within the stipulated timeframe from the day of occurrence.

- Reporting Only

- Claim OD

- Claim TP

- Claim OD/ TP at other workshop

✓

Declaration

I/We declare the foregoing particulars are true in every respect.



Policy holder's signature/ Date & Time

82 31/07/17
 Driver's signature
 (If driver is not the policyholder)
 Date & Time

Witnessed by Reporting
 Centre Personal

Sketch Plan Pg. 6

SKETCH PLAN

IMPORTANT NOTICE

1. Please report correctly the details of the accident to speed up the claims process.
 2. This Form must be completed by the Policyholder and/or the Authorised Driver.
 3. Information provided must be as truthful and accurate as possible. Any wilful misrepresentation or withholding of material facts may allow insurance companies to repudiate policy liability.
 4. The issue and acceptance of this Form by insurance companies is not an admission of policy liability on the part of the insurance companies.
 5. Any false reporting may be referred to the Police for investigation.
 6. The report will be forwarded by the insurers of the GIA Records Management Centre established by the General Insurance Association of Singapore (GIA) for archiving and that copies of this report will for a fee be made available upon application by interested parties.
 7. By the lodgement of this report to the insurers, you hereby consent to the archiving of this report at the centre and to copies of the report being made available aforesaid.
 8. Consent under the Personal Data Protection Act (PDPA)
- I understand, acknowledge, agree and consent that:
- (a) My insurer, my workshop and the General Insurance Association of Singapore ("GIA") may/are permitted to collect, use, disclose and/or process my personal data/personal information set out in this form and any other personal information provided by me or possessed by my insurer (collectively the "Personal Information") and disclose and transfer such Personal Information to all insurer(s) who have insured vehicle(s) involved in this accident (all insurer(s) who have insured vehicle(s) involved in this accident shall be collectively referred to as the "Insurers"), the Insurers' lawyers/law firms, the Monetary Authority of Singapore and any relevant government agency/authority (such as the police), for the purpose(s) of:
 - (i) processing, handling and/or dealing with my claims including the settlement of the claims and any necessary investigations relating to the claims;
 - (ii) investigating the accident and/or my claims;
 - (iii) carrying out and/or dealing with my instructions or responding to any enquiries by me;
 - (iv) administering my claims (including the mailing of correspondence, statements, invoices, reports or notices to me, which could involve disclosure of certain personal data about me to bring about delivery of the same as well as on the external cover of envelopes/mail packages); and/or
 - (v) complying with applicable law in administering, processing, handling and/or dealing with my claims.
- (collectively the "Purposes")
- (b) all insurer(s) who have insured vehicle(s) involved in this accident and the Insurers' lawyers/law firms, may/are permitted to collect, use, disclose and/or process my Personal Information for one or more of the above Purposes; and
 - (c) my Personal Information may/can be disclosed by any of the Insurers and/or GIA to their third party service providers or agents (including their lawyers/law firms), which may be sited outside of Singapore, for one or more of the above Purposes.



Policyholder's Signature / Date & Time

Driver's Signature
(If driver is not the policyholder)
Date & Time

Witness by Reporting Centre
Personnel

SKETCH PLAN

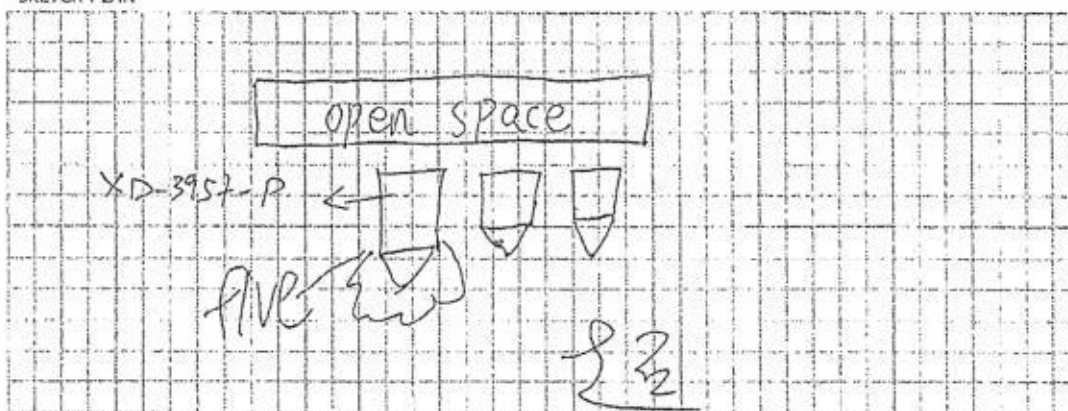

Enquire PARF/COE Rebate for Registered Vehicle

Vehicle Owner Particulars	
Owner ID Type	Company
Owner ID	9403M
Vehicle Details	
Vehicle No.	XD3957P
Vehicle to be Exported	No
Intended De-registration Date	25 Oct 2017
Vehicle Make	MAN
Vehicle Model	TGS18.400 4X2 BLS
Primary Colour	Yellow
Secondary Colour	Red
Manufacturing Year	2008
Engine No.	50521103702113
Chassis No.	WMA06SZZX9M538399
Maximum Power Output	-
Open Market Value	\$120,913.00
Original Registration Date	24 Mar 2010
First Registration Date	24 Mar 2010
Transfer Count	2
Actual ARF Paid	\$6,046.00
Intended PARF Rebate Details	
PARF Eligibility	No
PARF Eligibility Expiry Date	-
PARF Rebate Amount	\$0.00
Intended COE Rebate Details	
COE Expiry Date	23 Mar 2020
COE Category	C - Goods Vehicle & Bus
COE Period(Years)	10
QP Paid	\$23,501.00
COE Rebate Amount	\$5,655.00
Total Rebate Amount	\$5,655.00

The information contained herein is correct as at 25 Oct 2017

74,000
5,655
68,345



redefining / Insurance

LETTER OF UNDERTAKING/ AUTHORIZATION FOR LUMP SUM REPAIR

1. I, [Name] [NRIC] Tan Soon Lai / S8134502C the owner/ authorized driver of vehicle [Registration No.] XD31K7P ("Vehicle") do hereby authorize the [Workshop/Insurer] to repair the Vehicle on a lump sum basis instead of part by part.
2. The [Workshop/Insurer] has explained to me the difference between lump sum repair and part by part repair and the consequences of my authorization for lump sum repair for the Vehicle.
3. I understand that with lump sum repair, the Workshop may use a mixture of genuine parts, original equipment manufacturer (OEM) parts, reconditioned and second hand parts to carry out the repair and I note that the [Workshop/Insurer] will not be furnishing a detailed breakdown of parts or price for such lump sum repair.
4. I am aware that AXA Insurance Pte Ltd ("AXA Insurance") does not encourage lump sum repair as AXA Insurance strongly recommends repairs for vehicles on a part by part basis for transparency reasons. I confirm that I will hold AXA Insurance harmless from any claims arising from the lump sum repair of the Vehicle which I have authorized.
5. * To be applicable where person authorizing is the authorized driver.
I confirm that I have the authority from the owner of the Vehicle to authorize the lump sum repairs and that I have duly notified the owner of the Vehicle of the contents of this Letter of Authorization.

Signed and acknowledged by:



Signature of policyholder/ authorized driver* and company stamp (where applicable)
Date:

Jumari
Executive
Kinetics Automotive Services



Name and signature of workshop personnel including workshop stamp
Date: 21/12/2017

*authorized driver to either the named drivers as per motor insurance policy or in the case of commercial vehicles, permitted drivers who are permitted to drive the insured Vehicle.

VISIT PASS
Immigration Regulations

Name
CHAI WENCHAO



Date of Birth	Sex	Nationality
16-05-1982	M	CHINESE
PRN	Date of Issue	Date of Expiry
G2611459X	13-06-2017	13-06-2019

MULTIPLE JOURNEY VISA ISSUED

YOU ARE TO SURRENDER THIS CARD WHEN IT IS CANCELLED OR HAS EXPIRED, OR WHEN A NEW CARD IS ISSUED TO YOU.



S PASS
Employment of Foreign Manpower Act (Chapter 91A)
Republic of Singapore

Employer
TSL LOGISTICS PRIVATE LIMITED

Division: **SERVICE**



Name	CHAI WENCHAO
Occupation	TRAILER TRUCK DRIVER
S Pass No.	0 76586167
Date of Application	01-06-2017
Date of Issue	13-06-2017
Date of Expiry	13-06-2019

L8020788

YOU ARE LICENSED TO DRIVE VEHICLES IN THE FOLLOWING CLASS(ES)

Class	Description	Valid From	Valid Until	Age
Class 20	MOTORCYCLES NOT EXCEEDING 200 CC	03 Jun 2015	02 Jun 2018	15
Class 2	MOTOR CARS AND MOTOR TRACTORS THE WEIGHT OF WHICH UNLADEN DOES NOT EXCEED 2000 KILOGRAMS	03 Jun 2015	02 Jun 2018	16
Class 6	HEAVY MOTOR CARS AND MOTOR TRACTORS THE WEIGHT OF WHICH UNLADEN EXCEEDS 2000 KILOGRAMS	03 Jun 2015	02 Jun 2018	16

NP 428A

S / No. 9000241623

Licence No: G2611459X

REPUBLIC OF SINGAPORE DRIVING LICENCE

Licence Number: **G 2611459X**

Name: **CHAI WENCHAO**

Birth Date: **16 May 1982**

Issue Date: **03 Jun 2015**

Valid Till: **02/06/2020**

002434408K

SG 50

AXA INSURANCE PTE LTD
8 Shenton Way, #24-01
AXA Tower, Singapore 068811
Customer Service Centre #B1-01
Tel:(65)63387286 Fax:(65)63382522
Website:www.axa.com.sg
GST Registration Number: 199903512M
customer.service@axa.com.sg



Commercial Vehicles TPFT
POLICY SCHEDULE
NEW BUSINESS
Duplicate

POLICY INFORMATION		Policy No. : VCC/P1893524	
Source	: 04437 ALLINK INSURANCE AGENCY		
Insured	: TSL LOGISTICS PTE LTD		
Address	: 194 PANDAN LOOP #05-15 PANTECH BUSINESS HUB SINGAPORE 128383		
Business/Profession	: LOGISTICS <i>Carrying on or engaged in the business or profession last declared and no other for the purpose of this insurance.</i>		
Period of Insurance	: From 11/01/2017 To 23/03/2018 (Both Dates Inclusive)		
Any subsequent period for which the Insured shall pay and the Company shall agree to accept a renewal premium.			
PREMIUM			
Premium After 0.00% NCD	: SGD 2,352.00		
GST 7.00%	: SGD 197.12		
Annual Premium	: SGD 2,516.64		
Total Payable	: SGD 3,013.08		
RISK DETAILS THE MOTOR VEHICLE			
Type of Cover	: Third Party Fire & Theft Only		
Regn. No.	: XD3957P		
Type Of Use	: Commercial Vehicle		
Make/Model	: MAN TGS18.400 4X2 BLS		
Year of Manufacture	: 2008		
Seating Cap. (Excl.)	: 2	Carrying Cap. (Tons)	: 67.11
Driver			
Body Type	: PRIME MOVER		
Engine No.	: S0521103702113		
Chassis No.	: WMA06SZZX9M538399		
Insured's Estimated Market Value	: Market Value At The Time Of Loss (including Accessories and Spare Parts)		
Limitations as to Use	: As specified in Certificate of Insurance		
Hire Purchase	: SINGAPURA FINANCE LTD		
MEMORANDA, CLAUSES, WARRANTIES & ENDORSEMENTS			
Subject to the Memoranda, Clauses, Warranties & Endorsements attached hereto:			
VCC1			
VCC1 - THIRD PARTY FIRE AND THEFT			
THE FOLLOWING ENDORSEMENTS AND CLAUSES ARE APPLICABLE TO THIS POLICY :			
3(q) - Third Party Fire and Theft.			
15 - Hire Purchase (If Applicable)			

Continuation page 1



Policy No. : VCC/P1893524

- 72(b) - Legal Liability of Passengers for Acts of Negligence.
94 - Authorised Driver in the Event of Demise of Insured
(Applicable for Personal Client only).

MEMORANDUM

- General Exception - This policy does not cover vehicles transporting explosives, liquefied petroleum, gases, inflammable liquids and/or chemicals.
- This Policy does not cover against any driver aged below 18 years old and/or without a valid relevant classes of driving licence.
 - This Policy does not cover vehicles working on airport runways (unless specifically mentioned in The policy schedule).
 - Exclusion of Third Party Working Risk
It is hereby understood and agreed that except so far as is necessary to meet the requirements of the Legislation the Company shall be under no liability under Section II of this Policy in respect of liability incurred by the Insured arising out of the operation as a tool of the Motor Vehicle or of plant forming part of such Motor Vehicle or attached thereto.

ADDITIONAL EXCESS

Additional All Claims excess of S\$2,000.00 is applicable for any named /unnamed drivers who:

- a) Is 18 years old to 21 years old and/or
- b) Is 71 years old and above and/or
- c) with driving experience of less than 1 year on the relevant classes of driving license

All other Terms, Exceptions and Conditions remain unchanged.

REPLACEMENT OF NOTIFICATION OF ACCIDENTS CLAUSE

- a) In the event of any accident involving the motor vehicle, irrespective of whether it would give rise to a claim, the Insured shall, together with the motor vehicle, call at the Company's Approved Reporting Centre and report the accident within 24 hours of the accident or by the next working day thereof.
- b) In case of theft or other criminal act which may give rise to a claim under this policy the Insured shall give immediate notice of the occurrence to the Company and the police and co-operate with the Company in securing the conviction of the offender.



Policy No. : VCC/P1893524

- c) Every letter, claim, writ, summons and process shall be notified or forwarded unanswered to the Company immediately upon receipt.

Notice shall also be given to the Company immediately after the Insured or any person claiming to be indemnified shall have knowledge of any impending prosecution, inquest, inquiry, or offer of composition in connection with any such accident and/or occurrence.

This condition in its entirety is a condition precedent to liability and failure to comply with any of the above requirements in respect of any accident and/or occurrence will result in the Insured being denied indemnity under both Section 1 and Section 2 of the Policy in respect of that particular accident and/or occurrence.

Notwithstanding the No Claim Discount provisions set out herein, failure to comply with this condition precedent will additionally result in the Insured losing all or part of his No Claim Discount as set out below.

NCD-COMMERCIAL VEHICLES

Current	Upon Renewal (Non-Reporting)
20%	15%
15%	10%
10%	0%
0%	0%

*The Accident NCD to be applied first before the Non-Reporting NCD.

In the context of this clause the following terms have the following meanings assigned to them:

- *Accident NCD - Refers to the loss of percentage of No Claim Discount entitlement as a result of claims arising from an accident.
- *Non-Reporting NCD - Refers to the loss of percentage of No Claim Discount as a result of not reporting of an accident as set out under the Policy.

AXA INSURANCE PTE LTD

Authorized Signature

IMPORTANT :

This Schedule should be read in conjunction with the Terms and Conditions of the Policy.

Issued by - SGOGOWT on 10/02/2017

AXA INSURANCE PTE LTD
8 Shenton Way, #24-01
AXA Tower, Singapore 068811
Customer Service Centre #B1-01
Tel:(65)63387288 Fax:(65)63382522
Website:www.axa.com.sg
GST Registration Number: 199903512M
customer.service@axa.com.sg



CERTIFICATE OF INSURANCE

■ Motor Vehicles (Third-Party Risks and Compensation) Act, (Chapter 189) ■ Motor Vehicles (Third-Party Risks and Compensation) Rules, 1960 ■ Road Transport Act, 1987 (Malaysia) ■ Motor Vehicles (Third-Party Risks) Rules, 1959 (Malaysia)

CERTIFICATE NO. : VCC/P1893524 Account No. : 04437
Coverage : Third Party Fire & Theft Only
Sum Insured : Market Value At The Time Of Loss
Name of Policy Holder : TSL LOGISTICS PTE LTD
Vehicle Registration No. : XD3957P
Period of Insurance : From 11/01/2017 To 23/03/2018 (Both Dates Inclusive)

PERSONS OR CLASSES OF PERSONS ENTITLED TO DRIVE*

Any person who is driving on the Policyholder's order or with their permission.

Provided that the person driving is permitted in accordance with the licensing or other laws or regulations to drive the Motor Vehicle or has been so permitted and is not disqualified by order of a Court of Law or by reason of any enactment or regulation in that behalf from driving the Motor Vehicle.

LIMITATIONS AS TO USE*

- (a) Use in connection with the Policyholder's business
 - (b) Use for the carriage of passengers (other than for hire or reward) in connection with the Policyholder's business
 - (c) Use for social, domestic and pleasure purposes
- This Policy does not cover
- (a) Use for hire or reward or for racing, pace-making, reliability trial or speed-testing
 - (b) Use whilst drawing a trailer except the towing of any one disabled mechanically propelled vehicle.

(05)

* Limitations rendered inoperative by Section 8 of the Motor Vehicles (Third-Party Risks and Compensation) Act, (Chapter 189) and Section 95 of the Road Transport Act, 1987 (Malaysia), are not to be included under these headings.

I/We hereby certify that the policy to which this Certificate relates is issued in accordance with the provisions of the Motor Vehicles (Third Party Risks and Compensation) Act, (Chapter 189) and Part IV of the Road Transport Act, 1987 (Malaysia).

AXA INSURANCE PTE LTD

Authorized Signature

Issued by - SGOGOWT on 10/02/2017

IMPORTANT :

Policyholders are warned that on the sale of a motor vehicle they must surrender the Certificate of Insurance and the Policy to the insurance company. If the Certificate of Insurance has been lost or destroyed a Statutory Declaration to the effect must be made. Failure to comply with this obligation is an offence under the Motor Vehicle (Third-Party Risks and Compensation Act (Cap. 189)).

The Premium Warranty Clause requires the premium to be paid in full within a specific period failing which there would be no liability under the policy, renewal certificate, covernote and endorsement etc.

ALLINK INSURANCE AGENCY
Blk 153 Bukit Batok Street 11
#02-290 Singapore 650153
Tel : 6567 4722
Fax : 6567 4400

CLAIMS PROCEDURE

A. At the Accident Site

1. Exchange particulars with all parties involved in the accident including name, NRIC/FIN number, telephone number, address and insurance company.
2. Take note of the third party vehicle numbers. Please also take digital photographs (e.g. MMS) of all the third party vehicles involved in the accident and a view of the accident scene. These are to be included in the accident report to be filed later.
3. If there are witnesses, note down their names, NRIC/FIN numbers, telephone numbers and addresses.

B. What to do immediately after

1. Call our Customer Helpline at 1800-8804741 or AXA's Premium Workshops listed below for further advice/assistance.
2. Report the accident to one of AXA's Premium Workshops listed below, with your vehicle (whether damaged or not) within 24 hours of the accident or by the next working day. AXA's Premium Workshops are authorised to assist our policyholders for accident report.
3. Lodge a police report for the following motor accident cases:-
 - injury case;
 - non-injury case involving a government vehicle or damage to government property;
 - non-injury case involving a foreign vehicle;
 - non-injury case involving a pedestrian or cyclist;
 - any accident outside of Singapore.
4. Avoid all unauthorised tow-truck operators or repair workshops.
5. Forward all letters and communications received from third parties concerning the accident to AXA Insurance Pte Ltd.

AXA PREMIUM WORKSHOPS

NORTH ZONE	EAST ZONE
Ah Lim Motor Company 10 Ang Mo Kio Ind. Park 2A, #01-09, AMK Auto Point, Singapore 568047 Tel: 6483 1244	Alpine Motors Pte Ltd (Chevrolet vehicles only) 7 Ubi Close, Singapore 408604 Tel: 6511 3022 (Ext: 203 or 343)
Comfort Delgro Engineering Pte Ltd (Main) 205 Braddell Road, Singapore 579701 Tel: 6383 7118 / 6553 1111	Progressive Automotive Pte Ltd Blk 3022A, Ubi Road 1 #01-45/46, Singapore 408716 Tel: 6741 5336
Hua Hong Pte Ltd 25D Sungei Kadut St 1, Singapore 729332 Tel: 6760 8815 / 6760 0539	SME Motor Pte Ltd 1 Kaki Bukit Ave 6, Blk D, #02-15/16/17/18, AutoBay @ Kaki Bukit, Singapore 417883 Tel: 6747 6106
K. Kim Hin Auto Blk 34 Sin Ming Drive, #01-114, Singapore 575708 Tel: 6452 7018	Glass-Fix Pte Ltd (Main) (Windscreen Only) 52 Ubi Avenue 3, #04-42, Frontier E Park @ Ubi, Singapore 408867 Tel: 6278 0887
S & H Motor Pte Ltd Blk 11 #01-83, Sin Ming Road, Singapore 575655, Tel: 6453 4730	WEST ZONE
Tuffi Tech Pte Ltd (Windscreen Only) Blk 34 Sin Ming Drive, #01-134, Singapore 575708 Tel: 6453 3722	Comfort Delgro Engineering Pte Ltd (Branch) 45 Pandan Road, Singapore 609286 Tel: 6867 6918/ 6262 5065
SOUTH ZONE	ETHOZ Automotive Solutions Ltd (Main) 30 Bukit Batok Crescent, Singapore 658075 Tel: 6654 7501
Charn's Customcraft Blk 1010 Bukit Merah, Lane 3 #01-105 Singapore 159724 Tel: 6271 7054	ETHOZ Automotive Solutions Ltd (Branch) 50 Gul Crescent Singapore 629543 Tel: 6654 7701
Hin Lung Workshop Blk 1008 Bukit Merah Lane 3, #01-20 Singapore 159722 Tel: 6858 3000	Sng Ah Tee Motor & Panel Service Pte Ltd Blk 3 Pioneer Road North #01-18, Singapore 628457 Tel: 6268 6183
MOVA Automotive Blk 1008 Bt. Merah Lane 3 #01-04 Singapore 629792 Tel: 6272 3892	Glass-Fix Pte Ltd (Branch) (Windscreen Only) 1 Bukit Batok Crescent, Wcega Plaza, #08-11, Singapore 658064 Tel: 6570 3906/ 6570 4751

* Commercial Vehicles Above 2 Tons in Weight

AXA INSURANCE PTE LTD
8 Shenton Way, #24-01
AXA Tower, Singapore 068811
Customer Service Centre #B1-01
Tel:(65)63387288 Fax:(65)63382522
Website:www.axa.com.sg
GST Registration Number: 199903512M
customer.service@axa.com.sg



Commercial Vehicles TPFT
TAX INVOICE
NEW BUSINESS
Duplicate

Tax Invoice No : P1893524-00001

POLICY INFORMATION		Policy No. : VCC/P1893524	
Source	: 04437 ALLINK INSURANCE AGENCY		
Insured	: TSL LOGISTICS PTE LTD		
Address	: 194 PANDAN LOOP #05-15 PANTECH BUSINESS HUB SINGAPORE 128383		
Period of Insurance	: From 11/01/2017 To 23/03/2018 (Both Dates Inclusive)		
Transaction No.	: 00001		
Billing Currency	: SGD	Exchange Rate	: 1.0000
Gross Premium Less Discount SGD	Charges SGD	Total Payable SGD	
2,815.96	GST 7.00% 197.12	3,013.08	
<p>Premium Details (SGD)</p> <p>Gross Premium : 2,815.96</p> <p>Total Discount : 0.00</p> <p>Gross Premium less Discount : 2,815.96</p> <p>Note: Discount is only applicable to limited products.</p>			
<p>AXA INSURANCE PTE LTD</p> <p><i>[Signature]</i></p> <p>Authorized Signature</p>			
<p>Important Notice:</p> <p>-----</p> <p>For Individual Policyholders : Premium due must be paid in full before the inception date of the risk otherwise no benefits whatsoever shall be payable by the Company. Please refer to the Payment Before Cover Warranty in the Policy for further details.</p> <p>For all other Policyholders : Premium due must be paid in full within 60 days from the inception date of the risk otherwise this Policy/endorsement is automatically terminated immediately. The Company will be entitled to a pro-rata premium for the period they have been on risk subject to the minimum premium as imposed in the policy. Please refer to the Premium Payment Warranty in the Policy for further details.</p>			
Issued by - SGOGOWT on 10/02/2017			

Note: This document has not been finalised.

LKK Auto Consultants Pte Ltd (Co.Reg.No:199607196R)

51 Ubi Ave 1 #01-25, Paya Ubi Industrial Park

Singapore 408933

Tel: 6256-3561 Fax: 6844-8805 Email: sur@lkkauto.com; assignments@lkkauto.com

To: AXA Insurance Pte Ltd
8 Shenton Way #24-01
AXA Tower
Singapore 068811

From: LKK Auto Consultants Pte Ltd
51 Ubi Ave 1 #01-25
Paya Ubi Industrial Park
Singapore 408933

Attn: Yvonne Ang Ching Ching

Date: 25 Oct 2017

Preliminary Advice

Vehicle No	: XD3957P	Accident Date	: 29/07/2017
Make	: MAN TGA 32.360	Policy No.	: P1893524
Assignment Date	: 24/10/2017	Excess	: S\$0.00
Date of Inspection	: 25/10/2017	Est. Duration of Repair	: 0.00
Inspection At	: SINGAPORE TECHNOLOGIES KINETICS LTD (JALAN BOON LAY) STAR BUILDING, NO 249 JALAN BOON LAY SINGAPORE 619523		

Point of Impact / General Description of Damages

The vehicle sustained impact / damages front portion and parts claimed are consistent to the accident.

Repairer's Estimate (Gross)	:S\$	0.00
Revised Amount	:S\$	0.00
Check Items (Estimated)	:S\$	0.00
Total	:S\$	0.00

Lump Sum Repair :S\$

Total Loss Consideration

New for Old Value	:S\$	
Pre-Accident Value	:S\$	74,000.00
COE / PARF Rebate	:S\$	5,655.00
Salvage Value	:S\$	
Margin for Repair	:S\$	68,345.00

Remarks

- () The vehicle is repairable at our adjusted amount. We have also confirmed excess and policy coverage. Kindly let us have your authorisation.
- () The vehicle is uneconomical to be repaired, you are advised to invite tender for the wreck.
- (X) Other comments : We are pending amendment estimate from repairer.
The delay of submission of the claim is because they did not aware that their policy include fire claim.
We will negotiating on lower repair cost through checking with others repairers.

Note: This document has not been finalised.
LKK Auto Consultants Pte Ltd (Co.Reg.No:199607198R)

51 Ubi Ave 1 #01-25, Paya Ubi Industrial Park

Singapore 408933

Tel: 6256-3561 Fax: 6844-8805 Email: sur@lkkauto.com; assignments@lkkauto.com

To: AXA Insurance Pte Ltd
8 Shenton Way #24-01
AXA Tower
Singapore 068811

From: LKK Auto Consultants Pte Ltd
51 Ubi Ave 1 #01-25
Paya Ubi Industrial Park
Singapore 408933

Attn: Yvonne Ang Ching Ching

Date: 31 Oct 2017

Preliminary Advice

Vehicle No	: XD3957P	Accident Date	: 29/07/2017
Make	: MAN TGA 32.360	Policy No.	: P1893524
Assignment Date	: 24/10/2017	Excess	: S\$0.00
Date of Inspection	: 25/10/2017	Est. Duration of Repair	: 0.00
Inspection At	: SINGAPORE TECHNOLOGIES KINETICS LTD (JALAN BOON LAY) STAR BUILDING, NO 249 JALAN BOON LAY SINGAPORE 619523		

Point of Impact / General Description of Damages

The vehicle sustained impact / damages front portion and parts claimed are consistent to the accident.

Repairer's Estimate (Gross)	:S\$	37,667.19
Revised Amount	:S\$	27,911.11
Check Items (Estimated)	:S\$	5,654.36
Total	:S\$	33,565.47

Lump Sum Repair	:S\$	
-----------------	------	--

Total Loss Consideration

New for Old Value	:S\$	
Pre-Accident Value	:S\$	74,000.00
COE / PARF Rebate	:S\$	5,655.00
Salvage Value	:S\$	
Margin for Repair	:S\$	68,345.00

Remarks

- (X) The vehicle is repairable at our adjusted amount. We have also confirmed excess and policy coverage. Kindly let us have your authorisation.
- () The vehicle is uneconomical to be repaired, you are advised to invite tender for the wreck.
- (X) Other comments : The delay of submission of the claim is because they did not aware that their policy include fire claim.
We are still negotiating on lower repair cost through checking with others repairer. Pending undertaking letter from repairer. Pending investigation report. We have not authorise repair.

Print Received Message

This mail is associated with :

***XD3957P (C0456701)**

OD

Jul 29 2017 1:00PM

[TSL LOGISTICS PTE LTD]

Singapore Technologies Kinetics Ltd

From AXA Insurance Pte Ltd (HQ) (AXA_SG), sent on 05/01/2018 11:53 AM.
To LKK_HQ
Subject Alert - Adj Mandate Approved (S\$26000.00) - XD3957P - Claim Handler: Winnie Ho

Approved:26000.00.

Janice Lee (LKKAUTO)

From: Janice Lee (LKKAUTO)
Sent: Friday, January 05, 2018 1:17 PM
To: jumaribs@stengg.com
Cc: seahnelson@stengg.com; zhengyq@stengg.com; SUR
Subject: XD 3957P AXA OD

Dear Sir,

As instructed by our client, please proceed to repair the insured vehicle **XD 3957P (excess \$0.00/-)**.

If there are any check items or supplementary items please inform our office's Assignment Team at Tel: 6741 8434 to arrange our surveyor for inspection.

All supplementary items and unconfirm items are subjected to further approval from insurance company before completion of the repair.

Our client reserve their right **not to pay** if there is no valid approval obtained before repair.

Thank you.

Best Regards,

Janice Lee (Ms) | Case Handler

LKK Auto Consultants Pte Ltd

Phone: 6256-3561 | email: janicelee@lkkauto.com | fax: 6256-4315

Blk 51, Paya Ubi Industrial Park, Ubi Avenue 1, #02-25 | S(408933)

LKK Auto Consultants Pte Ltd (Co.Reg.No:199607198R)

51 Ubi Ave 1 #01-25, Paya Ubi Industrial Park
Singapore 408933

Tel: 6256-3561 Fax: 6844-8805 Email: sur@lkkauto.com; assignments@lkkauto.com

To: AXA Insurance Pte Ltd
8 Shenton Way #24-01
AXA Tower
Singapore 068811

From: LKK Auto Consultants Pte Ltd
51 Ubi Ave 1 #01-25
Paya Ubi Industrial Park
Singapore 408933

Attn: Winnie Ho

Date: 11 Jun 2018

Preliminary Advice

Vehicle No	: XD3957P	Accident Date	: 29/07/2017
Make	: MAN TGA 32.360	Policy No.	: P1893524
Assignment Date	: 24/10/2017	Excess	: S\$0.00
Date of Inspection	: 25/10/2017	Est. Duration of Repair	: 0.00
Inspection At	: SINGAPORE TECHNOLOGIES KINETICS LTD (JALAN BOON LAY) STAR BUILDING, NO 249 JALAN BOON LAY SINGAPORE 619523		

Point of Impact / General Description of Damages

The vehicle sustained impact / damages front portion and parts claimed are consistent to the accident.

Repairer's Estimate (Gross)	:S\$	42,864.47	(Include Supplementary \$5,197.28)
Revised Amount	:S\$	32,721.76	(Include Supplementary \$5,197.28)
Check Items (Estimated)	:S\$	5,654.39	
Total	:S\$	38,376.15	
Lump Sum Repair	:S\$	30,700.00	Estimated

Total Loss Consideration

New for Old Value	:S\$	
Pre-Accident Value	:S\$	74,000.00
COE / PARF Rebate	:S\$	5,655.00
Salvage Value	:S\$	
Margin for Repair	:S\$	68,345.00

Remarks

- (X) The vehicle is repairable at our adjusted amount. We have also confirmed excess and policy coverage.
- () The vehicle is uneconomical to be repaired, you are advised to invite tender for the wreck.
- () Other comments :

LKK Auto Consultants Pte Ltd (Co.Reg.No:199607198R)

51 Ubi Ave 1 #01-25, Paya Ubi Industrial Park
Singapore 408933

Tel: 6256-3561 Fax: 6844-8805 Email: sur@lkkauto.com; assignments@lkkauto.com

To: AXA Insurance Pte Ltd
8 Shenton Way #24-01
AXA Tower
Singapore 068811

From: LKK Auto Consultants Pte Ltd
51 Ubi Ave 1 #01-25
Paya Ubi Industrial Park
Singapore 408933

Attn: Winnie Ho

Date: 22 Dec 2017

Preliminary Advice

Vehicle No	: XD3957P	Accident Date	: 29/07/2017
Make	: MAN TGA 32.360	Policy No.	: P1893524
Assignment Date	: 24/10/2017	Excess	: S\$0.00
Date of Inspection	: 25/10/2017	Est. Duration of Repair	: 0.00
Inspection At	: SINGAPORE TECHNOLOGIES KINETICS LTD (JALAN BOON LAY) STAR BUILDING, NO 249 JALAN BOON LAY SINGAPORE 619523		

Point of Impact / General Description of Damages

The vehicle sustained impact / damages front portion and parts claimed are consistent to the accident.

Repairer's Estimate (Gross)	:S\$	37,667.19
Revised Amount	:S\$	27,911.11
Check Items (Estimated)	:S\$	5,654.36
Total	:S\$	33,565.47

Lump Sum Repair(Estimate)	:S\$	26,000.00
---------------------------	------	-----------

Total Loss Consideration

New for Old Value	:S\$	
Pre-Accident Value	:S\$	74,000.00
COE / PARF Rebate	:S\$	5,655.00
Salvage Value	:S\$	
Margin for Repair	:S\$	68,345.00

Remarks

- (X) The vehicle is repairable at our adjusted amount. We have also confirmed excess and policy coverage. Kindly let us have your authorisation.
- () The vehicle is uneconomical to be repaired, you are advised to invite tender for the wreck.
- (X) Other comments : We have not authorise repair. Pending for undertaking letter from repairer.

Janice Lee (LKKAuto)

From: jumaribs@stengg.com
Sent: Tuesday, July 17, 2018 10:13 AM
To: Janice Lee (LKKAuto)
Cc: lim.tiamhuat@stengg.com; Rasul (LKKAuto); seahnelson@stengg.com; SUR; yap.kimhong@stengg.com; zhengyq@stengg.com
Subject: RE: XD3957P - Finalized Quotations And Vouchers.

JOB FLOW ON XD3957P	
4 - working days	To remove all interior cabin and exterior componets damaged or effected.Included in removing cabin wire harness.
4 -- working days	To refix/replace damaged or effected componets.Included in re-laying cabin wire harness.
5 - working days	Do up checked and diagnosed on fault codes arises after fixing up wire harness.
2 - working days	To replace damaged components after determining fault codes. Do up reprogramming.
2 - working days	Replaced front windscreen.
2 - working days	Rechecked on vehicle operation and replaced supplementary damaged components.
1 - working days	Do up road test and cleaning of interior/exterior of vehicle.
Total no.of days - 20 Working days.	

Hi Ms Janice,

Good morning.

Attached above is the breakdown on the flow and the no.of days required to complete the repair for XD3957P.

Best regards,
Jumari Sulman

ST Engineering Land Systems Ltd.

Email: jumaribs@stengg.com

We are now  **ST Engineering**
Land Systems

*Formerly known as ST Kinetics

XD 3957P (cabin File)

Type L 06S 00	Pet 30.08	Group 610 0	Chassis No. 1919 WMA06SZZX9M538399	
Table instrument panel r.h. drive vehicle XD 3957P				
Reference No. 81.#0511-0280 - instrument panel with ALU - moldings F99R15/32/37				

610389402

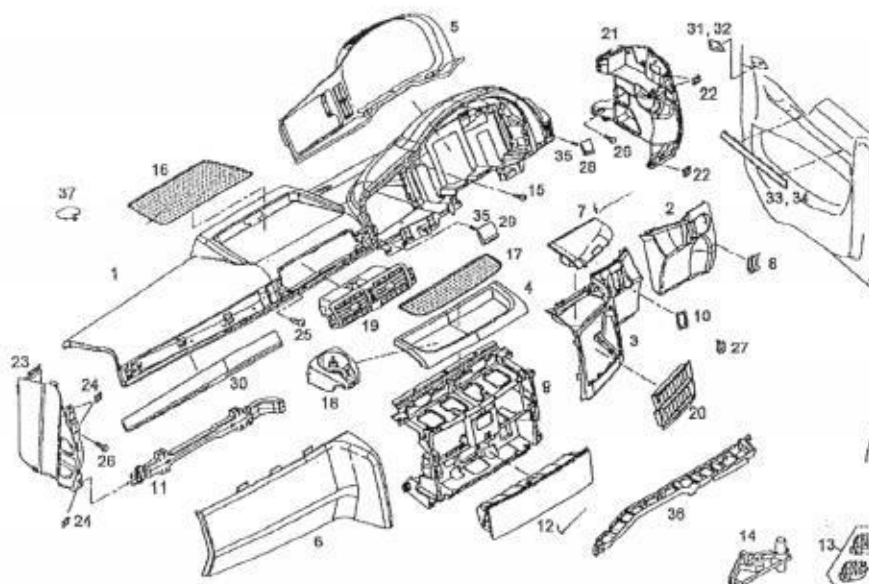

Pos	Part No.	Description	Pat	All	Qty	Unit
1	81.61701-6358	instrument panel upper part F99 R17,34,39	35.12		1	Pcs
1	81.61701-6424	instrument panel assembly upper part			1	Pcs
2	81.61701-6306	instrument panel r.h. drive vehicle on driver's side F99L/R17/34/39/44/45/49			1	Pcs
3	81.61701-6314	instrument panel r.h. drive vehicle on driver's side F99L/R17/34/39/44/45/49	36.16		1	Pcs
3	81.61701-6478	instrument panel r.h. drive vehicle on driver's side			1	Pcs
4	81.61701-6308	instrument panel assembly centre part	36.16		1	Pcs
4	81.61701-6474	instrument panel assembly centre part			1	Pcs
5	81.61701-6312	covering instrument panel r.h. drive vehicle			1	Pcs
6	81.61701-6310	instrument panel co-driver's side r.h. drive vehicle F99L/R17/34/39/44/45/49	36.16		1	Pcs

Type L 06S 00	Pat 30.08	Group 610 0	Chassis No. 1919 WMA06SZZX9M538399
Table Instrument panel r.h. drive vehicle			
Reference No. 81.#0511-0280 - instrument panel with ALU - moldings F99R15/32/37			



Pos	Part No.	Description	Pat	All	Qty	Unit
6	81.61701-6476	instrument panel co-driver's side r.h. drive vehicle F99 L/R 10-58			1	Pcs
7	81.61701-6324	shelf assembly r.h. drive vehicle F99L/R17/34/39/44/45/49	36.16		1	Pcs
7	81.61701-6472	shelf assembly r.h. drive vehicle			1	Pcs
8	81.61710-0024	trim			1	Pcs
9	81.61701-6316	carrier assembly centre part front			1	Pcs
10	81.61701-0326	trim F99 L/R17,34,39,44,45,49			1	Pcs
11	81.61701-6321	carrier assembly co-driver's side lower			1	Pcs
12	81.63740-6018	ashtray assembly l.h. drive vehicle	18.13		1	Pcs
12	81.63740-6029	ashtray assembly narrow			1	Pcs
	81.28901-0018	> socket cigarette lighter			NB	Pcs
	81.28901-0021	> cigarette lighter			NB	Pcs
	81.28901-0020	> socket for bulb cigarette lighter			NB	Pcs
13	81.63740-0070	> sound absorber silicone brake narrow			2	Pcs
14	81.63740-0069	> hinge			1	Pcs
15	06.07223-2605	oval-head self-tapping screw with internal torx ST4,8X16C-Z1-MAN183-B4			21	Pcs
16	81.63715-0040	packing narrow			1	Pcs
17	81.63715-0042	packing			1	Pcs
18	81.63740-6015	beaker holder assembly			1	Pcs
19	81.61950-6071	air outlet assembly			1	Pcs
20	81.61710-0031	decor fairing switch			1	Pcs
21	81.61701-6354	side trim housing - instruments left F99L/R17/34/39/44/45/49			1	Pcs
22	06.13189-0118	> speed nut ST4,8-11X15X2-C67-A2A			3	Pcs
23	81.61701-6355	side trim housing - instruments right F99L/R17/34/39/44/45/49			1	Pcs

Type L 06S 00	Pet 30.08	Group 610 0	Chassis No. 1919 WMA06SZZX9M538399	
Table Instrument panel r.h. drive vehicle				
Reference No. 81,#0511-0280 - instrument panel with ALU - moldings F99R15/32/37				

Pos	Part No.	Description	Pat	All	Qty	Unit
24	06.13189-0118	> speed nut ST4,8-11X15X2-C67-A2A			3	Pcs
25	06.07222-2607	oval-head self-tapping screw with internal torx ST4,8X22C-Z1-MAN183-B1			6	Pcs
26	06.01289-0310	hexagon screw with internal torx M8X20Z1-8.8-T40-MAN183-B1			6	Pcs
27	81.61446-0051	cover			13	Pcs
28	81.61710-5003	molding assembly r.h. drive vehicle aluminium	36.16		1	Pcs
28	81.61710-5038	molding assembly r.h. drive vehicle aluminium			1	Pcs
29	81.61710-5020	molding centre aluminium F99R/17/34/39	36.16		1	Pcs
29	81.61710-5056	molding centre aluminium F99 L/R 10-37, 57/58			1	Pcs
30	81.61710-5024	molding co-driver's side aluminium F99/R17/34/39	36.16		1	Pcs
30	81.61710-5062	molding co-driver's side aluminium F99 L/R 10-39 57/58			1	Pcs
31	81.62681-0013	molding left air outlet	36.16		1	Pcs
31	81.62681-0025	molding left air outlet			1	Pcs
32	81.62681-0014	molding right air outlet	36.16		1	Pcs
32	81.62681-0026	molding right air outlet			1	Pcs
33	81.62681-0009	molding left	36.16		1	Pcs
33	81.62681-0031	molding left			1	Pcs
34	81.62681-0010	molding long right aluminium	36.16		1	Pcs
34	81.62681-0032	molding long right aluminium			1	Pcs
35	81.97103-0009	> clamp			NB	Pcs
36	81.61701-6319	carrier assembly centre part rear			1	Pcs
37	81.61701-0365	trim			1	Pcs