

22/03/2002

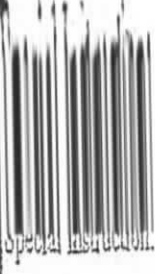
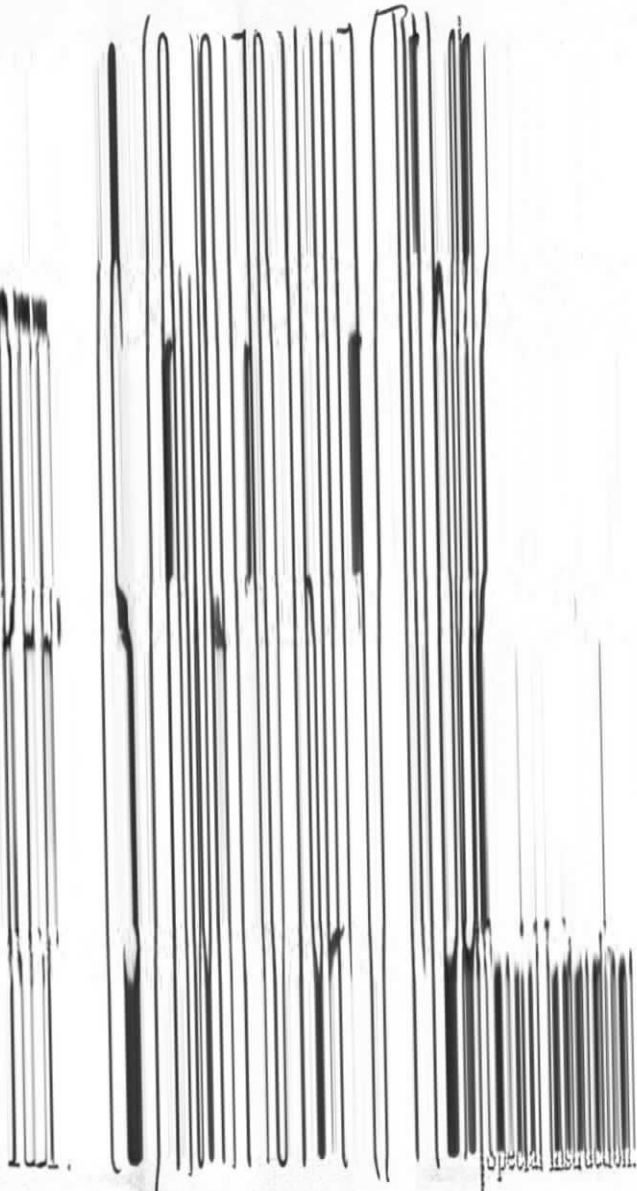

Surveyor: Tan Kah

ASSIGNMENT (Office)

From (Person): Ben Tan of AWAC Date/Time: 24082017

Estimated Cost: _____ Bill to: _____

OD / TP / WS / TP RES / OD RES / EVA / INV / MV / CS

To Inspect Vehicle No: SGG 40 P Insured: GW 3598 T

at Workshop m/s Tan chong Motor Sales Pte Ltd Tel: 6703 8914 / 6466 7711
of 991 Tan Chong

Policy No: AVC 1SB 0089501700 Claim No: NSV1700993 / BT

Sum Insured: _____ Excess: _____

Make of Veh: _____ D.O.A. 19082017
(Client's Record)

CA / REV / REP. / REV 24 HRS 'WP' 24082017 @ 3pm owner waiting H.O.D. Endorsement: _____

Date/Time: _____ Person Contacted: Lawrence Vehicle IN / OUT

Date/Time	Action/Instruction (✓) Estimate
	<u>SGG 40P - X</u>
	<u>GW 3598T - NA / INC 10007993 / 02</u> D.A. 26042010

ASS. REC. BY:

REF:

(S/AWA17016417/Titber)

Special Instruction:

Surveyor: TaukhaASSIGNMENT (Office)From (Person): Ban Tang

of

AWAC

Date/Time:

24082017

Estimated Cost:

Bill to:

OD/TP/WS/TP RES / OD RES / EVA / INV / MV / CSTo Inspect Vehicle No: SGG 40 P

Insured:

GW 3598 T

at Workshop m/s

Tan chong Motor Sales Pte Ltd

Tel:

6703 8914 / 6466 7711

of

991 Tan ChongPolicy No: AVC 1SB 0089501700

Claim No:

NSV1700FFS / BT

Sum Insured:

Excess:

Make of Veh:

(Client's Record)

D.O.A.

19082017CA / REV / REP. / REV 24 HRS 'WP'29082017 @ 3pm owner writing

H.O.D. Endorsement:

Date/Time:

Person Contacted:

Lawrence

Vehicle

IN / OUT

Date/Time	Action/Instruction (✓) Estimate
	<u>SGG 40P - X</u>
	<u>GW 3598T - NA / INC 10007993 / 02</u>
	<u>Part by Part \$1090.71 (Red: 423.80 : 27%)</u>

D.O.A: 26042010

Surveyor: Tan Chong

ASSIGNMENT

From: _____ Date: 24082017

Estimated Cost: _____

OD / TP / WS / TP RES / OD RES / EVA / INV / MVTo Inspect Vehicle No: SGG 40Pat Workshop m/s Tan Chongof 911 Bukit Timah

Insured: _____

Policy No. _____

Claims No. _____

Sum Insured: _____ Excess: _____

(Client's Record)

Make of Veh: Lawrence

(Policy Condition)

Remark: The veh had commenced its
repair at the time of inspection.

N/S	O/S

Bal. or Market Value: _____

IDAC Accident Rpt: _____ Consistent? : Yes or No

GIA / PR Seen: _____ Consistent? : Yes or No

Est. Repairs: _____ days Res.: Yes or No

Lum Sum: _____ % 3 Val.: Yes or No

CA / REV / REP. / 24 HRS

Date: _____ Person Contacted: Lawrence

Vehicle: IN / OUT

Veh No: SGG 40PYr Regn: 2016 MayType: M Car / M.Cycle / Bus / Van / Lorry / Taxi / Prime Mover /

Truck / Trailer or

Make: Nissan Sylphy c.c. 1598Colour: Black A/C: Insured / Std / NI / NASp. Reading: 16454 T/Radio: Insured / Std / NI / NA

Eng/No: _____

C/No: MNTBSAB172 * 002725Gen. Cond: Good / Fair / Poor / BurntSteering: Inorder / Jammed / Leaked / Burnt orBrake: Inorder / Jammed / Leaked / Burnt orModi: Nil / S/Rim / STD A/Rim orTyre Size: F: 195/60R16R: L

BS / DUN / EXNOVA / GY / FS / LIZA / MIC / OHTSU / PIR / SUMI /

TOYO / YOKO or

Front

R/Bal. 6 mmL/Bal. 6 mm

D.O.A. _____

Rear

R/Bal. 6 mmL/Bal. 6 mmD.O.I. 29/8/17Survey held at TC Bukit Timah

Des. of Damages: Frt / Rear / O/S / N/S / U/C / Rooftop or

Frt o/s

The U/C / Chassis frame / Body Structure affected due to collision.

Date / Time Action / Instruction

RECEIVED 01 JUN 2018

Date/Time, File Pass to?

☐

: Preli. Report

1) 11/6 Typist☐

: Final Report

Date/Time, File Return to?

2) _____

Days Of Repair: 3Resurvey No. of Trip: —Survey Fee: 150

Transportation: _____

S + RS, SI

Photos

Others

TOTAL

Report Format: TPLump Sum / I.B.: \$ 1090.71

Add Fee:

☐

Site Insp (\$)

☐

Interview (\$)

☐

Tech. Invs (\$)

☐

Weekend (\$)

150

**LKK Auto Consultants Pte Ltd**

51 Ubi Ave 1 #01-25 Paya Ubi Industrial Park, Singapore 408933

TEL: 6256 3561 FAX: 6256 4315

Reg. No: 199607198R GST Reg. No. 19-9607198-R

Affiliated to Federation Internationale Des Experts En Automobile

ALLIED WORLD ASSURANCE COMPANY LTD

Ref : CS/AWA17016417/T1tb

(SINGAPORE BRANCH)
60 ANSON ROAD, #08-01 (9th FLOOR)
MAPLETREE ANSON
SINGAPORE 079914

Date : 24-08-2017



Code : AWA

1. Policy Particulars :- THIRD PARTY CLAIM

Insured Veh.	GW 3598T	Veh. Inspected	SGG 40P
Policy No.	AVC1SB0089501700	Coverage (\$)	0.00
Claim No.	NSV1700995/BT	Excess (\$)	0.00
Assign From	BEN TANG	Assign Date	24/08/2017

2. Vehicle Particulars & Condition

Make & Model	c.c	0
Engine No.	HIDDEN	Year of Reg.
Chassis No.		Colour
Odometer	-	Steering
Brakes		Modification
General		

3. Conditions of Tyres

	Size	Make	Balance
R/H Front Tyre			mm
L/H Front Tyre			mm
R/H Rear Tyre			mm
L/H Rear Tyre			mm

4. Description of Damages

--

5. General Information

Accident Date	19/08/2017	Inspection Date
Survey held at	TAN CHONG MOTOR SALES PTE LTD 911, BUKIT TIMAH RD, SINGAPORE 589623.	

5a. Remarks
A)THE INSPECTION WAS CONDUCTED ON A"WITHOUT PREJUDICE" BASIS. B)IN ACCORDANCE TO YOUR INSTRUCTIONS, WE HAVE NOT AUTHORISED REPAIRS.

From: Tang, Ben <Ben.Tang@awac.com> on behalf of Motorsurvey <Motorsurvey@awac.com>
Sent: Thursday, 24 August, 2017 10:14 AM
To: LKK (assignments@lkkauto.com) (assignments@lkkauto.com)
Cc: SUR (sur@lkkauto.com); 'lawrenceteo@tanchong.com'
Subject: TP Survey assignment for SGG 40P DOA: 19/08/2017 Our ref: NSV1700995/BT

The above captioned accident refers.

Pursuant to the Practice Directions Amendment No. 1 of 2016 which was effective on 1 April 2016, we like to advise that the third party claimant and us do have consensus in the appointment of **Mr. Mohammad Taufikh/Mr. Mohammed Rasul** as the Single Joint Expert to conduct the pre-repair survey of the third party claimant's vehicle.

Please conduct "THIRD PARTY" survey on without prejudice basis. The information as are follows:

3 rd Party Vehicle	:	SGG 40 P
Insured Vehicle	:	GW 3598 T
Policy Number	:	AVC1SB0089501700
Name of Workshop	:	Tan Chong Motor Sales Pte Ltd
Contact Number	:	6703 8914 / 6466 7711
Person to Contact	:	Lawrence Teo
Estimated Cost of repairs	:	\$ 1,514.51

Regards,
Claims Division

Copy to Tan Chong Motor Sales Pte Ltd via Email.

Note -

- (x)
1. This is to keep you informed that we have appointed surveyors to conduct inspection to your client's damaged vehicle on a without prejudice basis.
 2. **Please keep our motor surveyor and us informed so as to enable the surveyor to conduct a post repair inspection once your client's vehicle has been repaired and before returning the repaired vehicle to your customer.**
 3. Please quantify your client's claim with all relevant supporting documents once your client's vehicle has been repaired.
 4. Please do not construe this appointment of surveyor and our above request as an admission of liability.

Regards
Motor Claims
Claims Group

0430

SINGAPORE ACCIDENT STATEMENT

IMPORTANT NOTICE

1. Please report correctly the details of the accident to speed up the claims process.
2. This Form must be completed by the Policyholder and/or the Authorised Driver.
3. Information provided must be as truthful and accurate as possible. Any wilful misrepresentation or withholding of material facts may allow insurance companies to repudiate policy ability.
4. The issue and acceptance of this Form by insurance companies is not an admission of policy liability on the part of the insurance companies.
5. **Any false reporting may be referred to the Police for investigation.**
6. This report will be forwarded by the insurers of the insurers of the GIA Records Management Centre established by the General Insurance Association of Singapore (GIA) for archiving and that copies of this report will for a fee be made available upon application by interested parties.
7. By the lodgement of this report to the insurers, you hereby consent to the archiving of this report at the centre and to copies of the report being made available aforesaid.

ACCIDENT STATEMENT

Date Of Report	21/08/2017 16:54
Date Of Accident	19/08/2017 14:10
Exact Location Of Accident	BLK 354 CLEMENTI AVE 2
Country/State of Loss	SINGAPORE

DETAILS OF OWN VEHICLE

Vehicle Registration Number	SGG40P
-----------------------------	--------

Insured/Policyholder

Name Of Registered Owner	TEO POH LI
NRIC No	S6844196Z
Email Address	CHERISHBEAUTYHOUSE@HOTMAIL.COM
Mobile Phone No	(LOCAL) +65-93680717
Alternative Phone No	OFFICE-67759612

Vehicle Particulars

Manufacturer	NISSAN
Model	SYLPHY-1.6 (A)

Exact Purpose for which vehicle was being used at time of accident

Are you claiming under your own insurance policy for repair to your vehicle? NO

If No, Please state action to be taken THIRD PARTY

Vehicle Category PRIVATE CAR

Insurance Company

Name of Insurance Company	MSIG INSURANCE (SINGAPORE) PTE. LTD.
Type Of Coverage	COMPREHENSIVE
Fleet Policy	NO
Policy Number	A 28960909 QMY
Cover Note Number	

Driver

Name of Driver	TEO POH LI
NRIC No	S6844196Z
Date Of Birth	13/11/1968
Occupation	INDOOR
Date Of Driving Pass	04/02/1988
Driving Experience	29 YEARS AND 6 MONTHS
Gender	MALE
Mobile Number	(LOCAL) +65-93680717
Fax Number	
Contact Number	OFFICE-67759612
E Mail Address	CHERISHBEAUTYHOUSE@HOTMAIL.COM

Address	40 ENG KONG DRIVE
Postcode	599368
Was driver an employee of the Insured's Company	NO
If No, Relationship of the Driver with the Insured	OWNER
Vehicle Registration Number of Driver's Own Vehicle	-
	-
	-
Insurance Company of Driver's Own Vehicle	-
	-
	-

General Information of the Accident

Type Of Accident	HIT BY FALLEN TREE / OTHER OBJECTS
Weather Conditions	CLEAR
Road Surface	DRY

Other Information

Was any foreign vehicle involved in this accident?	NO
Was any body injured in the Accident?	NO
Was any other material or property damaged?	YES
I have been approached by unknown person(s) soliciting/offering accident claims assistance.	NO
Number of Passengers (Including Driver)	0

Details of Police Action

Was the accident reported to the police?	NO
If Yes, Please state which Police Station	
Was notice of intended Prosecution given?	NO
If Yes, against whom?	

Circumstances of Accident

SEE ATTACHED.

Attachment(s)

Are accident photos available for attachment?	YES
Was there any video captured by Car Camera?	NO
Was there any audio recorded?	NO

DETAILS OF OTHER VEHICLE PROPERTY 1

Vehicle Registration Number	GW3599T
Vehicle Make/Model/Colour	8
Details Of Properties	
Name of Driver	
NRIC/Passport Number	
Contact Number	90495422
Address	
Postcode	
Insurance Company Name	
Nature Of Damage	
No. Of Passenger (Including Driver)	2

Details of Witness

Name	TEO YEW GHEE
Phone Number	91113391
Email Address	

DETAILS OF OTHER VEHICLE PROPERTY 2

Vehicle Registration Number	
Vehicle Make/Model/Colour	

Details Of Properties

Name of Driver

NRIC/Passport Number

Contact Number

Address

Postcode

Insurance Company Name

Nature Of Damage

No. Of Passenger (Including Driver)

Details of Witness

Name

AZRINO

Phone Number

81818403

Email Address

SKETCH PLAN

IMPORTANT NOTICE

1. Please report correctly the details of the accident to speed up the claims process.
2. This Form must be completed by the Policyholder and/or the Authorised Driver.
3. Information provided must be as truthful and accurate as possible. Any wilful misrepresentation or withholding of material facts may allow insurance companies to repudiate policy liability.
4. The issue and acceptance of this Form by insurance companies is not an admission of policy liability on the part of the insurance companies.
5. Any false reporting may be referred to the Police for investigation.
6. The report will be forwarded by the insurers of the GIA Records Management Centre established by the General Insurance Association of Singapore (GIA) for archiving and that copies of this report will for a fee be made available upon application by interested parties.
7. By the lodgement of this report to the insurers, you hereby consent to the archiving of this report at the centre and to copies of the report being made available aforesaid.
8. **Consent under the Personal Data Protection Act (PDPA)**
I understand, acknowledge, agree and consent that:
(a) My insurer, my workshop and the General Insurance Association of Singapore ("GIA") may/are permitted to collect, use, disclose and/or process my personal data/personal information set out in this [form] and any other personal information provided by me or possessed by my insurer (collectively the "Personal Information") and disclose and transfer such Personal Information to all insurer(s) who have insured vehicle(s) involved in this accident (all insurer(s) who have insured vehicle(s) involved in this accident shall be collectively referred to as the "Insurers"), the Insurers' lawyers/law firms, the Monetary Authority of Singapore and any relevant government agency/authority (such as the police), for the purpose(s) of:
(i) processing, handling and/or dealing with my claims including the settlement of the claims and any necessary investigations relating to the claims;
(ii) investigating the accident and/or my claims;
(iii) carrying out and/or dealing with my instructions or responding to any enquiries by me;
(iv) administering my claims (including the mailing of correspondence, statements, invoices, reports or notices to me, which could involve disclosure of certain personal data about me to bring about delivery of the same as well as on the external cover of envelopes/mail packages); and/or
(v) complying with applicable law in administering, processing, handling and/or dealing with my claims.
(collectively the "Purposes")
(b) all insurer(s) who have insured vehicle(s) involved in this accident and the Insurers' lawyers/law firms, may/are permitted to collect, use, disclose and/or process my Personal Information for one or more of the above Purposes; and
(c) my Personal Information may/can be disclosed by any of the Insurers and/or GIA to their third party service providers or agents (including their lawyers/law firms), which may be sited outside of Singapore, for one or more of the above Purposes.

Policyholder's Signature / Date & Time

Sketch Plan

Driver's Signature (If driver is not the policyholder) / Date & Time

Witnessed by Reporting Centre Personnel

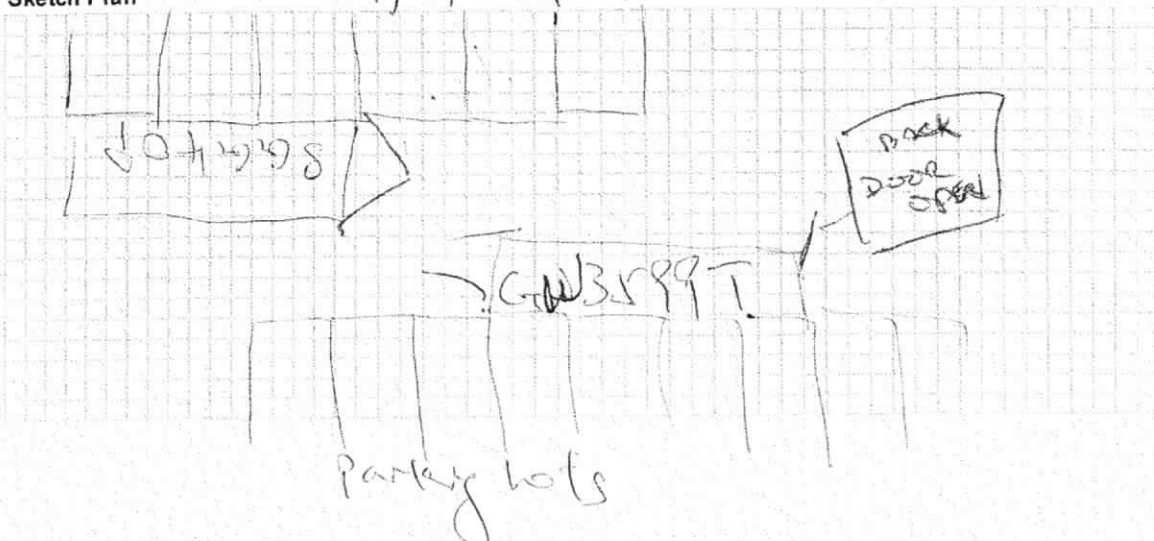



MSIG

MSIG Insurance (Singapore) Pte. Ltd.
4 Shenton Way, # 21-01, SGX Centre 2, Singapore 068807
Tel +65 6827 7888, Fax +65 6827 7800
Co. Reg. No. 200412212G GST Reg. No. 20-0412212G

Certificate of Insurance

ROAD TRANSPORT ACT 1987 (MALAYSIA)
THE MOTOR VEHICLES (THIRD-PARTY RISKS) RULES, 1959 (FEDERATION OF MALAYSIA)
THE MOTOR VEHICLES (THIRD-PARTY RISKS AND COMPENSATION) ACT (CAP. 189 OF THE REVISED EDITION)
(REPUBLIC OF SINGAPORE)
THE MOTOR VEHICLES (THIRD-PARTY RISK AND COMPENSATION) RULES, 1996 EDITION (REPUBLIC OF SINGAPORE)
OR ANY AMENDMENT, ACT OR ACTS PASSED IN SUBSTITUTION THEREOF.

Form M.X.1
Individual Ownership

MOTOR MAX PLUS
Comprehensive

Certificate No. A 28960909 QMY

Excess : SGD500

Windscreen Excess : SGD100

1. Index Mark and Registration Number of Vehicle
SGG40P

2. Name of Policyholder
Teo Poh Li

3. Effective Date of the Commencement of Insurance for the purposes of the Act
30/05/2017

4. Date of Expiry of Insurance
29/05/2018

5. Persons or Classes of Persons entitled to drive*

Teo Poh Li

Any other person provided he is driving on the Policyholder's order or with the Policyholder's permission.

* Provided that the person driving is permitted in accordance with the licensing or other laws or laws or regulations to drive the Motor Vehicle or has been so permitted and is not disqualified by order of a Court of Law or by reason of any enactment or regulation in that behalf from driving the Motor Vehicle.

6. Limitations as to use*

Use only for social domestic and pleasure purposes and for the Policyholder's business.
The Policy does not cover use for hire or reward racing pace-making reliability trial speed-testing the carriage of goods other than samples in connection with any trade or business or use for any purpose in connection with the Motor Trade.

* Limitations rendered inoperative by Section 8 of the Motor Vehicles (Third-Party Risks and Compensation) Act (Chapter 189) and Section 95 of the Road Transport Act, 1987 (Malaysia), are not to be included under these headings.

PLEASE NOTE ALL CLAIMS RELATED REPAIR CAN BE CARRIED OUT AT ANY WORKSHOP OF YOUR CHOICE OR AT ANY MSIG AUTHORISED WORKSHOP LISTED IN THE ATTACHED.

This Certificate is not transferable to a new owner of the vehicle. If for any reason the Policy is terminated during its currency, the Certificate must be returned to the Insurer within 7 days of the termination or if the Certificate has been lost or destroyed, a Statutory Declaration to that effect must be made. Failure to comply with this obligation is an offence under the Motor Vehicles (Third-Party Risks and Compensation) Act (Cap. 189).

I/WE HEREBY CERTIFY that the Policy to which this Certificate relates is issued in accordance with the provisions of the Motor Vehicles (Third-Party Risks and Compensation) Act (Chapter 189) and Part IV of the Road Transport Act, 1987 (Malaysia) or any Amendment, Act or Acts passed in substitution thereof.

MSIG Insurance (Singapore) Pte. Ltd.

Approved Insurers

for Chief Executive Officer

REPUBLIC OF SINGAPORE
IDENTITY CARD NO. S6844196Z



Name



TEO POH LI

張寶莉

Race

CHINESE

Date of Birth

13-11-1968

Country of Birth

SINGAPORE

Sex

F

S6844196Z

REPUBLIC OF SINGAPORE DRIVING LICENCE

Licence Number: S6844196Z

Name

TEO POH LI

Birth Date: 13 Nov 1968

Issue Date: 14 Feb 2003



000196344E

1251210



NRIC No. S6844196Z



Blood Group

Date of issue

O+

05-09-1993

Address

40 ENG KONG DRIVE SAVOY PARK
SINGAPORE 598368

NRIC No:

S6844196Z

Date:

22-07-1998

No:

2647658

Class 3 Motor Cars and Motor Tractors the weight of which unladen does not exceed 2500 kilograms

PASS DATE

04 Feb 1988

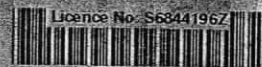

Licence No. S6844196Z

NP 428A



RECORDS MANAGEMENT CENTRE

**GENERAL INSURANCE ASSOCIATION OF SINGAPORE
RECORDS MANAGEMENT CENTRE**

6 Raffles Quay #18-00, Singapore 048580

Phone: +65 6224 0010 Fax: +65 6224 0030

Operating Hours: Monday to Friday 9am to 5pm

GST Registration No: M400017735

Third Party Insurer Enquiry

Our Ref No: GR-17-123182

Date of Request: 21/08/2017

Your Ref No: Online Purchase

Tan Chong Motor Sales Pte Ltd
911, Bukit Timah Road
Singapore 589622

Dear Sir/Madam,

Enquiry Date 21/08/2017

Enquiry By Eric Koh

TP Vehicle No. GW3598T

Accident Date 19/08/2017

Enquiry Result

TP Vehicle No.	Insurer	Period of Insurance	Insurer Tel. No.
GW3598T	Allied World Assurance Company, Ltd	10/06/2017-09/06/2018	62201188

Thank You.

The images provided to you are taken from the original reports forwarded to the centre by the members of the General Insurance Association of Singapore and we take no responsibility for their accuracy or contents and shall be under no liability whatsoever for any loss or damage arising out of or in connection with the reports or their images.

This is a computer generated document and requires no signature.



RECORDS MANAGEMENT CENTRE

**GENERAL INSURANCE ASSOCIATION OF SINGAPORE
RECORDS MANAGEMENT CENTRE**

6 Raffles Quay #18-00, Singapore 048580

Phone: +65 6224 0010 Fax: +65 6224 0030

Operating Hours: Monday to Friday 9am to 5pm

GST Registration No: M400017735

TAX INVOICE

Our Ref No: GR-17-123182

Date of Request: 21/08/2017

Your Ref No: Online Purchase

Tan Chong Motor Sales Pte Ltd
911, Bukit Timah Road
Singapore 589622

Dear Sir/Madam,

Enquiry Date 21/08/2017

Enquiry By Eric Koh

TP Vehicle No. GW3598T

Accident Date 19/08/2017

DESCRIPTION	AMOUNT (S\$)
TP Insurer Enquiry	1.87
GST Amount	0.13
Total Amount Due (GST Inclusive)	2.00

Thank You.

This is a computer generated document and requires no signature.

For GIARMC Official use:

Date:

☒ GIRO ☐ Cash ☐ Cheque

TAN CHONG MOTOR SALES PTE. LTD.
911, BUKIT TIMAH ROAD
SINGAPORE 589623

ESTIMATE : ACCIDENT/BODY REPAIRS
WORKSHOP : BUKIT TIMAH
CONTACT NO : 4694091
REFERENCE : INS/IC/LAW/0450/2017
DATE : 23-AUG-2017

ALLIED WORLD ASSURANCE COMPANY LTD
60 ANSON RD #09-01
MAPLETREE ANSON
S(079914)
TEL : 62201188
FAX : 64230864
ATTN : MOTOR CLAIM MANAGER

OWNER'S NAME : TEO POH LI
ADDRESS : 40 ENG KONG DRIVE SAVOY PARK
S(599368)
TELEPHONE NO : 93680717/67759612

TYPE OF CLAIM : THIRD PARTY CLAIM
POLICY NO : TP-GW3598T
VEHICLE NO : SGG40P
MODEL CODE : BDTARCZB17EWA----A
MODEL/YEAR : NISSAN SYLPHY 1.6 (CVT)
ENGINE NO : HR16989257B -SSS
CHASSIS NO : MNTBBAB17Z0027205
MILEAGE : 1 KM
DATE IN : 23/08/2017
LIABILITY : 0.00
EXCESS CLAUSE : 0.00
ESTIMATE BY : LAWRENCE
ACCIDENT DATE : 19/08/2017

DIRECT SETTLEMENT

OWNER CLAIMING LOSS OF USE / RENTAL

CAR AT WORKSHOP / CAR NOT AT WORKSHOP

KINDLY REVERT TO ME ASAP

EMAIL : lawrenceteo@tanchong.com

H/P : 94568832

FAX : 64697472

Tanpin 97495749

29/8/17 @ 1530

Resurvey after repair
sur @ lkkanto.com

3 days

30/8/17

TAN CHONG MOTOR SALES PTE. LTD.
BUKIT TIMAH W/SHOP
SERVICE DEPARTMENT

ESTIMATED LABOUR CHARGES FOR ACCIDENT VEHICLE REGN NO SGG40P

S/NO	JOB CODE	NATURE OF JOB	ESTIMATED CHARGES	SURVEYOR'S RECOMMENDATION
1	ZZ/001	REPAIR FRONT BUMPER,RH FRONT FENDER	796 800.00	585 ✓
2	ZZ/002	S/PAINT FRONT BUMPER AND RH FRONT FENDER	280 600.00	500 ✓
3	ZZ/003	LTA SEARCH	1.87	✓
TOTAL LABOUR CHARGES			1401.87	

TAN CHONG MOTOR SALES PTE. LTD.

BUKIT TIMAH W/SHOP

SERVICE DEPARTMENT

MATERIAL LIST FOR ACCIDENT VEHICLE REGN NO SGG40P

		DAMAGED PARTS & PRICES		
S/NO PARTS DESCRIPTION	PARTS NUMBER	NETT	LIST	S/NETT REMARKS
1 SUNDRIES	NPN			100.00 <i>3 X m</i>
2 CLIP BUMPER \$1.20 EA X 02	01553-10501	2.40 <i>rec</i>		
3 GROMMET BUMPER \$1.20 EA X 02	01281-01431	2.40 <i>rec</i>		
4 BRKT BMPR RH	62224-3ST1A			8.80 <i>? X m</i>
SUB TOTAL		4.80	0.00	108.80
LESS DISCOUNT (NETT-20.00%, LIST-30.00%, S/NETT-.00%)		0.96	0.00	0.00
GRAND TOTAL		3.84	0.00	108.80
OVERALL TOTAL		112.64		

LEGEND: REMARKS(OK) = APPROVED, REMARKS(X) = NOT APPROVED

TAN CHONG MOTOR SALES PTE. LTD.

BUKIT TIMAH W/SHOP

SERVICE DEPARTMENT

SUMMARY OF ESTIMATE FOR VEHICLE REGN NO SGG40P

TOTAL LABOUR CHARGES	1401.87
TOTAL SPARE PARTS CHARGES	112.64

GRAND TOTAL	1514.51 *

* All charges do2 not include GST.

SURVEYOR'S PARTICULARS

NAME	:	
SURVEYED DATE	:	
AUTHORIZED DATE	:	
EXCESS CLAUSE	:	0.00
LIABILITY	:	0.00
REMARKS	:	

PLS NOTE : This estimate is based on visual inspection of the affected vehicle. Should we require further labour charges & spare parts in the process of repairs, we shall inform you accordingly.

TAN CHONG MOTOR SALES PTE. LTD.
911, BUKIT TIMAH ROAD
SINGAPORE 589623

FINALIZED : ACCIDENT/BODY REPAIRS
WORKSHOP : BUKIT TIMAH
CONTACT NO : 4694091
REFERENCE : INS/IC/LAW/0450/2017
DATE : 23-AUG-2017

ALLIED WORLD ASSURANCE COMPANY LTD
60 ANSON RD #09-01
MAPLETREE ANSON
S(079914)
TEL : 62201188
FAX : 64230864
ATTN : MOTOR CLAIM MANAGER

OWNER'S NAME : TEO POH LI
ADDRESS : 40 ENG KONG DRIVE SAVOY PARK
S(599368)
TELEPHONE NO : 93680717/67759612

TYPE OF CLAIM : THIRD PARTY CLAIM
POLICY NO : TP-GW3598T
VEHICLE NO : SGG40P
MODEL CODE : BDTARCZB17EWA-----A
MODEL/YEAR : NISSAN SYLPHY 1.6 (CVT)
ENGINE NO : HR16989257B -SSS
CHASSIS NO : MNTBBAB17Z0027205
MILEAGE : 1 KM
DATE IN : 23/08/2017
LIABILITY : 0.00
EXCESS CLAUSE : 0.00
ESTIMATE BY : LAWRENCE
ACCIDENT DATE : 19/08/2017

Handwritten notes:
Teo Poh Li
Call
DLS
Rental
\$100/day X 23
= \$300 + GST
= \$321/-

TAN CHONG MOTOR SALES PTE. LTD.

BUKIT TIMAH W/SHOP

SERVICE DEPARTMENT

LABOUR CHARGES FOR ACCIDENT VEHICLE REGN NO SGG40P

S/NO	JOB CODE	NATURE OF JOB	ESTIMATED CHARGES	SURVEYOR'S RECOMMENDATION
1	ZZ/001	REPAIR FRONT BUMPER, RH FRONT FENDER	800.00	585.00 ✓
2	ZZ/002	S/PAINT FRONT BUMPER AND RH FRONT FENDER	600.00	500.00 ✓
3	ZZ/003	LTA SEARCH	1.87	1.87 ✓
TOTAL LABOUR CHARGES			1401.87	1086.87

TAN CHONG MOTOR SALES PTE. LTD.

BUKIT TIMAH W/SHOP

SERVICE DEPARTMENT

MATERIAL LIST FOR ACCIDENT VEHICLE REGN NO SGG40P

		DAMAGED PARTS & PRICES			REMARKS
S/NO	PARTS DESCRIPTION	PARTS NUMBER	NETT	LIST	
1	SUNDRIES	NPN			100.00 X
2	CLIP BUMPER \$1.20 EA X 02	01553-10501	2.40		OK
3	GROMMET BUMPER \$1.20 EA X 02	01281-01431	2.40		OK
4	BRKT BMPR RH	62224-3ST1A			8.80 X
SUB TOTAL			4.80	0.00	0.00
LESS DISCOUNT (NETT-20.00%, LIST-30.00%, S/NETT-.00%)			0.96	0.00	0.00
GRAND TOTAL			3.84	0.00	0.00
OVERALL TOTAL			3.84		

LEGEND: REMARKS(OK) = APPROVED, REMARKS(X) = NOT APPROVED

TAN CHONG MOTOR SALES PTE. LTD.

911, BUKIT TIMAH ROAD

SINGAPORE 589623

SUMMARY OF OVERALL CHARGES FOR VEHICLE REGN NO SGG40P

NETT ITEM	4.80
LESS 20.00%)	-0.96
NETT AMOUNT	3.84
LIST ITEM	0.00
LESS 30.00%)	0.00
LIST AMOUNT	0.00
SPECIAL NETT ITEM	0.00
LESS .00%)	0.00
SPECIAL NETT AMOUNT	0.00
TOTAL LABOUR CHARGES	1086.87
TOTAL SPARE PARTS CHARGES	3.84
TOTAL CHARGES	1090.71
ADD 7 % GST	76.35
GRAND TOTAL	1167.06



LKK Auto Consultants Pte Ltd

51 Ubi Ave 1 #01-25 Paya Ubi Industrial Park, Singapore 408933

TEL: 6256 3561 FAX: 6256 4315

Reg. No: 199607198R GST Reg. No. 19-9607198-R

Affiliated to Federation Internationale Des Experts En Automobile			
ALLIED WORLD ASSURANCE COMPANY LTD		Ref : CS/AWA17016417/T1tbe2	
(SINGAPORE BRANCH) 60 ANSON ROAD ,#08-01 (9th FLOOR) MAPLETREE ANSON SINGAPORE 079914		Date : 05-06-2018	
Code : AWA			
1. Policy Particulars :- THIRD PARTY CLAIM			
Insured Veh.	GW 3598T	Veh. Inspected	SGG 40P
Policy No.	AVC1SB0089501700	Coverage (\$)	0.00
Claim No.	NSV1700995/BT	Excess (\$)	0.00
Assign From	BEN TANG	Assign Date	24/08/2017
2. Vehicle Particulars & Condition			
Make & Model	NISSAN SYLPHY	c.c	1598
Engine No.	HIDDEN	Year of Reg.	2016
Chassis No.	MNTBBAB17Z0027205	Colour	BLACK
Odometer	16454	Steering	IN ORDER
Brakes	IN ORDER	Modification	SPORTS RIM
General	GOOD		
3. Conditions of Tyres			
	Size	Make	Balance
R/H Front Tyre	195/60 R16	BRIDGESTONE	6 mm
L/H Front Tyre	195/60 R16	BRIDGESTONE	6 mm
R/H Rear Tyre	195/60 R16	BRIDGESTONE	6 mm
L/H Rear Tyre	195/60 R16	BRIDGESTONE	6 mm
4. Description of Damages			
THE VEHICLE SUSTAINED DAMAGES AT THE FRONT O/S PORTION. DAMAGES SEE DETAILS.			
5. General Information			
Accident Date	19/08/2017	Inspection Date	29/08/2017
Survey held at	TAN CHONG MOTOR SALES PTE LTD 911, BUKIT TIMAH RD, SINGAPORE 589623.		
5a. Remarks			
A)THE INSPECTION WAS CONDUCTED ON A"WITHOUT PREJUDICE" BASIS. B)IN ACCORDANCE TO YOUR INSTRUCTIONS, WE HAVE NOT AUTHORISED REPAIRS.			
5b. Estimate Days of Repair			
ESTIMATED NORMAL PERIOD FOR REPAIR:		3 Working Days	



LKK Auto Consultants Pte Ltd

51 Ubi Ave 1 #01-25 Paya Ubi Industrial Park, Singapore 408933

TEL: 6256 3561 FAX: 6256 4315

Reg. No: 199607198R GST Reg. No. 19-9607198-R

Page No.:1 of 1

ADJUSTMENT ON REPAIR COST FOR VEHICLE NO. SGG 40P

Qty	Description of Parts	Condition	Estimate By Workshop (\$)	Our Adjusted (\$)
	<u>REPLACEMENT OF PARTS</u>			
2	CLIP BUMPER @\$1.20 (N)	NECESSARY	2.40	2.40
2	GROMMET BUMPER @\$1.20 (N)	NECESSARY	2.40	2.40
	LESS 20% DISCOUNT		-0.96	-0.96
			3.84	3.84
	<u>SPECIAL NETT ITEMS</u>			
1	SUNDRIES (SN)	NOT NECESSARY	100.00	-
1	BRKT BMPR RH (SN)	NOT NECESSARY	8.80	-
			108.80	-
	<u>LABOUR</u>			
	REPAIR FRONT BUMPER, RH FRONT FENDER.		800.00	585.00
	S/PAINT FRONT BUMPER AND RH FRONT FENDER.		600.00	500.00
	LTA SEARCH.		1.87	1.87
			1,401.87	1,086.87
	GRAND TOTAL		1,514.51	1,090.71
	RECOMMENDED COST OF REPAIRS			1,090.71

Report Ref No. CS/AWA17016417/T1tbe2

MOHAMAD TAUFIKH

M.MATAI, AMSAE-A

Automotive Assessor

ADRIAN LING WAI PING

B.Eng,AMSOE,AMIRTE,AMSAE-A,M.MATAI

Licensed Appraiser

DISCLAIMER OF LIABILITY TO THIRD PARTIES:- This Report is made solely for the use and benefit of the Client named on the front page of this Report.

No liability of responsibility whatsoever, in contract or tort, is accepted to any third party who may rely on the Report wholly or in part. Any third party acting or relying on this Report, in whole or in part, does so at his or her own risk.