

SINGAPORE ACCIDENT STATEMENT

IMPORTANT NOTICE

1. Please report correctly the details of the accident to speed up the claims process.
2. This Form must be completed by the Policyholder and/or the Actual Driver
3. Information provided must be as truthful and accurate as possible. Any wilful misrepresentation or withholding of material facts may allow insurance companies to repudiate policy liability.
4. The issue and acceptance of this Form by insurance companies is not an admission of policy liability on the part of the insurance companies.
5. **Any false reporting may be referred to the Police for investigation.**
6. This report will be forwarded by the insurers of the GIA Records Management Centre established by the General Insurance Association of Singapore (GIA) for archiving and that copies of this report will, for a fee, be made available upon application by interested parties.
7. By the lodgement of this report to the insurers, you hereby consent to the archiving of this report at the centre and to copies of the report being made available aforesaid.

ACCIDENT STATEMENT

Date of First Submission	01/11/2024 14:19 (SGT)
Reported by	Both Policyholder and Actual Driver
Date of Accident	31/10/2024 15:35 (SGT)
Exact Location of Accident	128 Yishun Street 11, Singapore 760128
Additional Location Information	CARPARK
Country/State of Loss	Singapore

DETAILS OF OWN VEHICLE

Vehicle Registration Number	SMK2857U
-----------------------------------	----------

INSURED/POLICYHOLDER

Is company?	Yes
Name Of Registered Owner	GW AUTOMOTIVE GROUP PTE LTD
Company Reg No	202403130E
Email Address	ADMIN@GWAUTO.COM.SG
Mobile Phone No	(Phone) +65-93834108
Alternative Phone No	-

VEHICLE PARTICULARS

Manufacturer	Toyota
Model	Voxy
Variant	-
Exact purpose for which vehicle was being used at time of accident	Private use
Are you claiming under your own insurance policy for repair to your vehicle?	No - Claiming third party
Vehicle Category	Private car
Transmission	Auto
CC	1800
Vehicle Fuel	-
First Registration Date	-
Chassis no	-
Effective Date/Time of Ownership	-

INSURANCE COMPANY

Name of Insurance Company	Income Insurance Limited
Policy Number / Cover Note Number	5144447053-000031

DRIVER

Name of Driver	CHEN SHOUKUI
NRIC No	S8473174I
Date Of Birth	21/09/1984
Occupation	Outdoor
Driving Pass Date	23/12/2009
Driving License Pass Class	3
Driving License Validity	Valid
Driving experience	14 YEARS AND 10 MONTHS
Gender	Male
Mobile Number	(Phone) +65-93842764
Alt. Phone Number	-
Email Address	ADMIN@GWAUTO.COM.SG
Address	BLK 433B NORTHSHORE DRIVE #10-908
Address complement	-
Postcode	822433
Is the driver the policyholder?	No
If No, Relationship of the Driver with the Insured	Hirer
Does Driver Own Other Vehicles?	No
Vehicle Registration Number of Other Vehicle Owned by Driver	-
Insurance Company of Other Vehicle Owned by Driver	-

GENERAL INFORMATION OF THE ACCIDENT

Type of Accident	Collision - Head to Rear
Weather Conditions	Clear
Road Surface	Dry

OTHER INFORMATION

Was any foreign vehicle involved in the accident?	No
Number of vehicles involved in the accident	2
Was anybody injured in the Accident?	No
Was any injured conveyed to hospital by ambulance?	-
Was any other vehicle or property damaged?	Yes
Number of Passengers (Including Driver)	1
Has the driver been approached by unknown person(s) soliciting/offering accident claims assistance?	No
Translator's name	-
Translator's ID	-
Translator's phone number	-
Translator's email	-
Original language used in the statement	-

DETAILS OF POLICE ACTION

Was the accident reported to the police?	No
Was notice of intended Prosecution given?	No
If yes, against whom?	-

CIRCUMSTANCES OF ACCIDENT

ON 31/10/2024 AT ABOUT 3.35PM, I WAS DRIVING MY CAR A (SMK2857U) IN THE PUBLIC CARPARK NEAR BLK 128 YISHUN STREET 11, ON THE WAY TO PICK UP MY PASSENGER. IN FRONT OF MY CAR, WAS A TAXI (VEHICLE B-SHC7574D), THAT SUDDENLY STOPPED AND THEN REVERSE INTO THE PARKING LOT ON THE RIGHT WITHOUT SIGNAL. I STOPPED MY CAR AS WELL BUT THE TAXI CONTINUED TO REVERSE AND THE LEFT SIDE OF THE TAXI THEN HIT ONTO THE FRONT OF MY CAR. (HEAD TO SIDE COLLISION)

ATTACHMENT(S)

Are accident photos available for attachment?	Yes
Was there any video captured by Car Camera?	Yes

DETAILS OF OTHER VEHICLE PROPERTY 1



Vehicle Registration Number	SHC7574D
Vehicle Manufacturer	-
Vehicle Model	-
Vehicle Variant	-
Vehicle Colour	-
Vehicle Category	Taxi
Name of Driver	-
Contact Number	-
Address	-
Address complement	-
Postcode	-
Insurance Company Name	-
Nature Of Damage	-
Details of property damaged in accident	VEHICLE B
No. Of Passenger (Including Driver)	-

SKETCH PLAN

IMPORTANT NOTICE

1. Please report correctly the details of the accident to speed up the claims process.
2. This Form must be completed by the Policyholder and/or the Actual Driver.
3. Information provided must be as truthful and accurate as possible. Any wilful misrepresentation or withholding of material facts may allow insurance companies to repudiate policy liability.
4. The issue and acceptance of this Form by insurance companies is not an admission of policy liability on the part of the insurance companies.
5. **Any false reporting may be referred to the Traffic Police Department for investigation.**
6. This report will be forwarded by the insurers to the GIA Records Management Centre established by the General Insurance Association of Singapore (GIA) for archiving and that copies of this report will for a fee be made available upon application by interested parties.
7. By the lodgement of this report to the insurers, you hereby consent to the archiving of this report at the centre and to copies of the report being made available aforesaid.

8. Consent under the Personal Data Protection Act (PDPA)

I understand, acknowledge, agree and consent that:

- (a) My insurer, my workshop and the General Insurance Association of Singapore ("GIA") may/are permitted to collect, use, disclose and/or process my personal data/personal information set out in this [form] and any other personal information provided by me or possessed by my insurer (collectively the "Personal Information") and disclose and transfer such Personal Information to all insurer(s) who have insured vehicle(s) involved in this accident (all insurer(s) who have insured vehicle(s) involved in this accident shall be collectively referred to as the "Insurers"), the Insurers' lawyers/law firms, the Monetary Authority of Singapore and any relevant government agency/authority (such as the police), for the purpose(s) of:
- (i) processing, handling and/or dealing with my claims including the settlement of the claims and any necessary investigations relating to the claims;
 - (ii) investigating the accident and/or my claims;
 - (iii) carrying out and/or dealing with my instructions or responding to any enquiries by me;
 - (iv) administering my claims (including the mailing of correspondence, statements, invoices, reports or notices to me, which could involve disclosure of certain personal data about me to bring about delivery of the same as well as on the external cover of envelopes/mail packages); and/or
 - (v) complying with applicable law in administering, processing, handling and/or dealing with my claims.
- (collectively the "Purposes")
- (b) all insurer(s) who have insured vehicle(s) involved in this accident and the Insurers' lawyers/law firms, may/are permitted to collect, use, disclose and/or process my Personal Information for one or more of the above Purposes; and
- (c) my Personal Information may/can be disclosed by any of the Insurers and/or GIA to their third-party service providers or agents (including their lawyers/law firms), which may be sited outside of Singapore, for one or more of the above Purposes.



[Handwritten signature]

Policyholder's Signature / Date & Time

Driver's Signature (if driver is not the policyholder) / Date & Time

Witnessed by Reporting Centre Personnel
(Name as in NRIC/ID card)

Sketch Plan

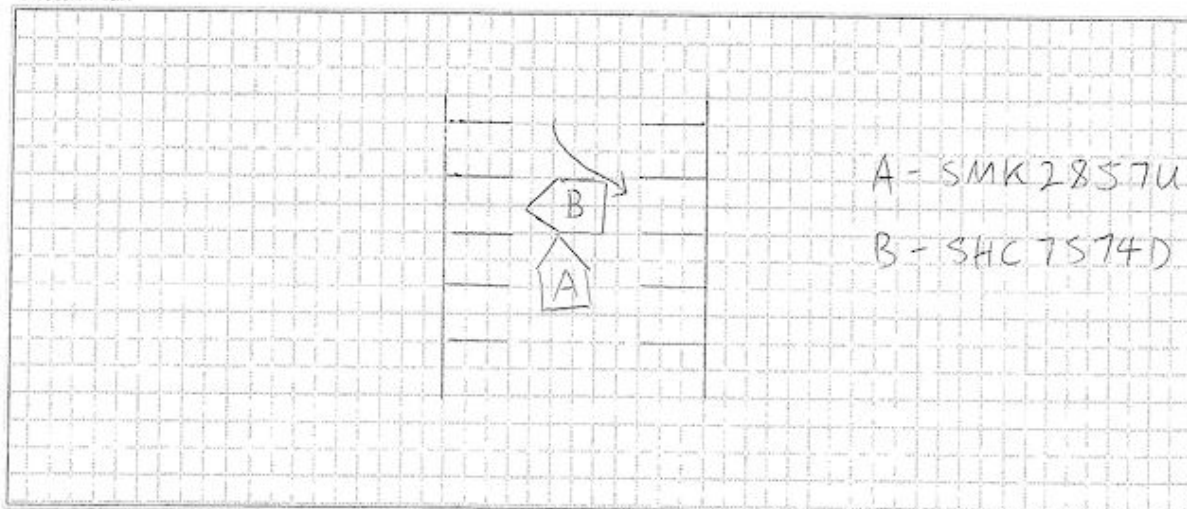

Describe Circumstance of the Accident

On the 31/10/2024 at about 3.35 pm, I was driving my car (Vehicle A - SMK2857U) in the Public car park near B/128 Yishun St11, on the way to pick up my passenger. In front of my car was a taxi (Vehicle B - SHC7574D), that suddenly stopped and then reverse into the parking lot on the right, without signal. I stopped my car as well but the taxi continued to reverse and the left side of the taxi then hit onto the front of my car.

Declaration

I/We declare the foregoing particulars are true in every respect.



Policyholder's Signature / Date & Time

Driver's Signature (if driver is not the policyholder) / Date & Time

Witnessed by Reporting Centre Personnel
(Name as in NRIC/ID card)